

**CITY OF LINCOLN**  
**REGULAR COMMITTEE OF THE WHOLE MEETING**  
**AGENDA**  
**APRIL 24, 2018**  
**CITY HALL COUNCIL CHAMBERS**  
**7:00 PM**

1. **Call to Order**
2. **Pledge of Allegiance**
3. **Public Participation**
4. **Request To Permit: VFW-Lincoln Illinois Saturday, May 12, 2018 from 10:00AM Until 1:00PM sell poppies at intersection of Broadway & McLean**
5. **Request to Permit: Lincoln Area Music Society would like to place a banner in the vacant lot at the corner of Pekin and Kickapoo streets to advertise summer band concerts. The banner will be in place on June 5, 2018 be removed by July 2, 2018**
6. **Request to Permit: Lincoln Community High School Homecoming Parade Friday, September 15, 2018 at 2:30 PM. The parade will proceed down Wyatt Ave., turn Right onto Kickapoo Street, right onto Broadway St. and continue around the Courthouse square.**
7. **Abraham Lincoln Healthcare Foundation DBA Abraham Lincoln Memorial Hospital Foundation- Letter of agreement regarding "Fitness Court"**
8. **Purchase of Additional Folding Machine**
9. **Police Station Furniture Bid - With remodel of the old Jefferson School into the new Police Station, the configuration of the current older furniture will not be conducive For us in the new Police Station**
10. **2018 Motor Fuel Tax Program Resolution – The use of MFT funds are limited to The engineering, labor, maintenance, material and construction of roadways, Sidewalks, and curbing**
11. **New End Loader and Backhoe Lease for Street & Alley Department**
12. **Agreement between City of Lincoln and Logan County Animal Control for 12 month services June 2018 – May 2019 in the amount of \$42,000.00**
13. **American Water – Water Usage Data Agreement, purpose for downloading water reads for sewer rates**
14. **Announcements**
15. **Possible Executive Session**
16. **Adjournment**
17. **Upcoming Meetings**  
**City Council Meeting: Monday, May 7, 2018**  
**Committee of the Whole Tuesday, May 15, 2018**

# REQUEST TO PERMIT

DATE: 04/16/2018

We, the undersigned of the City of Lincoln, do hereby respectfully request the Mayor and City Council to permit

VFW - Lincoln, Illinois

Sell Poppies @ intersection of  
Broadway + McLean Saturday,  
May 12, 2018 - From 10:00 A.M. -  
1:00 P.M.

If the above request is for use of City property, including streets and/ or alleys, please check one of the two boxes below:

A Certificate of Insurance Liability for the event is attached.

A Certificate of Insurance Liability for the event will be provided to the City no later than \_\_\_\_\_.

If City property is used, a Certificate of Insurance Liability is required listing the City as an additional insured. The City reserves the right to postpone review and consideration of this Request to Permit until a Certificate of Insurance Liability is provided.

Name: Victor Long

Address: Lincoln Illinois

Phone: \_\_\_\_\_ Cell: 217-737-7847

Email: \_\_\_\_\_

**Lincoln Area Music Society**  
Box 53  
Lincoln, IL 62656

---

**LAMS BOARD**

April 16, 2018

Jason Boice  
Roger Boss  
Linda Bottom  
Carol Brainard  
Julie Kasa  
Laurie Lewis  
Hannah Michalsen  
Carrie Osborn  
Donnie Parker  
Tim Searby  
Sarah Strotheide  
Lou Tesh  
Becky Werth  
Jeff Arbisi  
Judy Kukuck

Lincoln City Council:

The Lincoln Area Music Society (LAMS) board is once again asking to place a banner in the vacant lot at the corner of Pekin and Kickapoo streets to advertise the summer band concert series. The banner will be put in place on June 5, 2018 and removed no later than July 2, 2018. The concerts are scheduled for June 10, 17, 24 and July 1. Please contact Donnie Parker at (217) 737-3609 if you have any questions. Thank you for your consideration.

Sincerely,

Lincoln Area Music Society Board

# REQUEST TO PERMIT

Fax 732-2145

# 735-2815

DATE: 4/16/2018

We, the undersigned of the City of Lincoln, do hereby respectfully request the Mayor and City Council to permit

LCHS to have a Homecoming Parade Friday  
September 15<sup>th</sup>, 2018 at 2:30 P.M.. The parade  
will proceed down Wyatt Ave., turn right onto  
Kickapoo Street, right onto Broadway St. and  
continue around the courthouse square.

If the above request is for use of City property, including streets and/ or alleys, please check one of the two boxes below:

A Certificate of Insurance Liability for the event is attached.

A Certificate of Insurance Liability for the event will be provided to the City no later than September 8, 2018. - Last year's will cover this date.

If City property is used, a Certificate of Insurance Liability is required listing the City as an additional insured. The City reserves the right to postpone review and consideration of this Request to Permit until a Certificate of Insurance Liability is provided.

Name: Chris Hammer

Address: 1000 Railer Way  
Lincoln

Phone: 732-4131 Cell: 433-2038

Email: chammer@lchsrailers.org



**For Consideration by the City of Lincoln:**

The Abraham Lincoln Memorial Hospital would like to offer the purchase of a Fitness Court, as designed and supported by the National Fitness Campaign, for installation at the current vacant lot on 8<sup>th</sup> Street (the previous location of Abraham Lincoln Memorial Hospital).

The Fitness Court provides an opportunity for free fitness, much like a public basketball court or tennis court. It consists of a bodyweight circuit-training system designed for adults of all ages and fitness levels. Up to 28 individuals can use the court at the same time.

The system is low maintenance and fits into a small footprint (35' x 32') allowing for additional uses of the property. An annual power washing is suggested to maintain the Court.

The close access to residential, school and churches will help encourage use and visibility as we continue to create a culture of health in Logan County. The property is also sitting on 8<sup>th</sup> Street

**Provided by ALMH Community Health Collaborative:**

- Purchase of the Fitness Court
- Oversight and funding of the installation
- Oversight and funding of landscaping around the Fitness Court
- Design and development of custom signage/graphics on the front and rear walls of the Fitness Court
- Coordination with National Fitness Campaign for promotion of Fitness Court
- Assistance, if requested by the City, with the 2018 Fit Radio Grant Funding Application which will result in a \$10,000 credit on purchase of the Fitness Court – grant application attached.

**Follow-up to questions at the Committee of the Whole Meeting on February 27, 2018:**

- The Fitness Court equipment has a variety of warranties from 1 to 25 years depending upon the specific piece of equipment. At this time I have obtained the replacement cost of one set of cables (\$500). The warranty listing is attached.
- A street light is currently located on 8<sup>th</sup> Street near the proposed site but it would not light the Fitness Court sufficiently for use after dusk.
- I've spoken to Pastor Laurie Hill at St. John's United Church of Christ. Their church council will be discussing the use of their parking lot.

Please contact Angela Stoltzenburg, Director of the ALMH Community Health Collaborative, if you have any questions at 217-605-5008 or [stoltzenburg.angela@mhsil.com](mailto:stoltzenburg.angela@mhsil.com)

**Proposal National Fitness  
Court at former ALMH  
Location on 8<sup>th</sup> Street**

Lincoln, Illinois



**To improve the health of the  
people and communities  
we serve.**





**We have an Extraordinary  
Partnership Opportunity**



**Give the gift of fitness  
and reflect your values  
in one of the city's most  
visible public spaces**



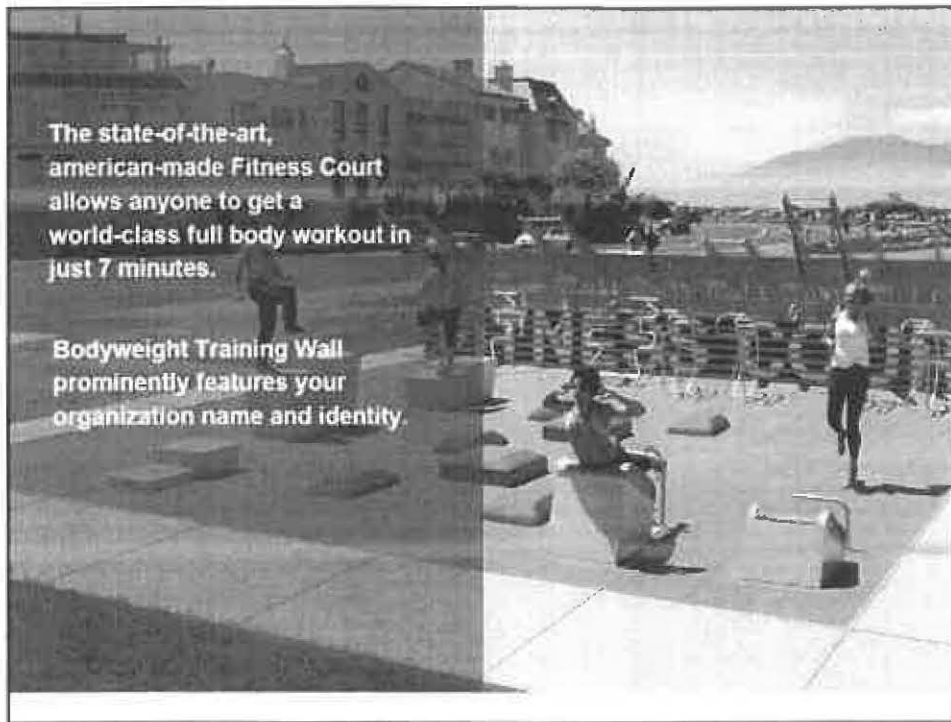

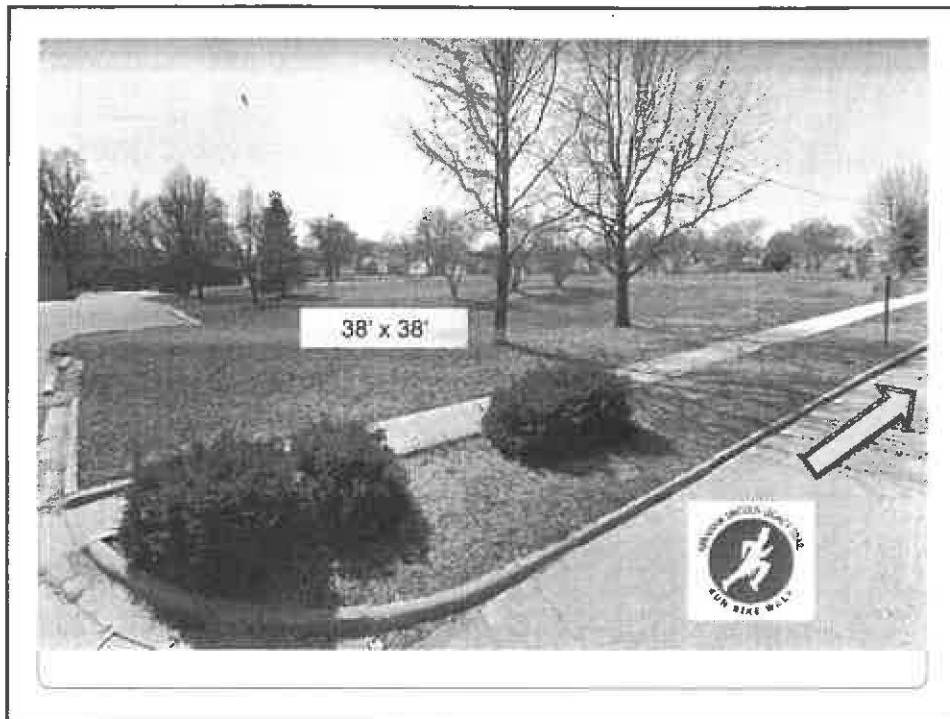

**Abraham Lincoln Memorial Hospital Community Health Collaborative**

- Provide \$140,000 to purchase the fitness court, installation, and landscape around fitness court walkway to court.

**City of Lincoln**

- Maintenance of fitness court (estimated by NFC at \$1,000-\$2,000 annually for power washing)
- Allow permanent identification of ALMH Community Health Collaborative as the sponsor on the Fitness Court
- Accept \$10,000 Fit Radio grant from NFC

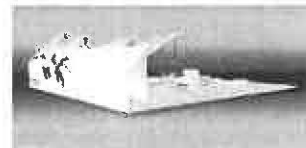

*In partnership with ALMH...*

- Host an opening day celebration
- Promote the Fitness Court using the mobile app, website and tools provided by NFC to build awareness and a public fitness community that demonstrates the value of an active lifestyle

# Rear Wall Design



PARTNER AND SPONSOR PANEL

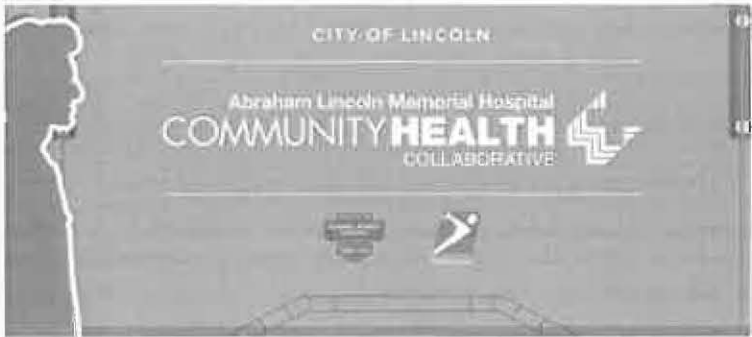

REAR WALL



FRONT AND SIDE WALLS

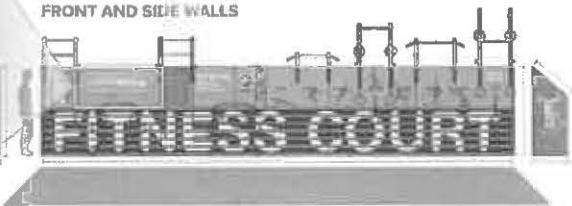



## LETTER OF AGREEMENT

This Letter of Agreement (“**Agreement**”) is made and entered into, by and between (i) ABRAHAM LINCOLN HEALTHCARE FOUNDATION D/B/A ABRAHAM LINCOLN MEMORIAL HOSPITAL FOUNDATION, by and through its Community Health Collaborative, and (ii) CITY OF LINCOLN, ILLINOIS (the “**City**”). ALMHF and the City are collectively referred to in this Agreement as the “**Parties**,” and either ALMHF or the City may be separately identified, in this Agreement, as a “**Party**.”

WITNESSETH:

In consideration of the terms, covenants, and conditions which are contained and expressed in this Lease, ALMHF and the City agree as follows:

### ARTICLE 1. RESPONSIBILITIES

#### 1.1 The City shall:

1.1.1 Submit a grant application, including a letter from an authorized official of ALMHF confirming funding to purchase has been obtained, on behalf of the City to the National Fitness Campaign within fourteen (14) days of this Agreement.

1.1.2 Maintain the “Fitness Court” once installed.

#### 1.2 ALMHF shall:

1.2.1 Prepare the National Fitness Campaign grant.

1.2.2 Purchase the “Fitness Court”.

1.2.3 Oversee and fund the complete installation of the “Fitness Court”.

1.2.4 Fund landscaping around the “Fitness Court”.

1.2.5 Coordinate promotion of the “Fitness Court”, including the opening day event and ongoing promotion per the grant application.

1.3 Neither Party will receive any compensation or other remuneration from the other Party as a consequence of this Agreement.

1.4 This Agreement does not represent an exclusive relationship, and either Party may develop similar arrangements with other persons and entities without being deemed to be in breach or violation of this Agreement.

## **ARTICLE 2. TERM AND TERMINATION OF AGREEMENT**

**2.1 Term.** The Term of this Agreement will commence on the date of the last signature at the end of this Agreement (the “**Term Commencement Date**”) for a term of one (1) year therefrom (the “**Term Expiration Date**”), unless, as prescribed in this Article 2, this Agreement is terminated prior to that Term Expiration Date.

**2.2 Termination.** This Agreement may be terminated prior to the Term Expiration Date which is identified in Article 2.1, in the following manner:

**2.2.1 Early Termination.** If the Parties consent and mutually agree, in writing, this Agreement may be terminated on the terms and effective as of the date stipulated by the Parties. In addition, either Party may terminate this Agreement, without being required to specify a cause or reason, and without the terminating Party incurring any liability to the other Party as a consequence of that termination, by the delivery of at least a thirty (30) day notice to the other Party.

**2.2.2 Breach of Duties.** If either Party fails to timely or adequately perform the duties and responsibilities assumed by that Party under this Agreement, this Agreement may be terminated, at the option of the terminating Party, by the delivery of at least a ten (10) day notice to the other Party.

**2.2.3 Default.** In the event either Party notifies the other Party that such other Party has defaulted in the performance of any other obligation under this Agreement, and that default has not been cured within the ten (10) day period which follows the delivery of the notice, the Party delivering the notice, if that Party so elects, may immediately terminate this Agreement by specifying the effective date of the termination.

**2.3 Effects of Termination.** If this Agreement is terminated, in compliance with the applicable provisions of this Article 2, neither Party will be further obligated to perform under this Agreement.

**2.4 Term Renewals.** Effective as of the initial Term Expiration Date which is specified in Article 2.1, and subsequently on each anniversary of that initial Term Expiration Date, the Term of this Agreement will be deemed to have been automatically extended by the Parties in successive one (1) year periods, unless either Party notifies the other Party, at least thirty (30) days prior to the expiration of the then current one (1) year Term, that such Party is not electing to extend the Term an additional one (1) year period. Any extension of this Agreement pursuant to this Article 2.4 will likewise be characterized and identified as the “Term” under this Agreement. The term of this agreement may not exceed, under any circumstances, a total of five (5) years.

## **ARTICLE 3. GENERAL PROVISIONS**



A notice or consent will be deemed to be received in subparagraph (i), on the date of the actual receipt of the notice or consent by the Party entitled to the notice or consent, and in subparagraph (ii), on the date of the mailing of the notice or consent.

**3.9 Waiver of Breach.** The waiver by a Party of a breach by the other Party of any provision of this Agreement will not operate or be construed as a waiver by that Party of any subsequent breach of this Agreement by the other Party.

In witness whereof, the Parties executed and then delivered this Agreement, on the Term Commencement Date, in pursuance of the uses and purposes which are respectively described and contained in this Agreement.

ALMHF:

City:

ABRAHAM LINCOLN HEALTHCARE  
FOUNDATION D/B/A ABRAHAM  
LINCOLN MEMORIAL HOSPITAL  
FOUNDATION

CITY OF LINCOLN

By: \_\_\_\_\_  
Name: Dolan Dalpoas  
Title: President and CEO  
Date: \_\_\_\_\_

By: \_\_\_\_\_  
Name: Seth Goodman  
Title: Mayor  
Date: \_\_\_\_\_



# **NATIONAL FITNESS CAMPAIGN**

## **2018 Campaign**

### **2018 Fit Radio Grant Funding Application**

**PRE- APPROVED**

**PLEASE RETURN WITHIN 14 DAYS OF RECEIPT**

# NFC 2018 Campaign Grant Application

Section I. GENERAL INFORMATION			
<b>1. TYPE OF APPLICANT:</b> Parks & Recreation Department School (specify) _____ City/County Government Public Land Management Agencies Foundation Other (specify) _____	<b>2. DATE OF SUBMISSION:</b>  <b>3. LEGAL NAME OF ORGANIZATION:</b>		
<b>4. APPLICANT INFORMATION</b>			
Name of City/School/Organization:		Information for the person to be contacted on matters involving this application:	
Street:	Prefix:	First Name:	
City:		Last Name:	
State:	Zip:	Title:	
Web Site Address: _____		Office Phone:	Cell Phone:
Email Address:			

Section II. SITE INFORMATION			
Location Name:		Is this site currently used for:	
Type of Location:		City run community events City run health & fitness programs Sponsored health & fitness programs Independent bootcamps Private programs & events Sponsored community events Other (specify) _____	
Public Outdoor Park Public Trail Public School Property Other (specify below) _____		Hours of Operation: Mon – Fri 00:00 am thru 00:00 pm Weekends 00:00 am thru 00:00 pm	
Is public access available to the site?	Yes No	Is the site connected to a walking/jogging/biking trail? Yes No	
Has the site been approved?	Yes No	If no, can you commit to site approval in 2018 for your NFC Fitness Court? Yes No	
Please describe below what makes this the best site for your community's first Fitness Court.			
<b>Please include Google maps images and/or satellite images (A), site pictures (B) and/or other graphic aids (C) to help demonstrate the location and characteristics of the site. Exhibits should be placed in an appendix and referenced rather than placed in the body of the application.</b>			

# NFC 2018 Campaign Grant Application

Section III. TIMING, FUNDING	
<b>TIMING</b>	
<p>1. Can you confirm that your NFC Fitness Court will be open and available for public use in 2018?</p> <p>2. When would your city like to launch your NFC Fitness Court and local campaign?</p> <p style="margin-left: 20px;">a. Q1 2018</p> <p style="margin-left: 20px;">b. Q2 2018</p> <p style="margin-left: 20px;">c. Q3 2018</p> <p style="margin-left: 20px;">d. Q4 2018</p>	<p style="text-align: center;">Yes   No</p>
<b>FUNDING</b>	
<p>3. Which of the following NFC funding options will you pursue? (choose one)</p> <p style="margin-left: 20px;">a. Option A: 10k Fit Radio Grant</p> <p style="margin-left: 20px;">b. Option B: 10k Fit Radio Grant + \$20,000 Local Sponsor Funding</p>	
<p>4. How and when does your city intend to fund the 80k plus installation required to be able to join the Campaign in 2018?</p>	
<p>5. If local fundraising is unsuccessful does the city/school still intend to proceed in 2018? <span style="float: right;">Yes   No</span></p>	
Section IV. SPONSORSHIP & PARTNERSHIP	
<p>1. Are you willing to host an opening day celebration at the Fitness Court inviting civic leaders, community supporters and the local media? <span style="float: right;">Yes   No</span></p>	
<p>2. In consideration of the Fitness Court being funded through the NFC sponsorship program, please answer the following question:</p> <p style="margin-left: 20px;">a. Will you allow the permanent identification of major sponsors on the Fitness Court sign theater? (See attached exhibits for sign theater schematic options) <span style="float: right;">Yes   No</span></p>	
<p>3. NFC raises the priority of health and fitness in the community through building strong partnerships and the engagement of local/national sponsors. Do you agree to help build fitness in your community in the following ways?</p> <p style="margin-left: 20px;">a. Promote usage of the Fitness Court using the mobile app, website and tools provided to build awareness and a public fitness community that demonstrates the value of an active lifestyle <span style="float: right;">Yes   No</span></p> <p style="margin-left: 20px;">b. Promote sponsors who have supported the Campaign &amp; join relevant regional + national events and promotions <span style="float: right;">Yes   No</span></p>	



# NFC 2018 Campaign Grant Application

## Section V. NFC GRANT AWARD ACCEPTANCE

1. How will your organization accept the \$10,000 Fit Radio grant and confirm that your funding in this application will be available and committed to this program?
  - a. Purchase order
  - b. Letter from City Manager or authorized official
  - c. Non-Refundable \$2,500 deposit made out to National Fitness Campaign
  - d. Other \_\_\_\_\_

The undersigned (authorized official signing for the applicant organization) certifies, to the best of his or her knowledge and belief that the information contained in this application is true.

Further, the undersigned organization recognizes that in accepting this grant award, there is no binding obligation to proceed with the project at this time.

Signature of Applicant	Title	
Applicant Organization		Date Submitted

Please send your completed application electronically to the following email address: [partnerships@nfchq.com](mailto:partnerships@nfchq.com)

Alternatively, you may send a hard copy of your completed application to the following address:

**The VAULT**  
**Attn: National Fitness Campaign - Partners In Fitness**  
**415 Jackson St, San Francisco, CA 94111**

# Custom Signage and Graphics

Personalize your Fitness Court and celebrate your city, sponsors and donors with custom signage and graphics on the front and rear walls. National Fitness Campaign supports full color graphics on the prominent front wall recognition area and white artwork up to 16' wide and 2' 9" tall on the rear wall. All graphics are custom-printed on high quality vinyl sheets.

## REAR WALL



## FRONT AND SIDE WALLS



## FRONT WALL RECOGNITION AREA



## Warranty



### Fitness Court Warranty

National Fitness Campaign LLC ("Company"), warrants the Fitness Court ("Equipment") to be free from significant defects in material and manufacturing and to conform to published specifications for the periods described below

**25 Year Limited Warranty**

Wall Structural Frames

**5 Year Limited Warranty**

Outer Wall Panels

Brackets

Pull Up Bars

Foot Strips

Push Ladders

Row Stands

**3 Year Limited Warranty**

Squat Boxes

Lunge Steps

Bend Boxes

**1 Year Limited Warranty**

Wall Graphics

Cables and Rings

Bend Cushion

Plyo Box Top Surface

Rowing Handles and Chain

All Other Components provided by NFC

## MEMORANDUM

**TO:** Mayor Seth Goodman and Members of the City Council  
**FROM:** Peggy Bateman, City Clerk  
**DATE:** April 24, 2018  
**RE:** Purchase of Additional Folding Machine

---

**Background:** Shortly over a year ago the City purchased a new Pitney Bowes Folding machine for the Sewer bills. This machine stuffs and folds all sewer bills for mailing.

**Discussion:** With going from quarterly billing to monthly billing which will also include trash there is a need for an additional folding machine. Running approximately 5000 pieces of mail monthly through one folding machine would take number of days plus the wear and tear on the current machine. The Clerk's office would like to purchase an additional folding machine.

I received three bids. Two of the machines that were offered were identical to the current machine we have. The other bid was for a different brand but has the features that we need.

Formax- Tom Day Business Machines	\$3,995.00 Purchase <u>\$ 295.00</u> Annual Maintenance \$ 4, 290.00
Pitney Bowes -Walz Mailing & Label	\$4,680.00 Purchase <u>\$ 550.00</u> Annual Maintenance \$5,230.00
Pitney Bowes- Konica Minolta	\$5,812.00 Purchase <u>\$ 750.00</u> Annual Maintenance \$ 6,562.00

The purchase of the new folding machine would be taken from the equipment line of the Trash Collection-Billing Sub-fund.

With lowest bid being the Formax Brand by \$940.00 the Pitney Bowes brand being identical to the machine we currently have. We ask if we could purchase the Pitney Bowes for there would be no training on operation of new machine. Having two different machines would cause an unnecessary efficiency problem and would hamper the monthly production of our statements.

**COW Recommendation**

Place on Council Agenda for May 7, 2018, to approve bid not to exceed \$5,230.00

## LINCOLN POLICE DEPARTMENT

---

CHIEF OF POLICE PAUL ADAMS



DEPUTY CHIEF MATTHEW VLAHOVICH

**To: City Council**  
**From: Chief of Police, Paul Adams**  
**Meeting Date: April 24, 2018**

**Re: Police Station Furniture Bid**

### **Background**

With the remodel of the old Jefferson School into the new Police Station, the configuration of the current older furniture will not be conducive for use in the new police station.

### **Analysis/Discussion**

We have worked with **Resource One** out of Springfield, IL, on a furniture design. The representative has been great to work with and very accommodating to our needs. They created a design for the police station using manufacturers that are providing a lifetime warranty on all products. All pricing was bid using State of Illinois bid pricing which totaled **\$101,142.23**.

We also worked with **Illini Supply** out of Forsyth, IL, for a comparison to the materials and design of the spaces. The representatives and owner also worked well with us and rushed to provide us another quote for the furniture so we can compare the pricing and layouts. All pricing was bid using State of Illinois bid pricing which totaled **\$100,314.15**.

Both the designs were very similar, but using different manufacturers. Both have similar warranties on the fabrics and materials.

In regards to the products used, the quality of the materials shown, and prior experience with Resource One for the Municipal Building we believe the quote was in line with our needs and expectations. There is also another deduction with Resource One to be made as we are working around the new outlets.

### **Fiscal Impact**

We have budgeted in our soft costs \$96,000 for the furniture and podium. The initial quote from Resource One for pricing was done off of Federal Bid Pricing, which we are not eligible for. We are still well under our contingency allowance with PJ Hoerr so there should be no issue with the amount of \$101,142.23 which will be covered in the bond amount.

# LINCOLN POLICE DEPARTMENT

---

CHIEF OF POLICE PAUL ADAMS



DEPUTY CHIEF MATTHEW VLAHOVICH

## **COW Recommendation**

Place on Council Agenda for May 7, 2018, to approve the bid from Resource One in an amount not to exceed \$101,142.23.

## **Attachments**

Design and Bid from Resource One

Design and Bid from Illini Supply



## Furniture Pricing

### Overall Pricing

<b>Location</b>	<b>Illini Supply</b>	<b>Resource One</b>
Room 101 Interview	1,042.95	1,319.65
Room 102 Records	5,136.30	6,994.68
Room 104 Investigations	14,388.70	16,977.72
Room 106 Inv. Sgt.	4,364.90	3,706.45
Room 107 Patrol	7,232.70	4,101.10
Room 109 Sgt. Office	6,341.60	2,904.95
Room 121 Shared Conference	4,552.20	4,407.00
Room 122 Interview	1,042.95	678.60
Room 123 Family	1,851.80	1,319.65
Room 124 Interview	1,042.95	678.60
Room 129 Training	25,379.95	29,597.35
Room 130 Break Room	1,636.40	1,719.12
Room 144 Administration	6,874.20	7,126.18
Room 145 Deputy Chief	4,723.00	9,748.40
Room 149 Chief	6,699.55	6,326.78
Corridor C107 Files	2,089.20	
<b>Subtotal</b>	<b>94,399.35</b>	<b>97,606.23</b>
<b>Installation</b>	<b>9,840.00</b>	<b>3,536.00</b>
<b>Deduct 6 Existing Chairs</b>	<b>\$1,836.00</b>	
<b>Total</b>	<b>\$102,403.35</b>	<b>\$101,142.23</b>

# Lincoln Police Department-Global

Lauren Nevius  
 Inevius@resourceoneoffice.com  
 Mobile: 217-691-8421

Item	✓	Tag	Q	Mfg	Cat	Part Number	Part Description	Qty	Sell	Ext Sell
1	✓	Administration 144		GLB	GUS	2222-6 ~04 ~BEE1 BN80 AL ~ ~	WEEV, Mesh Back, Medium Back, Task, Armless, Std Molded Black Base, Std 2" Dual Wheel Carpet Casters, GLOBAL SEATING USA Grade 04 Beeline (Momentum) 1-Geysler F-Aluminum Frame [ALU] C-(STD) Black, 2" Dual-Wheel Caster [C1] (STD)	10	\$ 337.48	\$ 3,374.80
2	✓	Administration 144		GLB	GCU	GCT10WBA ~ ~BTOP ASN ~BBASE ASN ~ ~ ~ ~	Boat Shape - Arch Base-Self Edge - 48D x 120W x 29H, Boardroom Tables (STD) Thermally Fused Laminata, High Performance (1" Thick) Boardroom Table Top Finishes 1-Asian Night Boardroom Table Base Finishes 2-Asian Night (STD) Table 1 Piece Grommet/Electrical Not Required - Left Position Grommet/Electrical Not Required - Center Position Grommet/Electrical Not Required - Right Position	1	\$ 767.00	\$ 767.00
sub		Administration 144					Administration 144 Subtotal			\$ 4,141.80
3	✓	Break Room 130		GLB	GUS	6711 ~DPLS PLT CH CG ~	POPCORN, Wall Saver, Polypropylene Back & Seat, Armless, Std Sled Chrome Frame, Std Without Glides, Stacks 10 High on Floor, 34 high on Dolly, GLOBAL SEATING USA Polypropylene Back / Seat Selections 1-Platinum [PLT] F-Chrome Frame [CH] M-Clear Glide (STD) RTA Code in Pricebook per Model	8	\$ 86.32	\$ 690.56
4	✓	Break Room 130		GLB	GCU	B3672REF ~ ~BNGE BRC SI ~ ~ ~ ~ ~	36"d x 72"w x 29.5"h, Rectangular Table w/ Fixed Top, 4 Tapered Legs w/ Levelers and Bungee Cords, Each Table can be "Bungee-Tied" to other Tables of the Same Depth, BUNGEE TABLES (STD) Thermally Fused Laminata, High Performance (1" Thick) Bungee Laminata Finishes 1-Brushed Cobalt F-Silver Casters Not Required Grommet/Electric/Villa Not Required - Left Position Grommet/Electric/Villa Not Required - Center Position Grommet/Electric/Villa Not Required - Right Position Grommet/Electric/Villa Not Required - Custom Grommet Location	2	\$ 514.28	\$ 1,028.56
sub		Break Room 130					Break Room 130 Subtotal			\$ 1,719.12

**\*\*Quoted price is the discounted cash price. Payment by credit card will incur a 3% processing fee.**  
**\*\*50% Deposit required to place order with the factory.**  
**\*\*Sales tax to be applied to final order, if applicable.**  
**\*\*PRICING REFLECTED ON THIS QUOTE IS VALID FOR 90 DAYS (UNLESS OTHERWISE NOTED).**

Created by: Kylie Plate  
 kplate@resourceoneoffice.com  
 04/19/18 13:30:02

Approved by: \_\_\_\_\_ Date: \_\_\_\_\_  
 P:\customer files\LAUREN\City of Lincoln\Lincoln Police Dept\Quotes\City of Lincoln-Lincoln Police Department - Global 041818.sp4

Lincoln Police Department-Global

Lauren Nevius  
 Inevius@resourceoneoffice.com  
 Mobile: 217-691-8421

Item	✓	Tag	Mfg	Cat	Part Number	Part Description	Qty	Sell	Ext Sell
6	✓	Chief 149	GLB	GUS	6901	SIDERO, Side Chair, Wall Saver, Armless, Std 4 Legged Base, Black Polypropylene Foot, Stack 5 high on Floor, Stacks 8 High on Dolly, GLOBAL SEATING USA	2	\$ 236.60	\$ 473.20
					~04	Grade 04			
					~MRTH	Marathon (Momentum)			
					MR72	1-Oats			
					TU	F-Tungsten Frame [TUN]			
					~	(STD) Black Glide			
					~	(STD) Standard Chair Back Design			
					~	(STD) Fire Barrier Lining Not Required			
					~	(STD) RTA Code in Pricebook per Model			
sub		Chief 149				Chief 149 Subtotal			\$ 473.20
6	✓	Deputy Chief 145	GLB	GUS	6901	SIDERO, Side Chair, Wall Saver, Armless, Std 4 Legged Base, Black Polypropylene Foot, Stack 5 high on Floor, Stacks 8 High on Dolly, GLOBAL SEATING USA	4	\$ 236.60	\$ 946.40
					~04	Grade 04			
					~MRTH	Marathon (Momentum)			
					MR72	1-Oats			
					TU	F-Tungsten Frame [TUN]			
					~	(STD) Black Glide			
					~	(STD) Standard Chair Back Design			
					~	(STD) Fire Barrier Lining Not Required			
					~	(STD) RTA Code in Pricebook per Model			
sub		Deputy Chief 145				Deputy Chief 145 Subtotal			\$ 946.40
7	✓	Family 123 and Report Taking 101	GLB	GUS	6901	SIDERO, Side Chair, Wall Saver, Armless, Std 4 Legged Base, Black Polypropylene Foot, Stack 5 high on Floor, Stacks 8 High on Dolly, GLOBAL SEATING USA	6	\$ 236.60	\$ 1,419.60
					~04	Grade 04			
					~BEE1	Beeline (Momentum)			
					BN80	1-Geysler			
					TU	F-Tungsten Frame [TUN]			
					~	(STD) Black Glide			
					~	(STD) Standard Chair Back Design			
					~	(STD) Fire Barrier Lining Not Required			
					~	(STD) RTA Code in Pricebook per Model			
sub		Family 123				Family 123 Subtotal			\$ 1,419.60
8	✓	Interview 122	GLB	GUS	6711	POPCORN, Wall Saver, Polypropylene Back & Seat, Armless, Std Sled Chrome Frame, Std Without Glides, Stacks 10 High on Floor, 34 high on Dolly, GLOBAL SEATING USA	3	\$ 86.32	\$ 258.96
					~DPLS	Polypropylene Back / Seat Selections			
					PLT	1-Platinum [PLT]			
					CH	F-Chrome Frame [CH]			
					CG	M-Clear Glide			
					~	(STD) RTA Code in Pricebook per Model			

**\*\*Quoted price is the discounted cash price. Payment by credit card will incur a 3% processing fee.**  
**\*\*50% Deposit required to place order with the factory.**  
**\*\*Sales tax to be applied to final order, if applicable.**  
**\*\*PRICING REFLECTED ON THIS QUOTE IS VALID FOR 90 DAYS (UNLESS OTHERWISE NOTED).**

Created by: Kylie Plate  
 kplate@resourceoneoffice.com  
 04/19/18 13:30:02

Approved by: \_\_\_\_\_

Date: \_\_\_\_\_

Lincoln Police Department-Global

Lauren Nevius  
 Inevius@resourceoneoffice.com  
 Mobile: 217-691-8421

Item	✓	Tag	Q	Mfg	Cat	Part Number	Part Description	Qty	Sell	Ext Sell
9	✓	Interview 122		GLB	GCU	B2460REF	24"d x 60"w x 29.5"h, Rectangular Table w/ Fixed Top, 4 Tapered Legs w/ Levelers and Bungee Cords, Each Table can be "Bungee-Tied" to other Tables of the Same Depth, BUNGEE TABLES (STD) Thermally Fused Laminate, High Performance (1" Thick) ~ ~BNGE Bungee Laminate Finishes BRC 1-Brushed Cobalt SI F-Silver ~ Casters Not Required ~ Grommet/Electric/Villa Not Required - Left Position ~ Grommet/Electric/Villa Not Required - Center Position ~ Grommet/Electric/Villa Not Required - Right Position ~ Grommet/Electric/Villa Not Required - Custom Grommet Location	1	\$ 419.64	\$ 419.64
sub		Interview 122					Interview 122 Subtotal			\$ 678.60
10	✓	Interview 124		GLB	GUS	6711	POPCORN, Wall Saver, Polypropylene Back & Seat, Armless, Std Sled Chrome Frame, Std Without Glides, Stacks 10 High on Floor, 34 high on Dolly, GLOBAL SEATING USA ~DPLS Polypropylene Back / Seat Selections PLT 1-Platinum [PLT] CH F-Chrome Frame [CH] CG M-Clear Glide ~ (STD) RTA Code in Pricebook per Model	3	\$ 86.32	\$ 258.96
11	✓	Interview 124		GLB	GCU	B2460REF	24"d x 60"w x 29.5"h, Rectangular Table w/ Fixed Top, 4 Tapered Legs w/ Levelers and Bungee Cords, Each Table can be "Bungee-Tied" to other Tables of the Same Depth, BUNGEE TABLES (STD) Thermally Fused Laminate, High Performance (1" Thick) ~ ~BNGE Bungee Laminate Finishes BRC 1-Brushed Cobalt SI F-Silver ~ Casters Not Required ~ Grommet/Electric/Villa Not Required - Left Position ~ Grommet/Electric/Villa Not Required - Center Position ~ Grommet/Electric/Villa Not Required - Right Position ~ Grommet/Electric/Villa Not Required - Custom Grommet Location	1	\$ 419.64	\$ 419.64
sub		Interview 124					Interview 124 Subtotal			\$ 678.60
12	✓	Inv. Sgt. 106		GLB	GUS	6901	SIDERO, Side Chair, Wall Saver, Armless, Std 4 Legged Base, Black Polypropylene Foot, Stack 5 high on Floor, Stacks 8 High on Dolly, GLOBAL SEATING USA ~04 Grade 04 ~MRTH Marathon (Momentum) MR72 1-Oats TU F-Tungsten Frame [TUN] ~ (STD) Black Glide ~ (STD) Standard Chair Back Design ~ (STD) Fire Barrier Lining Not Required ~ (STD) RTA Code in Pricebook per Model	2	\$ 236.60	\$ 473.20
sub		Inv. Sgt. 106					Inv. Sgt. 106 Subtotal			\$ 473.20

**\*\*Quoted price is the discounted cash price. Payment by credit card will incur a 3% processing fee.**  
**\*\*50% Deposit required to place order with the factory.**  
**\*\*Sales tax to be applied to final order, if applicable.**  
**\*\*PRICING REFLECTED ON THIS QUOTE IS VALID FOR 90 DAYS (UNLESS OTHERWISE NOTED).**

Created by: Kylie Plate  
 kplate@resourceoneoffice.com  
 04/19/18 13:30:02

Date: \_\_\_\_\_

Approved by: \_\_\_\_\_  
 P:\customer files\LAUREN\City of Lincoln\Lincoln Police Dept\Quotes\City of Lincoln-Lincoln Police Department - Global 041818.sp4

# Lincoln Police Department-Global

Lauren Nevius  
 Inevius@resourceoneoffice.com  
 Mobile: 217-691-8421

Item	✓	Tag	Mfg	Cat	Part Number	Part Description	Qty	Sell	Ext Sell
13	✓	Investigations 104	GLB	GUS	6901	SIDERO, Side Chair, Wall Saver, Armless, Std 4 Legged Base, Black Polypropylene Foot, Stack 5 high on Floor, Stacks 8 High on Dolly, GLOBAL SEATING USA	4	\$ 236.60	\$ 946.40
					~04	Grade 04			
					~MRTH	Marathon (Momentum)			
					MR72	1-Oats			
					TU	F-Tungsten Frame [TUN]			
					~	(STD) Black Glide			
					~	(STD) Standard Chair Back Design			
					~	(STD) Fire Barrier Lining Not Required			
					~	(STD) RTA Code in Pricebook per Model			
14	✓	Investigations 104	GLB	GCU	B2460REF	24"d x 60"w x 29.5"h, Rectangular Table w/ Fixed Top, 4 Tapered Legs w/ Levelers and Bungee Cords, Each Table can be "Bungee-Tied" to other Tables of the Same Depth, BUNGEE TABLES	1	\$ 419.64	\$ 419.64
					~	(STD) Thermally Fused Laminate, High Performance (1" Thick)			
					~BNGE	Bungee Laminate Finishes			
					BRC	1-Brushed Cobalt			
					SI	F-Silver			
					~	Casters Not Required			
					~	Grommet/Electric/Villa Not Required - Left Position			
					~	Grommet/Electric/Villa Not Required - Center Position			
					~	Grommet/Electric/Villa Not Required - Right Position			
					~	Grommet/Electric/Villa Not Required - Custom Grommet Location			
sub		Investigations 104				Investigations 104 Subtotal			\$ 1,366.04
15	✓	Patrol 107	GLB	GUS	6711	POPCORN, Wall Saver, Polypropylene Back & Seat, Armless, Std Sled Chrome Frame, Std Without Glides, Stacks 10 High on Floor, 34 high on Dolly, GLOBAL SEATING USA	6	\$ 86.32	\$ 517.92
					~DPLS	Polypropylene Back / Seat Selections			
					PLT	1-Platinum [PLT]			
					CH	F-Chrome Frame [CH]			
					CG	M-Clear Glide			
					~	(STD) RTA Code in Pricebook per Model			
16	✓	Patrol 107	GLB	GCU	G60CH	Round Top - Cross Base-Self Edge - 60W x 29H, Boardroom Tables	1	\$ 468.52	\$ 468.52
					~	(STD) Thermally Fused Laminate, High Performance (1" Thick)			
					~BTOP	Boardroom Table Top Finishes			
					BRC	1-Brushed Cobalt			
					~BBASE	Boardroom Table Base Finishes			
					BRC	2-Brushed Cobalt			
					~	Grommet/Electrical Not Required - Center Position			
					~	Grommet/Electrical Not Required - Custom Grommet Location			
sub		Patrol 107				Patrol 107 Subtotal			\$ 986.44

**\*\*Quoted price is the discounted cash price. Payment by credit card will incur a 3% processing fee.**

**\*\*50% Deposit required to place order with the factory.**

**\*\*Sales tax to be applied to final order, if applicable.**

**\*\*PRICING REFLECTED ON THIS QUOTE IS VALID FOR 90 DAYS (UNLESS OTHERWISE NOTED).**

Date: \_\_\_\_\_

Approved by: \_\_\_\_\_

P:\customer files\LAUREN\City of Lincoln\Lincoln Police Dept\Quotes\City of Lincoln-Lincoln Police Department - Global 041818.sp4

Created by: Kylie Plate  
 kplate@resourceoneoffice.com  
 04/19/18 13:30:02

Lincoln Police Department-Global

Lauren Nevius  
 Inevius@resourceoneoffice.com  
 Mobile: 217-691-8421

Item	✓	Tag	5	Mfg	Cat	Part Number	Part Description	Qty	Sell	Ext Sell
17	✓	Sgt. 109		GLB	GUS	6901	SIDERO, Side Chair, Wall Saver, Armless, Std 4 Legged Base, Black Polypropylene Foot, Stack 5 high on Floor, Stacks 8 High on Dolly, GLOBAL SEATING USA	2	\$ 236.60	\$ 473.20
						~04	Grade 04			
						~MRTH	Marathon (Momentum)			
						MR72	1-Oats			
						TU	F-Tungsten Frame [TUN]			
						~	(STD) Black Glide			
						~	(STD) Standard Chair Back Design			
						~	(STD) Fire Barrier Lining Not Required			
						~	(STD) RTA Code in Pricebook per Model			
sub		Sgt. 109					Sgt. 109 Subtotal			\$ 473.20
18	✓	Shared Conference 121		GLB	GCU	A2036SK	Serving Cart w/2 hinged doors/2 box drawers/1 slide-out tray+storage shelf-20D x 36W x 36H, ADAPTABILITIES	1	\$ 873.60	\$ 873.60
						~	(STD) Thermally Fused Laminate, High Performance (1" Thick)			
						~ATOP	Adaptabilities Top Finishes			
						ASN	1-Asian Night			
						~ABODY	Adaptabilities Storage Body Finishes			
						ASN	2-Asian Night			
						A3	F-1"Top, Standard Edge			
						SI	M-Silver			
19	✘	Shared Conference 121	5	GLB	GUS	2222-6	WEEV, Mesh Back, Medium Back, Task, Armless, Std Molded Black Base, Std 2" Dual Wheel Carpet Casters, GLOBAL SEATING USA	10	\$ 276.64	\$ 2,766.40
						~04	Grade 04			
						~BEE1	Beeline (Momentum)			
						BN85	1-Fossil			
						AL	F-Aluminum Frame [ALU]			
						~	C-(STD) Black, 2" Dual-Wheel Caster [C1]			
						~	(STD)			
20	✓	Shared Conference 121		GLB	GCU	GCT10WBA	Boat Shape - Arch Base-Self Edge - 48D x 120W x 29H, Boardroom Tables	1	\$ 767.00	\$ 767.00
						~	(STD) Thermally Fused Laminate, High Performance (1" Thick)			
						~BTOP	Boardroom Table Top Finishes			
						ASN	1-Asian Night			
						~BBASE	Boardroom Table Base Finishes			
						ASN	2-Asian Night			
						~	(STD) Table 1 Piece			
						~	Grommet/Electrical Not Required - Left Position			
						~	Grommet/Electrical Not Required - Center Position			
						~	Grommet/Electrical Not Required - Right Position			
sub		Shared Conferenc...					Shared Conference 121 Subtotal			\$ 4,407.00

**\*\*Quoted price is the discounted cash price. Payment by credit card will incur a 3% processing fee.**  
**\*\*50% Deposit required to place order with the factory.**  
**\*\*Sales tax to be applied to final order, if applicable.**  
**\*\*PRICING REFLECTED ON THIS QUOTE IS VALID FOR 90 DAYS (UNLESS OTHERWISE NOTED).**

Created by: Kylie Plate  
 kplate@resourceoneoffice.com  
 04/19/18 13:30:02

Approved by: \_\_\_\_\_

Date: \_\_\_\_\_

# Lincoln Police Department-Global

6 of 6

Lauren Nevius  
 Inevius@resourceoneoffice.com  
 Mobile: 217-691-8421

Item	✓	Tag	Mfg	Cat	Part Number	Part Description	Qty	Sell	Ext Sell
21	✓	Training Room 129	GLB	GUS	6764C	SPRITZ, Mesh Back, Low Back, Armless, Flip Seat Nesting Chair, Std w/ Casters, GLOBAL SEATING USA	50	\$ 268.60	\$ 14,430.00
					U1	M-Black, Mesh Back [U1]			
					~04	Grade 04			
					~BEE1	Beeline (Momentum)			
					BN85	1-Fossil			
					TU	F-Tungsten Frame [TUN]			
					~	C-(STD) Black, 2" Dual Wheel Carpet Caster [C1]			
					~	(STD) RTA Code in Pricebook per Model			
22	✓	Training Room 129	GLB	GCU	A1844LC	Lectern w/angled stand, storage shelf and casters - 18D x 24W x 44H, ADAPTABILITIES	1	\$ 334.35	\$ 334.35
					~	(STD) Thermally Fused Laminate, High Performance (1" Thick)			
					~ATOP	Adaptabilities Top Finishes			
					ASN	1-Asian Night			
					~ABODY	Adaptabilities Storage Body Finishes			
					ASN	2-Asian Night			
					A3	F-1"Top, Standard Edge			
					~	Grommet/Electrical Not Required - Custom Grommet Location			
23	✓	Training Room 129	GLB	GCU	BX2460RES	24"d x 60"w x 29.5"h, Rectangular Table w/ Flip Top, 2 Spider Legs w/ Locking Casters and Bungee Cords, Each Table can be "Bungee-Tied" to other Tables of the Same Depth, BUNGEE TABLES	25	\$ 593.32	\$ 14,833.00
					~	(STD) Thermally Fused Laminate, High Performance (1" Thick)			
					~BNGE	Bungee Laminate Finishes			
					ASN	1-Asian Night			
					SI	F-Silver			
					~	Grommet/Electric/Villa Not Required - Left Position			
					~	Grommet/Electric/Villa Not Required - Center Position			
					~	Grommet/Electric/Villa Not Required - Right Position			
					~	Grommet/Electric/Villa Not Required - Custom Grommet Location			
sub		Training Room 129				Training Room 129 Subtotal			\$ 29,597.36
						**Freight	1	\$ 0.00	\$ 0.00
						**Delivery and Installation	1	\$ 0.00	\$ 0.00
						Grand Total			\$ 47,360.66

\*\*Quoted price is the discounted cash price. Payment by credit card will incur a 3% processing fee.

\*\*50% Deposit required to place order with the factory.

\*\*Sales tax to be applied to final order, if applicable.

**\*\*PRICING REFLECTED ON THIS QUOTE IS VALID FOR 90 DAYS (UNLESS OTHERWISE NOTED).**

Date: \_\_\_\_\_

Approved by: \_\_\_\_\_

Created by: Kylie Plate  
 kplate@resourceoneoffice.com  
 04/19/18 13:30:02



# Lincoln Police Department - Knoll

1 of 17

Lauren Nevius  
 Inevius@resourceoneoffice.com  
 Mobile: 217-691-8421

Item	✓	Tag	Mfg	Cat	Part Number	Part Description	Qty	Sell	Ext Sell
1	✓	Administration 144	KNO	KS2	DT4WSBLH6424FFL  (CORE) 114T (KEYALIKE) (LOCK2)	Series 2 steel front Side Access Bookcase with 2 file drawers, with left wardrobe (right hand bookcase), 63-5/16Hx23-7/8Wx23-1/2D, with lock, Recessed Pull  Core Paints PAINT: Folkstone Grey (textured) LOCK: Keyed Alike Specify 2 lock cores & keys separately	1	\$ 818.06	\$ 818.06
2	✓	Administration 144	KNO	KDH	DP8VMMRR4236  5 114T K (CORE) 114T (W1597) W159711	Preconfigured Panel, Full View, Monolithic/Monolithic, Fabric to Raceway Side 1 & 2, 42Hx36W  TOPCAP: Flat Metal TOPCAP: Folkstone Grey (Textured) RACE: with Knockouts Core Paints RACE: Folkstone Grey (Textured) FABRIC: Beacon (Gr10) COL: Cool Gray	2	\$ 196.56	\$ 393.12
3	✓	Administration 144	KNO	KDH	DP8VMMRR4230  5 114T K (CORE) 114T (W1597) W159711	Preconfigured Panel, Full View, Monolithic/Monolithic, Fabric to Raceway Side 1 & 2, 42Hx30W  TOPCAP: Flat Metal TOPCAP: Folkstone Grey (Textured) RACE: with Knockouts Core Paints RACE: Folkstone Grey (Textured) FABRIC: Beacon (Gr10) COL: Cool Gray	1	\$ 180.50	\$ 180.50
4	✓	Administration 144	KNO	KDH	D1R2415  (CORE) 144 (CORE) 144 (CORE) 114T	Counter Worksurface, 24Wx15D  Core Laminates LAM: Graphite Pear Core Edgebands EDGE: Graphite Pear Core Paints BRACKET: Folkstone Grey (Textured)	1	\$ 103.32	\$ 103.32
5	✓	Administration 144	KNO	KDH	D1R6615  (CORE) 144 (CORE) 144 (CORE) 114T	Counter Worksurface, 66Wx15D  Core Laminates LAM: Graphite Pear Core Edgebands EDGE: Graphite Pear Core Paints BRACKET: Folkstone Grey (Textured)	1	\$ 131.99	\$ 131.99
6	✓	Administration 144	KNO	KS2	DS4PFL30A  ~ (CORE) 114T (KEYALIKE) (LOCK)	Floorstanding Pedestal, Series 2 steel front, Box/Box/File, 29-1/4D, with lock, Recessed Pull  Standard box drawer slides Core Paints PAINT: Folkstone Grey (textured) LOCK: Keyed Alike Specify lock core & key separately	1	\$ 248.85	\$ 248.85

**\*\*Quoted price is the discounted cash price. Payment by credit card will incur a 3% processing fee.**

**\*\*50% Deposit required to place order with the factory.**

**\*\*Sales tax to be applied to final order, if applicable.**

**\*\*PRICING REFLECTED ON THIS QUOTE IS VALID FOR 90 DAYS (UNLESS OTHERWISE NOTED).**

Created by: Leigh Boehm  
 lboehm@resourceoneoffice.com  
 04/19/18 11:37:55

Date: \_\_\_\_\_

Approved by: \_\_\_\_\_

# Lincoln Police Department - Knoll

**2 of 17**  
 Lauren Nevius  
 Inevius@resourceoneoffice.com  
 Mobile: 217-691-8421

Item	✓	Tag	Mfg	Cat	Part Number	Part Description	Qty	Sell	Ext Sell
7	✓	Administration 144	KNO	KDH	D1R1515S (CORE) 144 (CORE) 144	Corner Counter Worksurface, 15Wx15D, Square Shape  Core Laminates LAM: Graphite Pear Core Edgebands EDGE: Graphite Pear	1	\$ 71.51	\$ 71.51
8	✓	Administration 144	KNO	KDH	D1R5424G (CORE) 144 (CORE) 144	Worksurface, Rectangular, 54Wx24D, with grommet  Core Laminates LAM: Graphite Pear Core Edgebands EDGE: Graphite Pear	1	\$ 126.00	\$ 126.00
9	✓	Administration 144	KNO	KDH	D1R7224G (CORE) 144 (CORE) 144	Worksurface, Rectangular, 72Wx24D, with grommet  Core Laminates LAM: Graphite Pear Core Edgebands EDGE: Graphite Pear	1	\$ 152.46	\$ 152.46
10	✓	Administration 144	KNO	KDH	D1R7230N (CORE) 144 (CORE) 144	Worksurface, Rectangular, 72Wx30D, no grommet  Core Laminates LAM: Graphite Pear Core Edgebands EDGE: Graphite Pear	1	\$ 186.17	\$ 186.17
11	✓	Administration 144	KNO	KS2	DS2XPB (CORE) 114T	Floorstanding Pedestal Case Back  Core Paints PAINT: Folkstone Grey (textured)	1	\$ 33.71	\$ 33.71
12	✓	Administration 144	KNO	KS2	DS4PFL24B (CORE) 114T (KEYALIKE) (LOCK)	Floorstanding Pedestal, Series 2 steel front, File/File, 23-1/4D, with lock, no back, Recessed Pull  Core Paints PAINT: Folkstone Grey (textured) LOCK: Keyed Allike Specify lock core & key separately	1	\$ 175.14	\$ 175.14
13	✓	Administration 144	KNO	KDH	DD1EU24 (CORE S) 114	End Unit Support, 14-7/8Wx24D  Smooth Core Paints PAINT: Folkstone Grey	1	\$ 137.34	\$ 137.34
14	✓	Administration 144	KNO	KDH	DP8VPA4225 114T	Two Way Post Assembly "L", 42H, Horizon, metal flat, Full View  PAINT: Folkstone Grey (Textured)	1	\$ 52.61	\$ 52.61
15	✓	Administration 144	KNO	KDH	DB1C24R 114T	Cantilever Bracket, Right, 24"D, Single Pack  PAINT: Folkstone Grey (Textured)	1	\$ 23.00	\$ 23.00
16	✓	Administration 144	KNO	KDH	DB1C30L 114T	Cantilever Bracket, Left, 30"D, Single Pack  PAINT: Folkstone Grey (Textured)	1	\$ 31.50	\$ 31.50
17	✓	Administration 144	KNO	KDH	DP5PE42 114T	Panel End Assembly, 42H, metal flat  PAINT: Folkstone Grey (Textured)	1	\$ 22.37	\$ 22.37

**\*\*Quoted price is the discounted cash price. Payment by credit card will incur a 3% processing fee.**

**\*\*50% Deposit required to place order with the factory.**

**\*\*Sales tax to be applied to final order, if applicable.**

**\*\*PRICING REFLECTED ON THIS QUOTE IS VALID FOR 90 DAYS (UNLESS OTHERWISE NOTED).**

Date: \_\_\_\_\_

Approved by: \_\_\_\_\_

P:\customer files\LAUREN\City of Lincoln\Lincoln Police Dept\Quotes\City of Lincoln-Lincoln Police Department - Knoll 041818.sp4

Created by: Leigh Boehm  
 lboehm@resourceoneoffice.com  
 04/19/18 11:37:55

Lincoln Police Department - Knoll

3 of 17  
 Lauren Nevius  
 lnevius@resourceoneoffice.com  
 Mobile: 217-691-8421

Item	✓	Tag	Mfg	Cat	Part Number	Part Description	Qty	Sell	Ext Sell
18	✓	Administration 144	KNO	KDH	DP5TCTSP 114T	Panel-to-Panel Top Cap Transition, used with metal flat - Single Pack PAINT: Folkstone Grey (Textured)	1	\$ 2.21	\$ 2.21
19	✓	Administration 144	KNO	KDH	DB1F24SP	Flat Bracket 24" - Single Pack	2	\$ 9.77	\$ 19.54
20	✓	Administration 144	KNO	KDH	DP3PWS42	Panel/Screen Wall Starter, 42H	1	\$ 36.54	\$ 36.54
21	✓	Administration 144	KNO	KDH	DB1PWSP 114T	Panel-to-Worksurface Bracket, Pair PAINT: Folkstone Grey (Textured)	1	\$ 5.99	\$ 5.99
22	✓	Administration 144	KNO	KDH	DP8PPC	Panel to Panel Connector, In Line, 10 Pack	1	\$ 6.62	\$ 6.62
23	✓	Administration 144	KNO	REF	RMSCB P1 (CORE) 114	Mid-Span Cantilever Bracket OPT: P1 Paint Core Paint PAINT: Folkstone Grey	1	\$ 25.83	\$ 25.83
24	✓	Administration 144	KNO	REF	KSPEC4MS	Set of 4 cores/keys, matte silver	1	\$ 0.00	\$ 0.00
sub		Administration 144				Administration 144 Subtotal			\$ 2,984.38
25	✓	Chief 149	KNO	REF	RBDH72MF L 144	Modesly Panel, 72Wx28-3/8H, Flush Cantilevered, for 28-3/8" planning Laminate LAM: Graphite Pear	1	\$ 175.77	\$ 175.77
26	✓	Chief 149	KNO	REF	RC7233DHB (L) (CORE) 144 W	Bookcase, Open with 4 Shelves, 72-1/2Hx30Wx24D, Flush Base, for 28-3/8" planning SURF: Laminate Core Laminates LAM: Graphite Pear INT: Wood	2	\$ 807.66	\$ 1,615.32
27	✓	Chief 149	KNO	KES	LED2IN19 SLV	Highwire LED Undercabinet Light, Individual Light, 19W (35 LEDs) FINISH: Silver	1	\$ 132.84	\$ 132.84
28	✓	Chief 149	KNO	REF	ROHHC5HC721DH L S (KEYALIKE) (LOCK2) F 613 (L) 144 (L) 144	Hutch, Single High Case, Hinged Door, cubby exposed, 72Wx15Dx20H, for 28-3/8" planning 2 Lock Holes Drilled Silver lock LOCK: Keyed Alike Specify 2 lock cores & keys separately Bar Pull PULL: Silver CASE: Core Laminate LAM: Graphite Pear FRONT: Core Laminate LAM: Graphite Pear	1	\$ 1,030.68	\$ 1,030.68

**\*\*Quoted price is the discounted cash price. Payment by credit card will incur a 3% processing fee.**  
**\*\*50% Deposit required to place order with the factory.**  
**\*\*Sales tax to be applied to final order, if applicable.**  
**\*\*PRICING REFLECTED ON THIS QUOTE IS VALID FOR 90 DAYS (UNLESS OTHERWISE NOTED).**

Created by: Leigh Boehm  
 lboehm@resourceoneoffice.com  
 04/19/18 11:37:55

Date: \_\_\_\_\_

Approved by: \_\_\_\_\_

# Lincoln Police Department - Knoll

Item	✓	Tag	Mfg	Cat	Part Number	Part Description	Qty	Sell	Ext Sell
29	✓	Chief 149	KNO	REF	ROHSHS721DHD  N (L) 144 (W1597) W15973	Hutch, Single High Surround, drilled for Hinged Door unit, 72Wx15Dx43H, for 1-1/2" worksurface, for 28-3/8" planning  BACK: Unfinished Laminate LAM: Graphite Pear FABRIC: Beacon (Gr10) COL: Fossil	1	\$ 417.38	\$ 417.38
30	✓	Chief 149	KNO	REF	RP163J  L (CORE) 144 L (CORE) 144 M F 613 L S (KEYALIKE) (LOCK)	Pedestal, Box/Box/File, 16Wx29Dx28-3/8H, Flush Base, for 28-3/8" planning  CASE: Laminate Core Laminates LAM: Graphite Pear FRONT: Laminate Core Laminates LAM: Graphite Pear INT: Metal Bar Pull PULL: Silver Lock Hole Drilled Silver lock LOCK: Keyed Alike Specify lock core & key separately	1	\$ 491.40	\$ 491.40
31	✓	Chief 149	KNO	REF	RP163K  L (CORE) 144 L (CORE) 144 M F 613 L S (KEYALIKE) (LOCK)	Pedestal, File/File, 16Wx29Dx28-3/8H, Flush Base, for 28-3/8" planning  CASE: Laminate Core Laminates LAM: Graphite Pear FRONT: Laminate Core Laminates LAM: Graphite Pear INT: Metal Bar Pull PULL: Silver Lock Hole Drilled Silver lock LOCK: Keyed Alike Specify lock core & key separately	1	\$ 472.82	\$ 472.82

**\*\*Quoted price is the discounted cash price. Payment by credit card will incur a 3% processing fee.**  
**\*\*50% Deposit required to place order with the factory.**  
**\*\*Sales tax to be applied to final order, if applicable.**  
**\*\*PRICING REFLECTED ON THIS QUOTE IS VALID FOR 90 DAYS (UNLESS OTHERWISE NOTED).**

Created by: Leigh Boehm  
 lboehm@resourceoneoffice.com  
 04/19/18 11:37:55

Approved by: \_\_\_\_\_

Date: \_\_\_\_\_

Lincoln Police Department - Knoll

5 of 17  
 Lauren Nevius  
 lnevius@resourceoneoffice.com  
 Mobile: 217-691-8421

Item	✓	Tag	Mfg	Cat	Part Number	Part Description	Qty	Sell	Ext Sell
32	✓	Chief 149	KNO	REF	RP162K	Pedestal, File/File, 16Wx23Dx28-3/8H, Flush Base, for 28-3/8" planning	2	\$ 442.58	\$ 885.16
					L	CASE: Laminate			
					(CORE)	Core Laminates			
					144	LAM: Graphite Pear			
					L	FRONT: Laminate			
					(CORE)	Core Laminates			
					144	LAM: Graphite Pear			
					M	INT: Metal			
					F	Bar Pull			
					613	PULL: Silver			
					L	Lock Hole Drilled			
					S	Silver lock			
					(KEYALIKE)	LOCK: Keyed Alike			
					(LOCK)	Specify lock core & key separately			
33	✓	Chief 149	KNO	REF	RPDHB18	Pedestal Back, 16Wx28-3/8H, for 28-3/8" planning	2	\$ 86.31	\$ 172.62
					L	Laminate			
					(CORE)	Core Laminates			
					144	LAM: Graphite Pear			
34	✓	Chief 149	KNO	REF	RSD722	Worksurface, Rectangular, 72Wx24Dx1-1/2H	1	\$ 203.49	\$ 203.49
					F	Flush Grommet			
					613	GROM: Silver			
					(L)	TOP: Laminate			
					(CORE)	Core Laminates			
					144	LAM: Graphite Pear			
					144	EDGE: Graphite Pear			
35	✓	Chief 149	KNO	REF	RSD724	Worksurface, Rectangular, 72Wx36Dx1-1/2H	1	\$ 256.10	\$ 256.10
					N	No Grommet			
					~	No grommet finish necessary			
					(L)	TOP: Laminate			
					(CORE)	Core Laminates			
					144	LAM: Graphite Pear			
					144	EDGE: Graphite Pear			
36	✓	Chief 149	KNO	REF	KSPEC6MS	Set of 6 cores/keys, matte silver	1	\$ 0.00	\$ 0.00
sub		Chief 149				Chief 149 Subtotal			\$ 5,863.68

**\*\*Quoted price is the discounted cash price. Payment by credit card will incur a 3% processing fee.**  
**\*\*50% Deposit required to place order with the factory.**  
**\*\*Sales tax to be applied to final order, if applicable.**  
**\*\*PRICING REFLECTED ON THIS QUOTE IS VALID FOR 90 DAYS (UNLESS OTHERWISE NOTED).**

Created by: Leigh Boehm  
 lboehm@resourceoneoffice.com  
 04/19/18 11:37:55

Approved by: \_\_\_\_\_

Date: \_\_\_\_\_

Lincoln Police Department - Knoll

6 of 17  
 Lauren Nevius  
 Inevius@resourceoneoffice.com  
 Mobile: 217-691-8421

Item	✓	Tag	Mfg	Cat	Part Number	Part Description	Qty	Sell	Ext Sell
37	✓	Deputy Chief 145	KNO	REF	RP163J L (CORE) 144 L (CORE) 144 M F 613 L S (KEYALIKE) (LOCK)	Pedestal, Box/Box/File, 18Wx29Dx28-3/8H, Flush Base, for 28-3/8" planning  CASE: Laminate Core Laminates LAM: Graphite Pear FRONT: Laminate Core Laminates LAM: Graphite Pear INT: Metal Bar Pull PULL: Silver Lock Hole Drilled Silver lock LOCK: Keyed Alike Specify lock core & key separately	1	\$ 491.40	\$ 491.40
38	✓	Deputy Chief 145	KNO	REF	REDH29F L 144	End Panel, 29Wx28-3/8H, Flush/Cantilevered Worksurface, for 28-3/8" planning  Laminate LAM: Graphite Pear	1	\$ 89.46	\$ 89.46
39	✓	Deputy Chief 145	KNO	REF	RP362K L (CORE) 144 L (CORE) 144 M F 613 L S (KEYALIKE) (LOCK)	Pedestal, File/File, 36Wx23Dx28-3/8H, Flush Base, for 28-3/8" planning  CASE: Laminate Core Laminates LAM: Graphite Pear FRONT: Laminate Core Laminates LAM: Graphite Pear INT: Metal Bar Pull PULL: Silver Lock Hole Drilled Silver lock LOCK: Keyed Alike Specify lock core & key separately	2	\$ 529.83	\$ 1,059.66
40	✓	Deputy Chief 145	KNO	REF	RC863DHG L (CORE) 144 L (CORE) 144 M F 613 L S (KEYALIKE) (LOCK2)	Cabinet with 2 File Drawers Below, Hinged Doors Above, 86Hx36Wx24D, Flush Base, for 28-3/8" planning  CASE: Laminate Core Laminates LAM: Graphite Pear FRONT: Laminate Core Laminates LAM: Graphite Pear INT: Metal Bar Pull PULL: Silver 2 Lock Holes Drilled Silver lock LOCK: Keyed Alike Specify 2 lock cores & keys separately	1	\$ 1,416.87	\$ 1,416.87

**\*\*Quoted price is the discounted cash price. Payment by credit card will incur a 3% processing fee.**

**\*\*50% Deposit required to place order with the factory.**

**\*\*Sales tax to be applied to final order, if applicable.**

**\*\*PRICING REFLECTED ON THIS QUOTE IS VALID FOR 90 DAYS (UNLESS OTHERWISE NOTED).**

Created by: Leigh Boehm  
 lboehm@resourceoneoffice.com  
 04/19/18 11:37:55

Date: \_\_\_\_\_

Approved by: \_\_\_\_\_

Lincoln Police Department - Knoll

Item	✓	Tag	Mfg	Cat	Part Number	Part Description	Qty	Sell	Ext Sell
41	✓	Deputy Chief 145	KNO	KDH	DT1ACX42 613T (CORE) 144 144	Round Table with X Base, Standard Desk Height, 42" Wide  BASE: Silver (Textured) Core Laminates TOP: Graphite Pear EDGE: Graphite Pear	1	\$ 461.16	\$ 461.16
42	✓	Deputy Chief 145	KNO	KDH	DS1PCD	Center Drawer	1	\$ 85.68	\$ 85.68
43	✓	Deputy Chief 145	KNO	KES	LED2IN19 SLV	Highwire LED Undercabinet Light, Individual Light, 19W (35 LEDs)  FINISH: Silver	1	\$ 132.84	\$ 132.84
44	✓	Deputy Chief 145	KNO	REF	ROMHCDHP361 L 144 L 144 F 613 L S (KEYALIKE) (LOCK)	Overhead Cabinet, Wall Hung, Hinged Doors, cubby exposed, 36Wx15Dx33H, for 28-3/8" planning  CASE: Core Laminate LAM: Graphite Pear FRONT: Core Laminate LAM: Graphite Pear Bar Pull PULL: Silver Lock Hole Drilled Silver lock LOCK: Keyed Alike Specify lock core & key separately	2	\$ 764.51	\$ 1,529.02
45	✓	Deputy Chief 145	KNO	REF	RSD724 N ~ (L) (CORE) 144 144	Worksurface, Rectangular, 72Wx36Dx1-1/2H  No Grommet No grommet finish necessary TOP: Laminate Core Laminates LAM: Graphite Pear EDGE: Graphite Pear	1	\$ 256.10	\$ 256.10
46	✓	Deputy Chief 145	KNO	REF	RSD483 F 613 (L) (CORE) 144 144	Worksurface, Rectangular, 48Wx30Dx1-1/2H  Flush Grommet GROM: Silver TOP: Laminate Core Laminates LAM: Graphite Pear EDGE: Graphite Pear	1	\$ 186.48	\$ 186.48
47	✓	Deputy Chief 145	KNO	REF	RC663DHB L (CORE) 144 W	Bookcase, Open with 5 Shelves, 86Hx36Wx24D, Flush Base, for 28-3/8" planning  SURF: Laminate Core Laminates LAM: Graphite Pear INT: Wood	1	\$ 1,036.67	\$ 1,036.67
48	✓	Deputy Chief 145	KNO	REF	RCD1082 (L) (CORE) 144 144	Credenza Top, 108Wx24Dx1-1/2H  TOP: Laminate Core Laminates LAM: Graphite Pear EDGE: Graphite Pear	1	\$ 433.13	\$ 433.13

**\*\*Quoted price is the discounted cash price. Payment by credit card will incur a 3% processing fee.**

**\*\*50% Deposit required to place order with the factory.**

**\*\*Sales tax to be applied to final order, if applicable.**

**\*\*PRICING REFLECTED ON THIS QUOTE IS VALID FOR 90 DAYS (UNLESS OTHERWISE NOTED).**

Date: \_\_\_\_\_

Approved by: \_\_\_\_\_



# Lincoln Police Department - Knoll

8 of 17

Lauren Nevius  
 Inevius@resourceoneoffice.com  
 Mobile: 217-691-8421

Item	✓	Tag	Mfg	Cat	Part Number	Part Description	Qty	Sell	Ext Sell
49	✓	Deputy Chief 145	KNO	REF	RPDHB36 L (CORE) 144	Pedestal Beck, 36Wx28-3/8H, for 28-3/8" planning Laminate Core Laminates LAM: Graphite Pear	2	\$ 101.43	\$ 202.86
50	✓	Deputy Chief 145	KNO	REF	RSDHL24 L (CORE) 144	L-Base, 24Wx28-3/8Hx12D, for 28-3/8" planning Laminate Core Laminates LAM: Graphite Pear	1	\$ 187.43	\$ 187.43
51	✓	Deputy Chief 145	KNO	REF	RBDH48MF L 144	Modesty Panel, 48Wx28-3/8H, Flush Cantilevered, for 28-3/8" planning Laminate LAM: Graphite Pear	1	\$ 141.12	\$ 141.12
52	✓	Deputy Chief 145	KNO	REF	RBDH72MF L 144	Modesty Panel, 72Wx28-3/8H, Flush Cantilevered, for 28-3/8" planning Laminate LAM: Graphite Pear	1	\$ 175.77	\$ 175.77
53	✓	Deputy Chief 145	KNO	REF	ROMCGDHP361 L 144	Overhead Cabinet, Wall Hung, Open/Cubby, 36Wx15Dx33H, w/Center Gable, for 28-3/8" planning Core Laminate LAM: Graphite Pear	1	\$ 660.87	\$ 660.87
54	✓	Deputy Chief 145	KNO	REF	RWHDHTB54H1  (W1597) W15973	Tackboard, Wall Hung, 54W, H1 height FABRIC: Beacon (Gr10) COL: Fossil	2	\$ 120.33	\$ 240.66
55	✓	Deputy Chief 145	KNO	REF	KSPEC7MS	Set of 7 cores/keys, matte silver	1	\$ 0.00	\$ 0.00
56	✓	Deputy Chief 145	KNO	REF	RDTGA  613	Desktop Grommet, 1-1/2" high GROM: Silver	1	\$ 11.66	\$ 11.66
57	✓	Deputy Chief 145	KNO	REF	RBF	Top to Top Bracket (2)	2	\$ 1.58	\$ 3.16
sub		Deputy Chief 145				Deputy Chief 145 Subtotal			\$ 8,802.00
58	✓	Inv. Sgt. 106	KNO	KFS	C2F5136WCCCC  (CORE S) 114	Calibre Lateral File, 4-12" drawers with rails, 36Wx51H, with individual locking drawers Smooth Core Paints PAINT: Folkstone Grey	1	\$ 801.50	\$ 801.50
59	✓	Inv. Sgt. 106	KNO	KFS	3B30C05  ~ (CORE S) 114 (KEYALIKE) (LOCK)	Floorstanding Pedestal, box/box/file, 15Wx30Dx26-7/8H, with standard lock Standard box drawer slides Smooth Core Paints PAINT: Folkstone Grey LOCK: Keyed Alike Specify lock core & key separately	1	\$ 330.89	\$ 330.89
60	✓	Inv. Sgt. 106	KNO	KFS	3B24C07  (CORE S) 114 (KEYALIKE) (LOCK)	Floorstanding Pedestal, file/file, 15Wx24Dx26-7/8H, with standard lock Smooth Core Paints PAINT: Folkstone Grey LOCK: Keyed Alike Specify lock core & key separately	1	\$ 300.92	\$ 300.92

**\*\*Quoted price is the discounted cash price. Payment by credit card will incur a 3% processing fee.**

**\*\*50% Deposit required to place order with the factory.**

**\*\*Sales tax to be applied to final order, if applicable.**

**\*\*PRICING REFLECTED ON THIS QUOTE IS VALID FOR 90 DAYS (UNLESS OTHERWISE NOTED).**

Date: \_\_\_\_\_

Approved by: \_\_\_\_\_

P:\customer files\LAUREN\City of Lincoln\Lincoln Police Dept\Quotes\City of Lincoln-Lincoln Police Department - Knoll 041818.sp4

Created by: Leigh Boehm  
 lboehm@resourceoneoffice.com  
 04/19/18 11:37:55

Lincoln Police Department - Knoll

Item	✓	Tag	Mfg	Cat	Part Number	Part Description	Qty	Sell	Ext Sell
61	✓	Inv. Sgt. 106	KNO	REF	RSD482 F 613 (L) (CORE) 144 144	Worksurface, Rectangular, 48Wx24Dx1-1/2H  Flush Grommet GROM: Silver TOP: Laminate Core Laminates LAM: Graphite Pear EDGE: Graphite Pear	1	\$ 163.80	\$ 163.80
62	✓	Inv. Sgt. 106	KNO	REF	RSD722 N ~ (L) (CORE) 144 144	Worksurface, Rectangular, 72Wx24Dx1-1/2H  No Grommet No grommet finish necessary TOP: Laminate Core Laminates LAM: Graphite Pear EDGE: Graphite Pear	1	\$ 203.49	\$ 203.49
63	✓	Inv. Sgt. 106	KNO	REF	RSD724 A 613 (L) (CORE) 144 144	Worksurface, Rectangular, 72Wx36Dx1-1/2H  Alternative Location Grommet GROM: Silver TOP: Laminate Core Laminates LAM: Graphite Pear EDGE: Graphite Pear	1	\$ 256.10	\$ 256.10
64	✓	Inv. Sgt. 106	KNO	REF	RC7231DHB (L) (CORE) 144 W	Bookcase, Open with 4 Shelves, 72-1/2Hx30Wx15D, Flush Base, for 28-3/8" planning  SURF: Laminate Core Laminates LAM: Graphite Pear INT: Wood	1	\$ 683.24	\$ 683.24
66	✓	Inv. Sgt. 106	KNO	REF	RSDHL24 L (CORE) 114	L-Base, 24Wx28-3/8Hx12D, for 28-3/8" planning  Laminate Core Laminates LAM: Folkstone Grey	1	\$ 187.43	\$ 187.43
66	✓	Inv. Sgt. 106	KNO	REF	RBDH72MF L 114	Modesty Panel, 72Wx28-3/8H, Flush Cantilevered, for 28-3/8" planning  Laminate LAM: Folkstone Grey	1	\$ 175.77	\$ 175.77
67	✓	Inv. Sgt. 106	KNO	REF	REDH29F L 114	End Panel, 29Wx28-3/8H, Flush/Cantilevered Worksurface, for 28-3/8" planning  Laminate LAM: Folkstone Grey	1	\$ 89.46	\$ 89.46
68	✓	Inv. Sgt. 106	KNO	REF	KSPEC1MS	Set of 1 cores/keys, matte silver	4	\$ 0.00	\$ 0.00
69	✓	Inv. Sgt. 106	KNO	REF	KSPEC2MS	Set of 2 cores/keys, matte silver	1	\$ 0.00	\$ 0.00

**\*\*Quoted price is the discounted cash price. Payment by credit card will incur a 3% processing fee.**

**\*\*50% Deposit required to place order with the factory.**

**\*\*Sales tax to be applied to final order, if applicable.**

**\*\*PRICING REFLECTED ON THIS QUOTE IS VALID FOR 90 DAYS (UNLESS OTHERWISE NOTED).**

Date: \_\_\_\_\_

Approved by: \_\_\_\_\_

Created by: Leigh Boehm  
 lboehm@resourceoneoffice.com  
 04/19/18 11:37:55

# Lincoln Police Department - Knoll

**10 of 17**  
 Lauren Nevius  
 lnevius@resourceoneoffice.com  
 Mobile: 217-691-8421

Item	✓	Tag	Mfg	Cat	Part Number	Part Description	Qty	Sell	Ext Sell
70	✓	Inv. Sgt. 106	KNO	REF	RMSCB P1 (CORE) 114	Mid-Span Cantilever Bracket  OPT: P1 Paint Core Paint PAINT: Folkstone Grey	1	\$ 25.83	\$ 25.83
71	✓	Inv. Sgt. 106	KNO	REF	RDTGA  613	Desktop Grommet, 1-1/2" high  GROM: Silver	1	\$ 11.66	\$ 11.66
72	✓	Inv. Sgt. 106	KNO	REF	RBF	Top to Top Bracket (2)	2	\$ 1.58	\$ 3.16
sub		Inv. Sgt. 106				Inv. Sgt. 106 Subtotal			\$ 3,233.25
73	✓	Investigations 104	KNO	KDH	DP5PE78  114T	Panel End Assembly, 78H, metal flat  PAINT: Folkstone Grey (Textured)	1	\$ 25.83	\$ 25.83
74	✓	Investigations 104	KNO	KDH	DP8VMMRR7830  5 114T K (CORE) 114T (W1597) W159711	Preconfigured Panel, Full View, Monolithic/Monolithic, Fabric to Raceway Side 1 & 2, 78Hx30W  TOPCAP: Flat Metal TOPCAP: Folkstone Grey (Textured) RACE: with Knockouts Core Paints RACE: Folkstone Grey (Textured) FABRIC: Beacon (Gr10) COL: Cool Gray	1	\$ 311.85	\$ 311.85
75	✓	Investigations 104	KNO	KDH	DP8VMMRR7824  5 114T K (CORE) 114T (W1597) W159711	Preconfigured Panel, Full View, Monolithic/Monolithic, Fabric to Raceway Side 1 & 2, 78Hx24W  TOPCAP: Flat Metal TOPCAP: Folkstone Grey (Textured) RACE: with Knockouts Core Paints RACE: Folkstone Grey (Textured) FABRIC: Beacon (Gr10) COL: Cool Gray	4	\$ 287.60	\$ 1,150.40
76	✓	Investigations 104	KNO	KDH	DP8VMMRR7836  5 114T K (CORE) 114T (W1597) W159711	Preconfigured Panel, Full View, Monolithic/Monolithic, Fabric to Raceway Side 1 & 2, 78Hx36W  TOPCAP: Flat Metal TOPCAP: Folkstone Grey (Textured) RACE: with Knockouts Core Paints RACE: Folkstone Grey (Textured) FABRIC: Beacon (Gr10) COL: Cool Gray	1	\$ 338.94	\$ 338.94
77	✓	Investigations 104	KNO	KDH	DP5TCTTP  114T	Panel-to-Panel Top Cap Transition, used with metal flat - 10 Pack  PAINT: Folkstone Grey (Textured)	1	\$ 21.74	\$ 21.74
78	✓	Investigations 104	KNO	KDH	DP8VPA7825  114T	Two Way Post Assembly "L", 78H, Horizon, metal flat, Full View  PAINT: Folkstone Grey (Textured)	2	\$ 97.34	\$ 194.68
79	✓	Investigations 104	KNO	KDH	DB1C24R  114T	Cantilever Bracket, Right, 24"D, Single Pack  PAINT: Folkstone Grey (Textured)	1	\$ 23.00	\$ 23.00

**\*\*Quoted price is the discounted cash price. Payment by credit card will incur a 3% processing fee.**  
**\*\*50% Deposit required to place order with the factory.**  
**\*\*Sales tax to be applied to final order, if applicable.**  
**\*\*PRICING REFLECTED ON THIS QUOTE IS VALID FOR 90 DAYS (UNLESS OTHERWISE NOTED).**

Created by: Leigh Boehm  
 lboehm@resourceoneoffice.com  
 04/19/18 11:37:55

Approved by: \_\_\_\_\_

Date: \_\_\_\_\_

**Lincoln Police Department - Knoll**

**11 of 17**

Lauren Nevius  
 Inevius@resourceoneoffice.com  
 Mobile: 217-691-8421

Item	✓	Tag	Mfg	Cat	Part Number	Part Description	Qty	Sell	Ext Sell
80	✓	Investigations 104	KNO	KDH	DB1C24L 114T	Cantilever Bracket, Left, 24"D, Single Pack PAINT: Folkstone Grey (Textured)	1	\$ 23.00	\$ 23.00
81	✓	Investigations 104	KNO	KDH	DB1PWSP 114T	Panel-to-Worksurface Bracket, Pair PAINT: Folkstone Grey (Textured)	2	\$ 5.99	\$ 11.98
82	✓	Investigations 104	KNO	KDH	DP8PPC	Panel to Panel Connector, In Line, 10 Pack	1	\$ 6.62	\$ 6.62
83	✓	Investigations 104	KNO	KDH	DP3PWS78	Panel/Screen Wall Starter, 78H	1	\$ 42.84	\$ 42.84
84	✓	Investigations 104	KNO	KDH	DS1O48L (CORE) 114T (CORE) 114T (KEYALIKE) (LOCK)	Overhead Cabinet with lock, 48Wx14Dx15H Core Paints PAINT: Folkstone Grey (Textured) Core Paints TRIM: Folkstone Grey (Textured) LOCK: Keyed Alike Specify lock core & key separately	5	\$ 167.27	\$ 836.35
85	✓	Investigations 104	KNO	KES	F-48-20 S1 A 10 (W1597) W159711 FWMR20	Universal Fabric Board, 48Wx20H OPT: Squared Corner/Rectilinear Edge OPT: 1/2" Mineral Board OPT: Fabric Group (F10) FABRIC: Beacon COL: Cool Gray OPT: 1/2" Reveal Wall-Mount	4	\$ 270.95	\$ 1,083.80
86	✓	Investigations 104	KNO	KS2	DS4PFL24A F (CORE) 114T (KEYALIKE) (LOCK)	Floorstanding Pedestal, Series 2 steel front, Box/Box/File, 23-1/4D, with lock, no back, Recessed Pull Full extension box drawer slides Core Paints PAINT: Folkstone Gray (textured) LOCK: Keyed Alike Specify lock core & key separately	5	\$ 192.78	\$ 963.90
87	✓	Investigations 104	KNO	KS2	DS4PFL24B (CORE) 114T (KEYALIKE) (LOCK)	Floorstanding Pedestal, Series 2 steel front, File/File, 23-1/4D, with lock, no back, Recessed Pull Core Paints PAINT: Folkstone Grey (textured) LOCK: Keyed Alike Specify lock core & key separately	5	\$ 175.14	\$ 875.70
88	✓	Investigations 104	KNO	KDH	D1D7230N (CORE) 144 (CORE) 144	Worksurface, "D" Peninsula, 72Wx30D Core Laminates LAM: Graphite Pear Core Edgebands EDGE: Graphite Pear	2	\$ 270.59	\$ 541.18
89	✓	Investigations 104	KNO	KDH	D1R4824G (CORE) 144 (CORE) 144	Worksurface, Rectangular, 48Wx24D, with grommet Core Laminates LAM: Graphite Pear Core Edgebands EDGE: Graphite Pear	5	\$ 117.18	\$ 585.90

**\*\*Quoted price is the discounted cash price. Payment by credit card will incur a 3% processing fee.**  
**\*\*50% Deposit required to place order with the factory.**  
**\*\*Sales tax to be applied to final order, if applicable.**  
**\*\*PRICING REFLECTED ON THIS QUOTE IS VALID FOR 90 DAYS (UNLESS OTHERWISE NOTED).**

Created by: Leigh Boehm  
 lboehm@resourceoneoffice.com  
 04/19/18 11:37:55

Approved by: \_\_\_\_\_

Date: \_\_\_\_\_

# Lincoln Police Department - Knoll

**12 of 17**  
**Lauren Nevius**  
 Inevius@resourceoneoffice.com  
 Mobile: 217-691-8421

Item	✓	Tag	Mfg	Cat	Part Number	Part Description	Qty	Sell	Ext Sell
90	✓	Investigations 104	KNO	KDH	D1R7224N  (CORE) 144 (CORE) 144	Worksurface, Rectangular, 72Wx24D, no grommet  Core Laminates LAM: Graphite Pear Core Edgebands EDGE: Graphite Pear	5	\$ 148.48	\$ 732.40
91	✓	Investigations 104	KNO	KS2	DT4WSBLH6424FFL  (CORE) 114T (KEYALIKE) (LOCK2)	Series 2 steel front Side Access Bookcase with 2 file drawers, with left wardrobe (right hand bookcase), 63-5/16Hx23-7/8Wx23-1/2D, with lock, Recessed Pull  Core Paints PAINT: Folkstone Grey (textured) LOCK: Keyed Alike Specify 2 lock cores & keys separately	1	\$ 1,051.79	\$ 1,051.79
92	✓	Investigations 104	KNO	KS2	DT4WSBRH6424FFL  (CORE) 114T (KEYALIKE) (LOCK2)	Series 2 steel front Side Access Bookcase with 2 file drawers, with right wardrobe (left hand bookcase), 63-5/16Hx23-7/8Wx23-1/2D, with lock, Recessed Pull  Core Paints PAINT: Folkstone Grey (textured) LOCK: Keyed Alike Specify 2 lock cores & keys separately	4	\$ 1,051.79	\$ 4,207.16
93	✓	Investigations 104	KNO	KDH	DS2XPB  (CORE) 114T	Floorstanding Pedestal Case Back  Core Paints PAINT: Folkstone Grey (textured)	10	\$ 33.71	\$ 337.10
94	✓	Investigations 104	KNO	KDH	DB1TB  (CORE) 114T	T-Support Base, 23-1/2Wx12Dx26-7/8H  Core Paints PAINT: Folkstone Grey (Textured)	2	\$ 105.21	\$ 210.42
96	✓	Investigations 104	KNO	KDH	DD1EU24  (CORE S) 114	End Unit Support, 14-7/8Wx24D  Smooth Core Paints PAINT: Folkstone Grey	4	\$ 137.34	\$ 549.36
96	✓	Investigations 104	KNO	KDH	DD1FBPD72  (CORE S) 114	Back Panel for 72" Desk/Table, Full Height  Smooth Core Paints PAINT: Folkstone Grey	4	\$ 89.15	\$ 356.60
97	✓	Investigations 104	KNO	KDH	DD1TEU30  (CORE S) 114	T-End Unit, 27-13/16Wx26-7/8H  Smooth Core Paints PAINT: Folkstone Grey	2	\$ 122.22	\$ 244.44
98	✓	Investigations 104	KNO	KDH	DS1WM48  114	Overhead Wall Mount Bracket, 48W  PAINT: Folkstone Grey (smooth)	4	\$ 35.91	\$ 143.64
99	✓	Investigations 104	KNO	KES	LED2IN19  SLV	Highwire LED Undercabinet Light, Individual Light, 19W (35 LEDs)  FINISH: Silver	5	\$ 132.84	\$ 664.20
100	✓	Investigations 104	KNO	KDH	DB1F24TP	Flat Bracket 24" - 10 Pack	1	\$ 76.86	\$ 76.86
101	✓	Investigations 104	KNO	REF	KSPEC5MS	Set of 5 cores/keys, matte silver	5	\$ 0.00	\$ 0.00
sub		Investigations 104				Investigations 104 Subtotal			\$ 15,611.68

**\*\*Quoted price is the discounted cash price. Payment by credit card will incur a 3% processing fee.**

**\*\*50% Deposit required to place order with the factory.**

**\*\*Sales tax to be applied to final order, if applicable.**

**\*\*PRICING REFLECTED ON THIS QUOTE IS VALID FOR 90 DAYS (UNLESS OTHERWISE NOTED).**

Date: \_\_\_\_\_

Approved by: \_\_\_\_\_

P:\customer files\LAUREN\City of Lincoln\Lincoln Police Dept\Quotes\City of Lincoln-Lincoln Police Department - Knoll 041818.sp4

Created by: Leigh Boehm  
 lboehm@resourceoneoffice.com  
 04/19/18 11:37:55

Lincoln Police Department - Knoll

13 of 17  
 Lauren Nevius  
 lnevius@resourceoneoffice.com  
 Mobile: 217-691-8421

Item	✓	Tag	Mfg	Cat	Part Number	Part Description	Qty	Sell	Ext Sell
102	✓	Family 123 and Report Taking 101	KNO	KS2	DS4PFL24A	Floorstanding Pedestal, Series 2 steel front, Box/Box/File, 23-1/4D, with lock, no back, Recessed Pull	2	\$ 182.78	\$ 385.56
					F (CORE) 114 (KEYALIKE) (LOCK)	Full extension box drawer slides Core Paints PAINT: Folkstone Grey (smooth) LOCK: Keyed Alike Specify lock core & key separately			
103	✓	Family 123 and Report Taking 101	KNO	KDH	D1R6030N	Worksurface, Rectangular, 60Wx30D, no grommet	2	\$ 162.23	\$ 324.46
					(CORE) 144 (CORE) 144	Core Laminates LAM: Graphite Pear Core Edgebands EDGE: Graphite Pear			
104	✓	Family 123 and Report Taking 101	KNO	KDH	D52XPB	Floorstanding Pedestal Case Back	2	\$ 33.71	\$ 67.42
					(CORE) 114	Core Paints PAINT: Folkstone Grey (smooth)			
105	✓	Family 123 and Report Taking 101	KNO	KDH	DD1EU24	End Unit Support, 14-7/8Wx24D	2	\$ 137.34	\$ 274.68
					(CORE S) 114	Smooth Core Paints PAINT: Folkstone Grey			
106	✓	Family 123 and Report Taking 101	KNO	KDH	DD1FBPD60	Back Panel for 60" Desk/Table, Full Height	2	\$ 83.79	\$ 167.58
					(CORE S) 114	Smooth Core Paints PAINT: Folkstone Grey			
107	✓	Family 123 and Report Taking 101	KNO	REF	KSPEC1MS	Set of 1 cores/keys, matte silver	2	\$ 0.00	\$ 0.00
sub		Juvenile 123				Juvenile 123 Subtotal			\$ 1,219.70
108	✓	Records 102	KNO	KDH	DP8VMMRR4224	Preconfigured Panel, Full View, Monolithic/Monolithic, Fabric to Raceway Side 1 & 2, 42Hx24W	2	\$ 166.32	\$ 332.64
					5 114T K (CORE) 114T (W1597) W159711	TOPCAP: Flat Metal TOPCAP: Folkstone Grey (Textured) RACE: with Knockouts Core Paints RACE: Folkstone Grey (Textured) FABRIC: Beacon (Gr10) COL: Cool Gray			
109	✓	Records 102	KNO	KDH	DP8VMMRR4230	Preconfigured Panel, Full View, Monolithic/Monolithic, Fabric to Raceway Side 1 & 2, 42Hx30W	6	\$ 180.50	\$ 1,083.00
					5 114T K (CORE) 114T (W1597) W159711	TOPCAP: Flat Metal TOPCAP: Folkstone Grey (Textured) RACE: with Knockouts Core Paints RACE: Folkstone Grey (Textured) FABRIC: Beacon (Gr10) COL: Cool Gray			

**\*\*Quoted price is the discounted cash price. Payment by credit card will incur a 3% processing fee.**  
**\*\*50% Deposit required to place order with the factory.**  
**\*\*Sales tax to be applied to final order, if applicable.**  
**\*\*PRICING REFLECTED ON THIS QUOTE IS VALID FOR 90 DAYS (UNLESS OTHERWISE NOTED).**

Created by: Leigh Boehm  
 lboehm@resourceoneoffice.com  
 04/19/18 11:37:55

Date: \_\_\_\_\_

Approved by: \_\_\_\_\_

# Lincoln Police Department - Knoll

**14 of 17**  
 Lauren Nevius  
 Inevius@resourceoneoffice.com  
 Mobile: 217-691-8421

Item	✓	Tag	Mfg	Cat	Part Number	Part Description	Qty	Sell	Ext Sell
110	✓	Records 102	KNO	KDH	DP8VMMRR4236 5 114T K (CORE) 114T (W1597) W159711	Preconfigured Panel, Full View, Monolithic/Monolithic, Fabric to Raceway Side 1 & 2, 42Hx36W  TOPCAP: Flat Metal TOPCAP: Folkstone Grey (Textured) RACE: with Knockouts Core Paints RACE: Folkstone Grey (Textured) FABRIC: Beacon (Gr10) COL: Cool Gray	2	\$ 196.66	\$ 393.12
111	✓	Records 102	KNO	KDH	D1R3015  (CORE) 144 (CORE) 144 (CORE) 114T	Counter Worksurface, 30Wx15D  Core Laminates LAM: Graphite Pear Core Edgebands EDGE: Graphite Pear Core Paints BRACKET: Folkstone Grey (Textured)	2	\$ 112.46	\$ 224.92
112	✓	Records 102	KNO	KES	F-4B-20  S1 A 10 (W1597) W15978 FWMR20	Universal Fabric Board, 48Wx20H  OPT: Squared Corner/Rectilinear Edge OPT: 1/2" Mineral Board OPT: Fabric Group (F10) FABRIC: Beacon COL: Reef OPT: 1/2" Reveal Wall-Mount	3	\$ 270.95	\$ 812.85
113	✓	Records 102	KNO	KS2	DS4PFL24A  F (CORE) 114T (KEYALIKE) (LOCK)	Floorstanding Pedestal, Series 2 steel front, Box/Box/File, 23-1/4D, with lock, no back, Recessed Pull  Full extension box drawer slides Core Paints PAINT: Folkstone Grey (textured) LOCK: Keyed Alike Specify lock core & key separately	2	\$ 182.78	\$ 385.56
114	✓	Records 102	KNO	KDH	DS3PML48L  114T 144 144 (KEYALIKE) (LOCK)	Horizon Overhead Cabinet with Laminate Flip-Up Door, 48W, with Lock  CASE: Folkstone Grey (Textured) DOOR: Graphite Pear DOOR EDGE: Graphite Pear LOCK: Keyed Alike Specify lock core & key separately	2	\$ 320.04	\$ 640.08
115	✓	Records 102	KNO	KDH	D1R6019N  (CORE) 144 (CORE) 144	Worksurface, Rectangular, 60Wx19D, no grommet  Core Laminates LAM: Graphite Pear Core Edgebands EDGE: Graphite Pear	2	\$ 114.98	\$ 229.96
116	✓	Records 102	KNO	KDH	D1R6024N  (CORE) 144 (CORE) 144	Worksurface, Rectangular, 60Wx24D, no grommet  Core Laminates LAM: Graphite Pear Core Edgebands EDGE: Graphite Pear	2	\$ 129.47	\$ 258.94

**\*\*Quoted price is the discounted cash price. Payment by credit card will incur a 3% processing fee.**  
**\*\*50% Deposit required to place order with the factory.**  
**\*\*Sales tax to be applied to final order, if applicable.**  
**\*\*PRICING REFLECTED ON THIS QUOTE IS VALID FOR 90 DAYS (UNLESS OTHERWISE NOTED).**

Created by: Leigh Boehm  
 lboehm@resourceoneoffice.com  
 04/19/18 11:37:55

Date: \_\_\_\_\_

Approved by: \_\_\_\_\_



Lincoln Police Department - Knoll

15 of 17  
 Lauren Nevius  
 Inevius@resourceoneoffice.com  
 Mobile: 217-691-8421

Item	✓	Tag	Mfg	Cat	Part Number	Part Description	Qty	Sell	Ext Sell
117	✓	Records 102	KNO	KDH	D1R6624N  (CORE) 144 (CORE) 144	Worksurface, Rectangular, 66Wx24D, no grommet  Core Laminates LAM: Graphite Pear Core Edgebands EDGE: Graphite Pear	2	\$ 139.55	\$ 279.10
118	✓	Records 102	KNO	KS2	DS4DW30L  (CORE) 114T (KEYALIKE) (LOCK)	Doublewide Pedestal, Series 2 steel front, File/File, 30Wx18-3/4D, with lock, Recessed Pull  Core Paints PAINT: Folkstone Grey (textured) LOCK: Keyed Alike Specify lock core & key separately	4	\$ 326.97	\$ 1,307.88
119	✓	Records 102	KNO	KDH	DS1S48  (CORE) 114T	Overhead Bookshelf, 48Wx14Dx8H  Core Paints PAINT: Folkstone Grey (Textured)	1	\$ 67.73	\$ 67.73
120	✓	Records 102	KNO	KDH	DS1SWM48  (CORE) 114T	Overhead Shelf Mount Bracket, 48W  Core Paints PAINT: Folkstone Grey (textured)	1	\$ 59.54	\$ 59.54
121	✓	Records 102	KNO	KDH	DB1C18L  114T	Cantilever Bracket, Left, 18"D, Single Pack  PAINT: Folkstone Grey (Textured)	2	\$ 17.33	\$ 34.66
122	✓	Records 102	KNO	KDH	DB1C18R  114T	Cantilever Bracket, Right, 18"D, Single Pack  PAINT: Folkstone Grey (Textured)	2	\$ 17.33	\$ 34.66
123	✓	Records 102	KNO	KDH	DB1C24L  114T	Cantilever Bracket, Left, 24"D, Single Pack  PAINT: Folkstone Grey (Textured)	1	\$ 23.00	\$ 23.00
124	✓	Records 102	KNO	KDH	DB1C24R  114T	Cantilever Bracket, Right, 24"D, Single Pack  PAINT: Folkstone Grey (Textured)	1	\$ 23.00	\$ 23.00
125	✓	Records 102	KNO	KDH	DS2XPB  (CORE) 114	Floorstanding Pedestal Case Back  Core Paints PAINT: Folkstone Grey (smooth)	2	\$ 33.71	\$ 67.42
126	✓	Records 102	KNO	KDH	DB1PWSP  114T	Panel-to-Worksurface Bracket, Pair  PAINT: Folkstone Grey (Textured)	3	\$ 5.99	\$ 17.97
127	✓	Records 102	KNO	KDH	DP5PE42  114T	Panel End Assembly, 42H, metal flat  PAINT: Folkstone Grey (Textured)	2	\$ 22.37	\$ 44.74
128	✓	Records 102	KNO	KDH	DP5TCTSP  114T	Panel-to-Panel Top Cap Transition, used with metal flat - Single Pack  PAINT: Folkstone Grey (Textured)	6	\$ 2.21	\$ 13.28
129	✓	Records 102	KNO	KDH	DP8VPA4225  114T	Two Way Post Assembly "L", 42H, Horizon, metal flat, Full View  PAINT: Folkstone Grey (Textured)	2	\$ 52.61	\$ 105.22
130	✓	Records 102	KNO	KDH	DS1WM48  114	Overhead Wall Mount Bracket, 48W  PAINT: Folkstone Grey (smooth)	2	\$ 35.91	\$ 71.82

**\*\*Quoted price is the discounted cash price. Payment by credit card will incur a 3% processing fee.**  
**\*\*50% Deposit required to place order with the factory.**  
**\*\*Sales tax to be applied to final order, if applicable.**  
**\*\*PRICING REFLECTED ON THIS QUOTE IS VALID FOR 90 DAYS (UNLESS OTHERWISE NOTED).**

Created by: Leigh Boehm  
 lboehm@resourceoneoffice.com  
 04/19/18 11:37:56

Approved by: \_\_\_\_\_  
 Date: \_\_\_\_\_

# Lincoln Police Department - Knoll

**16 of 17**  
 Lauren Nevius  
 lnevius@resourceoneoffice.com  
 Mobile: 217-691-8421

Item	✓	Tag	Mfg	Cat	Part Number	Part Description	Qty	Sell	Ext Sell
131	✓	Records 102	KNO	KES	LED2AD1936	Highwire Undercabinet Light, Interconnected Adder, 19W (35 LEDs), with 36 inch jumper	2	\$ 113.00	\$ 226.00
					SLV	FINISH: Silver			
132	✓	Records 102	KNO	KES	LED2IN19	Highwire LED Undercabinet Light, Individual Light, 19W (35 LEDs)	1	\$ 132.84	\$ 132.84
					SLV	FINISH: Silver			
133	✓	Records 102	KNO	KDH	DB1F18SP	Flat Bracket 18" - Single Pack	3	\$ 8.51	\$ 25.53
134	✓	Records 102	KNO	KDH	DB1F24SP	Flat Bracket 24" - Single Pack	2	\$ 9.77	\$ 19.54
135	✓	Records 102	KNO	KDH	DP3PWS42	Panel/Screen Wall Starter, 42H	2	\$ 36.54	\$ 73.08
136	✓	Records 102	KNO	KDH	DP8PPC	Panel to Panel Connector, In Line, 10 Pack	1	\$ 6.62	\$ 6.62
137	✓	Records 102	KNO	REF	KSPEC4MS	Set of 4 cores/keys, matte silver	2	\$ 0.00	\$ 0.00
sub		Records 102				Records 102 Subtotal			\$ 6,994.68
138	✓	Sgt. Office 109	KNO	KFS	3B30C05	Floorstanding Pedestal, box/box/file, 15Wx30Dx26-7/8H, with standard lock	1	\$ 330.89	\$ 330.89
					~	Standard box drawer slides			
					(CORE TX)	Textured Core Paints			
					114T	PAINT: Folkstone Grey (textured)			
					(KEYALIKE)	LOCK: Keyed Alike			
					(LOCK)	Specify lock core & key separately			
139	✓	Sgt. Office 109	KNO	KFS	3B24C07	Floorstanding Pedestal, filefile, 15Wx24Dx26-7/8H, with standard lock	1	\$ 300.92	\$ 300.92
					(CORE S)	Smooth Core Paints			
					114	PAINT: Folkstone Grey			
					(KEYALIKE)	LOCK: Keyed Alike			
					(LOCK)	Specify lock core & key separately			
140	✓	Sgt. Office 109	KNO	REF	RSD482	Worksurface, Rectangular, 48Wx24Dx1-1/2H	1	\$ 163.80	\$ 163.80
					F	Flush Grommet			
					613	GROM: Silver			
					(L)	TOP: Laminate			
					(CORE)	Core Laminates			
					144	LAM: Graphite Pear			
					144	EDGE: Graphite Pear			
141	✓	Sgt. Office 109	KNO	REF	RSD722	Worksurface, Rectangular, 72Wx24Dx1-1/2H	1	\$ 203.49	\$ 203.49
					F	Flush Grommet			
					613	GROM: Silver			
					(L)	TOP: Laminate			
					(CORE)	Core Laminates			
					144	LAM: Graphite Pear			
					144	EDGE: Graphite Pear			

**\*\*Quoted price is the discounted cash price. Payment by credit card will incur a 3% processing fee.**

**\*\*50% Deposit required to place order with the factory.**

**\*\*Sales tax to be applied to final order, if applicable.**

**\*\*PRICING REFLECTED ON THIS QUOTE IS VALID FOR 90 DAYS (UNLESS OTHERWISE NOTED).**

Created by: Leigh Boehm  
 lboehm@resourceoneoffice.com  
 04/19/18 11:37:56

Date: \_\_\_\_\_

Approved by: \_\_\_\_\_

P:\customer files\LAUREN\City of Lincoln\Lincoln Police Dept\Quotes\City of Lincoln-Lincoln Police Department - Knoll 041818.sp4

Lincoln Police Department - Knoll

17 of 17  
 Lauren Nevius  
 Inevius@resourceoneoffice.com  
 Mobile: 217-691-8421

Item	✓	Tag	Mfg	Cat	Part Number	Part Description	Qty	Sell	Ext Sell
142	✓	Sgt. Office 109	KNO	REF	RSD724 N ~ (L) (CORE) 144 144	Worksurface, Rectangular, 72Wx36Dx1-1/2H  No Grommet No grommet finish necessary TOP: Laminate Core Laminates LAM: Graphite Pear EDGE: Graphite Pear	1	\$ 256.10	\$ 256.10
143	✓	Sgt. Office 109	KNO	REF	RC7231DHB (L) (CORE) 144 W	Bookcase, Open with 4 Shelves, 72-1/2Hx30Wx15D, Flush Base, for 28-3/8" planning  SURF: Laminate Core Laminates LAM: Graphite Pear INT: Wood	1	\$ 683.24	\$ 683.24
144	✓	Sgt. Office 109	KNO	REF	RSDHL24 L (CORE) 114	L-Base, 24Wx28-3/8Hx12D, for 28-3/8" planning  Laminate Core Laminates LAM: Folkstone Grey	1	\$ 187.43	\$ 187.43
145	✓	Sgt. Office 109	KNO	REF	RBDH72MF L 114	Modesty Panel, 72Wx28-3/8H, Flush Cantilevered, for 28-3/8" planning  Laminate LAM: Folkstone Grey	1	\$ 175.77	\$ 175.77
146	✓	Sgt. Office 109	KNO	REF	REDH29F L 114	End Panel, 29Wx28-3/8H, Flush/Cantilevered Worksurface, for 28-3/8" planning  Laminate LAM: Folkstone Grey	1	\$ 89.46	\$ 89.46
147	✓	Sgt. Office 109	KNO	REF	KSPEC2MS	Set of 2 cores/keys, matte silver	1	\$ 0.00	\$ 0.00
148	✓	Sgt. Office 109	KNO	REF	RMSCB P1 (CORE) 114	Mid-Span Cantilever Bracket  OPT: P1 Paint Core Paint PAINT: Folkstone Gray	1	\$ 25.83	\$ 25.83
149	✓	Sgt. Office 109	KNO	REF	RDTGA 613	Desktop Grommet, 1-1/2" high  GROM: Silver	1	\$ 11.66	\$ 11.66
150	✓	Sgt. Office 109	KNO	REF	RBF	Top to Top Bracket (2)	2	\$ 1.58	\$ 3.18
sub		Sgt. Office 109				Sgt. Office 109 Subtotal			\$ 2,431.75
			KNO	KNO	KNO	Knoll Freight Included	1	\$ 0.00	\$ 0.00
			LABOR	LABOR	LABOR	Delivery and installation per prevailing wage rates for Logan County.	1	\$ 3,536.00	\$ 3,536.00
						*Pricing per US Communities Dealer Held Knoll Contract #C0041458	1	\$ 0.00	\$ 0.00
						Grand Total			\$ 60,667.02

\*\*Quoted price is the discounted cash price. Payment by credit card will incur a 3% processing fee.  
 \*\*50% Deposit required to place order with the factory.  
 \*\*Sales tax to be applied to final order, if applicable.  
 \*\*PRICING REFLECTED ON THIS QUOTE IS VALID FOR 90 DAYS (UNLESS OTHERWISE NOTED).

Created by: Leigh Boehm  
 lboehm@resourceoneoffice.com  
 04/19/18 11:37:56

Approved by: \_\_\_\_\_ Date: \_\_\_\_\_

City of Lincoln- Lincoln Police Department- Via Brisbane HD

Lauren Nevius  
lnevius@resourceoneoffice.com  
Mobile: 217-691-8421

Item	✓	Mfg	Cat	Part Number	Part Description	Qty	Sell	Ext Sell
1		VIA	VIA	1503-62C-39A5	BRISBANE HD, mid back medium (b) seat, syncro control with side tension adjustment with seat slide, black adjustable height roll back arms	6	\$ 519.11	\$ 3,114.66
				GRADE-3	FAB-GRADE: GRADE 3			
				FABRIC	FAB: Fabric			
				TOR	FULL BALLISTIC NYLON ON BACK, WHISPER VINYL PATINA ON SEAT			
				18BB	18" STANDARD BLACK BASE			
				16HP	STANDARD BLACK CARPET CASTERS			
				~	TB-133: NON - FIRE RETARDANT BACK PLASTIC SHELL			
				~	NO - UPHOLSTERED BACK SHELL			
				~	NO - PETITE SEAT OPTION (1" DESCREASED DEPTH)			
				~	NO - ADJUSTABLE ARM WIDTH BRACKET			
sub					<b>Subtotal</b>			<b>\$ 3,114.66</b>
		VIA	VIA	VIA	Via Freight Included	1	\$ 0.00	\$ 0.00
					<b>Grand Total</b>			<b>\$ 3,114.66</b>

**\*\*Quoted price is the discounted cash price. Payment by credit card will incur a 3% processing fee.**

**\*\*50% Deposit required to place order with the factory.**

**\*\*Sales tax to be applied to final order, if applicable.**

**\*\*PRICING REFLECTED ON THIS QUOTE IS VALID FOR 90 DAYS (UNLESS OTHERWISE NOTED).**

Created by: Leigh Boehm  
lboehm@resourceoneoffice.com  
04/19/18 11:42:08

Date: \_\_\_\_\_

Approved by: \_\_\_\_\_



# ILLINI SUPPLY, INC

111 Illini Drive  
Forsyth, IL 62535  
Phone (217) 877-6551 - Fax (217) 877-6646  
www.illinisupply.com

**Bill To:** Lincoln Police Department  
911 Pekin Street  
Lincoln, IL 62656

- Quotation
- Confirming Order
- Work Order

**Ship To:**

**Call Toll Free  
(800) 252-3370**

**A Certified Female Business Enterprise**

DATE	CUSTOMER P.O. NUMBER	Terms:	
04/19/18		Net 30 Days	
QUANTITY	DESCRIPTION	PRICE	EXTENSION
	Groupe Lacasse & Haworth Furnishings, per Attached		
	Room 101 Interview		\$1,042.95
	Room 102 Records		\$5,136.30
	Room 104 Investigations		\$14,388.70
	Room 106 Inv. Sgt.		\$4,364.90
	Room 107 Patrol		\$7,232.70
	Room 109 Sgt. Office		\$6,341.60
	Room 121 Shared Conference		\$4,552.20
	Room 122 Interview		\$1,042.95
	Room 123 Family		\$1,851.80
	Room 124 Interview		\$1,042.95
	Room 129 Training		\$25,379.95
	Room 130 Break Room		\$1,636.40
	Room 144 Administration		\$6,874.20
	Room 145 Deputy Chief		\$4,723.00
	Room 149 Chief		\$6,699.55
	Corridor C107 Files		\$2,089.20
	Subtotal		\$94,399.35
	ISI to Receive, Deliver & Install		\$9,840.00
			\$104,239.35
	Deduct to use 6 existing chairs		-\$1,836.00
			\$102,403.35
<b>We appreciate your business!</b>			

Unless noted, installation is quoted at our standard charges NOT prevailing wage.  
 Made to order products are not returnable – check with office regarding other items. All orders and quotations are subject to the approval from our headquarters., and quotations are subject to prompt acceptance and change without notice. All orders are subject to delays occasioned by accidents, strikes, fires or causes beyond our control. Claims for defective material or workmanship are to be made within ten days after the receipt of goods. We reserve the right to correct any clerical or stenographic errors. Plus sales tax when applicable. Unless otherwise agreed upon, interest at 18 per annum to be paid on accounts 30 days overdue. The title and ownership to the property called for and furnished under the terms of this contract shall remain in the seller until full and final payment in cash shall have been made according to the terms agreed upon. In case of default in payment, the seller may repossess the property wherever found and shall not be liable to anyone in any action for the return of any money paid nor for any damages whatsoever. Any money paid upon such account shall be deemed to have been paid as part compensation for the use of the product and to cover wear, tear and expenses. It is further agreed that no part of the product shall become a fixture of being attached to real estate.  
 We assume no liability for freight damage. We will assist you with your claims.

We accept order with noted changes:

Proposal Made By:

By \_\_\_\_\_

By:           Dana Ball

**LINCOLN POLICE DEPARTMENT**  
**Furniture Schedule**  
**4-19-18**

Qty	Part Number	Description	List	Discounted Sell	Extended Sell
<b>Room 101</b>					
1	LGC-CH433NNN	Base,Cross,Black Steel Leg	\$596.00	\$268.20	\$268.20
1	ST1NNN-SQ48	Top,Square,For Conf Tbl,48"	\$380.00	\$171.00	\$171.00
3	SCH-44-05	Very Wire Stacker, Plstc Seat, Plstc Bk, Armless	\$216.42	\$99.25	\$297.75
1	ON-11	Onyx Management Chair, standard synchronous control with forward tilt, adjustable height arms, grade 1 fabric	\$680.00	\$306.00	\$306.00
					\$1,042.95
<b>Room 102</b>					
1	41NN-E724416P	Hutch,4 Drs,Clearance 21 1/2",Grmt,Full-Wd Wire Acc.	\$1,214.00	\$546.30	\$546.30
1	41NN-EM422216P	Hutch,Wall-Mounted w/Doors,2 Doors 16"(400MM)D x 42"(1050MM)W x 22"(553MM)H	\$839.00	\$377.55	\$377.55
1	41YN-242473BL	Stg. or Wrdrb. Unit,Open Lft,3 Adj.&1 Full-Wd Fxd. Shlf,Full-Wd Hanger Bar,Alum Hndl 24"(600MM)Dx24"(600MM)Wx73"(1834MM)H	\$1,318.00	\$593.10	\$593.10
1	41YN-242473BR	Stg. or Wrdrb. Unit,Open Rt,3 Adj.&1 Full-Wd Fxd. Shlf,Full-Wd Hanger Bar,Alum Hndl 24"(600MM)Dx24"(600MM)Wx73"(1834MM)H	\$1,318.00	\$593.10	\$593.10
1	41YN-F3072S	Desk,Sngl Ped,Left,Full-Ht. Mod. Pnl,Strt Front,B/F,Alum Hndl,Pencil Tray 30"(750MM)D x 72"(1800MM)W	\$1,080.00	\$486.00	\$486.00
1	41YN-GF3072S	Reception Desk,Right,2 Grmts,Ped Left,B/F,w/Lk,Pencil Tray,Full-Ht Mod Pnl,Alum Hndl 30"(750MM)Dx72"(1800MM)W	\$1,509.00	\$679.05	\$679.05
2	41YN-R2442F	Return,Executive,Right,1 Ped,B/F,Alum Hndl,Pencil Tray,Lock,1 Grommet 24"(600MM)D x 42"(1050MM)W	\$788.00	\$354.60	\$709.20
1	LGC-T5LE25	Electronic fluorescent task lights T5, 25"	\$219.00	\$98.55	\$98.55
1	LGC-T5LE49	Electronic fluorescent task lights T5, 49"	\$271.00	\$121.95	\$121.95
1	LGC-TK4217M	Wall-Mount Tackboards, 42 x 1/2 x 17	\$327.00	\$147.15	\$147.15
1	LGC-TK7019E	Tackboards for hutch, 70 x 1/2 x 19	\$383.00	\$172.35	\$172.35
2	ON-11	Onyx Management Chair, standard synchronous control with forward tilt, adjustable height arms, grade 1 fabric	\$680.00	\$306.00	\$612.00
					\$5,136.30



**LINCOLN POLICE DEPARTMENT**  
**Furniture Schedule**  
**4-19-18**

Qty	Part Number	Description	List	Discounted Sell	Extended Sell
<b>Room 104</b>					
5	41NN-E724416P	Hutch,4 Drs,Clearance 21 1/2",Grmt,Full-Wd Wire Acc. 16"(400MM)Dx72"(1800MM)Wx44"(1099MM)H	\$1,214.00	\$546.30	\$2,731.50
5	41YN-242473BL	Stg. or Wrdrb. Unit,Open Lft,3 Adj.&1 Full-Wd Fxd. Shlf,Full-Wd Hanger Bar,Alum Hndl 24"(600MM)Dx24"(600MM)Wx73"(1834MM)H	\$1,318.00	\$593.10	\$2,965.50
3	41YN-F2442R	Return,Executive,Left,1 Ped,B/F,Alum Hndl,Pencil Tray,Lock,1 Grommet 24"(600MM)D x 42"(1050MM)W	\$788.00	\$354.60	\$1,063.80
2	41YN-F3072S	Desk,Sngl Ped,Left,Full-Ht. Mod. Pnl,Strt Front,B/F,Alum Hndl,Pencil Tray 30"(750MM)D x 72"(1800MM)W	\$1,080.00	\$486.00	\$972.00
2	41YN-R2442F	Return,Executive,Right,1 Ped,B/F,Alum Hndl,Pencil Tray,Lock,1 Grommet 24"(600MM)D x 42"(1050MM)W	\$788.00	\$354.60	\$709.20
3	41YN-S3072F	Desk,Sngl Ped,Right,Full-Ht. Mod. Pnl,Strt Front,B/F,Alum Hndl,Pencil Tray 30"(750MM)D x 72"(1800MM)W	\$1,080.00	\$486.00	\$1,458.00
1	LGC-CH433NNN	Base,Cross,Black Steel Leg(1) 33"(830MM)D x 33"(830MM)W x 28"(710MM)H	\$596.00	\$268.20	\$268.20
5	LGC-T5LE49	Electronic fluorescent task lights T5, 49"	\$271.00	\$121.95	\$609.75
5	LGC-TK7019E	Tackboards for hutch, 70 x 1/2 x 19	\$383.00	\$172.35	\$861.75
1	ST1NNN-R54	ROUND TOP - 54"(1350MM)W x 54"(1350MM)D	\$570.00	\$256.50	\$256.50
5	SCS-24-32E	Very Side Enhanced,Fab Seat,Perforated Bk,Arm,Sft Csts,	\$419.98	\$192.50	\$962.50
5	ON-11	Onyx Management Chair, standard synchronous control with forward tilt, adjustable height arms, grade 1 fabric	\$680.00	\$306.00	\$1,530.00
					\$14,388.70
<b>Room 106</b>					
1	41NN-BR2442	Bridge-Return,Full-Ht. Mod. Pnl,1 Grommet 24"(600MM)D x 42"(1050MM)W	\$355.00	\$159.75	\$159.75
1	41NN-E724416P	Hutch,4 Drs,Clearance 21 1/2",Grmt,Full-Wd Wire Acc. 16"(400MM)Dx72"(1800MM)Wx44"(1099MM)H	\$1,214.00	\$546.30	\$546.30
1	41NN-PT3072	Work Surface,P-Shaped,Left,Black Steel Leg,1 Grommet,No Mod. Pnl. 42"(1050MM)D x 72"(1800MM)W	\$912.00	\$410.40	\$410.40
1	41YN-243673B	Stg. or Wrdrb. Unit,Dbl Drs,3 Adj.&1 Full-Wd Fxd. Shlf,Full-Wd Hanger Bar,Alum Hndl	\$1,611.00	\$724.95	\$724.95



**LINCOLN POLICE DEPARTMENT**  
**Furniture Schedule**  
**4-19-18**

Qty	Part Number	Description	List	Discounted Sell	Extended Sell
<b>Room 106 Continued</b>					
1	41YN-B2072B	Credenza,Bookcase,Stg Unit w/Doors and Adj Shelf,Locks,Alum Hndl 20"(500MM)D x 72"(1800MM)W	\$1,407.00	\$633.15	\$633.15
1	41YN-S2472LF	Credenza,Lateral File,Right,2 Lat Files,Lock,Grommet on Mod. Pnl,Alum Hndl	\$1,467.00	\$660.15	\$660.15
1	4NYN-MP1518F	Pedestal,Mobile,B/F,Pencil Tray,w/Lock,Alum Hndl 18"(450MM)D x 15"(390MM)W x 20 3/4"(527MM)H	\$754.00	\$339.30	\$339.30
1	LGC-T5LE49	Electronic fluorescent task lights T5, 49"	\$271.00	\$121.95	\$121.95
1	LGC-TK7019E	Tackboards for hutch, 70 x 1/2 x 19	\$383.00	\$172.35	\$172.35
2	SCS-24-OHE	Very Side Enhanced,Fab Seat,Perforated Bk,Armless,Plstc Gld,	\$317.03	\$145.30	\$290.60
1	ON-11	Onyx Management Chair, standard synchronous control with forward tilt, adjustable	\$680.00	\$306.00	\$306.00
					\$4,364.90
<b>Room 107</b>					
1	LGC-CH433NNN	Base,Cross,Black Steel Leg(1) 33"(830MM)D x 33"(830MM)W x 28"(710MM)H	\$596.00	\$268.20	\$268.20
1	ST1NNN-R54	ROUND TOP - 54"(1350MM)W x 54"(1350MM)D	\$570.00	\$256.50	\$256.50
10	LAW01	Law Enforcement task chair, ratchet back, drop away arms	\$1,230.00	\$670.80	\$6,708.00
					\$7,232.70
<b>Room 109</b>					
1	41NN-BR2442	Bridge-Return,Full-Ht. Mod. Pnl,1 Grommet 24"(600MM)D x 42"(1050MM)W	\$355.00	\$159.75	\$159.75
1	41NN-E724416P	Hutch,4 Drs,Clearance 21 1/2",Grmt,Full-Wd Wire Acc. 16"(400MM)Dx72"(1800MM)Wx44"(1099MM)H	\$1,214.00	\$546.30	\$546.30
1	41NN-PT3072	Work Surface,P-Shaped,Left,Black Steel Leg,1 Grommet,No Mod. Pnl. 42"(1050MM)D x 72"(1800MM)W	\$912.00	\$410.40	\$410.40
1	41YN-S2472LF	Credenza,Lateral File,Right,2 Lat Files,Lock,Grommet on Mod. Pnl,Alum Hndl 24"(600MM)D x 72"(1800MM)W	\$1,467.00	\$660.15	\$660.15
1	4NYN-MP1518F	Pedestal,Mobile,B/F,Pencil Tray,w/Lock,Alum Hndl 18"(450MM)D x 15"(390MM)W x 20 3/4"(527MM)H	\$754.00	\$339.30	\$339.30
4	S41YNN-242473FCR	Stg. Unit,Single Dr,Opn Rt,w/2 Lateral Files w/Lk,Clothes Bar,Alum Hndl 24"(600MM)Dx24"(600MM)Wx73"(1834MM)H	\$1,650.00	\$742.50	\$2,970.00
1	LGC-T5LE49	Electronic fluorescent task lights T5, 49"	\$271.00	\$121.95	\$121.95

**LINCOLN POLICE DEPARTMENT**  
**Furniture Schedule**  
**4-19-18**

Qty	Part Number	Description	List	Discounted Sell	Extended Sell
<b>Room 109 Continued</b>					
1	LGC-TK7019E	Tackboards for hutch, 70 x ½ x 19	\$383.00	\$172.35	\$172.35
2	SCS-24-0HE	Very Side Enhanced, Fab Seat, Perforated Bk, Armless, Plstc Gld,	\$317.03	\$145.30	\$290.60
1	LAW01	Law Enforcement task chair, ratchet back, drop away arms	\$1,230.00	\$670.80	\$670.80
					\$6,341.60
<b>Room 121</b>					
1	41YN-MS213636	Cart, Mobile Serving, Sliding Shelf, 2 Box Drws, Pencil Tray, 2 Drs, 2 Shelves, Alum Hndl 21"(520MM)Dx36"(900MM)Wx36"(900MM)H	\$1,407.00	\$633.15	\$633.15
1	45NN-B144	Top, Boat-Shape, For Conf Tbl, (Order 3 Bases or 6 Legs Separately) 48"(1200MM)D x 144"(3600MM)W	\$1,228.00	\$552.60	\$552.60
1	LGC-P30.120144	Base, Panel, for 120"(3000MM) and 144"(3600MM) Tables 24"(600MM)D x 85"(2126MM)W x 28"(710MM)H	\$681.00	\$306.45	\$306.45
10	ON-11	Onyx Management Chair, standard synchronous control with forward tilt, adjustable height arms, grade 1 fabric	\$680.00	\$306.00	\$3,060.00
					\$4,552.20
<b>Room 122</b>					
1	LGC-CH433NNN	Base, Cross, Black Steel Leg(1) 33"(830MM)D x 33"(830MM)W x 28"(710MM)H	\$596.00	\$268.20	\$268.20
1	ST1NN-SQ48	Top, Square, For Conf Tbl, 48"(1200MM)D x 48"(1200MM)W	\$380.00	\$171.00	\$171.00
3	SCH-44-0S	Very Wire Stacker, Plstc Seat, Plstc Bk, Armless, Non Ganging,	\$216.42	\$99.25	\$297.75
1	ON-11	Onyx Management Chair, standard synchronous control with forward tilt, adjustable height arms, grade 1 fabric	\$680.00	\$306.00	\$306.00
					\$1,042.95
<b>Room 123</b>					
1	ASMOV14	Alphabet, Seating, MOV Stool, 14"	\$249.00	\$124.50	\$124.50
1	ASMOV16	Alphabet, Seating, MOV Stool, 16"	\$249.00	\$124.50	\$124.50
1	ASMOV18	Alphabet, Seating, MOV Stool, 18"	\$265.00	\$132.50	\$132.50
1	DTLP-4ATP	Shape Tbl, Leg Kit, 19"-29" Tbl Height, 4PK	\$143.00	\$71.50	\$71.50
1	DTT-NB3054E	Shape Tbl Top, Nebula, 30x54, Lam-Banded Flat Edge	\$359.00	\$179.50	\$179.50
		Freight			\$153.20

**LINCOLN POLICE DEPARTMENT**  
**Furniture Schedule**  
**4-19-18**

Qty	Part Number	Description	List	Discounted Sell	Extended Sell
<b>Room 123 Continued</b>					
1	41YN-F3060F	Desk,DbI Ped,Full-Ht. Mod. Pnl,Strt Front,B/F-B/F,Alum Hndl,Pencil Tray 30"(750MM)D x 60"(1500MM)W	\$1,248.00	\$561.60	\$561.60
2	SCH-44-0S	Very Wire Stacker, Plstc Seat, Plstc Bk, Armless, Non Ganging,	\$216.42	\$99.25	\$198.50
1	ON-11	Onyx Management Chair, standard synchronous control with forward tilt, adjustable height arms, grade 1 fabric	\$680.00	\$306.00	\$306.00
					\$1,851.80
<b>Room 124</b>					
1	LGC-CH433NNN	Base,Cross,Black Steel Leg(1) 33"(830MM)D x 33"(830MM)W x 28"(710MM)H	\$596.00	\$268.20	\$268.20
1	ST1NNN-SQ48	Top,Square,For Conf Tbl,48"(1200MM)D x 48"(1200MM)W	\$380.00	\$171.00	\$171.00
3	SCH-44-0S	Very Wire Stacker, Plstc Seat, Plstc Bk, Armless, Non Ganging,	\$216.42	\$99.25	\$297.75
1	ON-11	Onyx Management Chair, standard synchronous control with forward tilt, adjustable	\$680.00	\$306.00	\$306.00
					\$1,042.95
<b>Room 129</b>					
1	41NN-LC181844	Lectern,Fixed Shf,Grommet,4 Casters 18"(450MM)Dx24"(600MM)Wx44"(1112MM)H	\$811.00	\$364.95	\$364.95
25	T1NN-RCT2466	RECTANGULAR TOP - 1 inch laminate with smooth edge,66"(1650MM)W x 24"(600MM)D 2 PCS	\$393.00	\$176.85	\$4,421.25
25	TNNS-MTBFH24	T-BASE - Silver Metal Fip Top w/Casters	\$975.00	\$438.75	\$10,968.75
50	SCS-24-32E	Very Side Enhanced,Fab Seat,Perforated Bk,Arm,Sft Csts,	\$419.98	\$192.50	\$9,625.00
					\$25,379.95
<b>Room 130</b>					
2	LGC-CH433NNN	Base,Cross,Black Steel Leg(1) 33"(830MM)D x 33"(830MM)W x 28"(710MM)H	\$596.00	\$268.20	\$536.40
2	ST1NNN-SQ42	Top,Square,For Conf Tbl,42"D x 42"W	\$340.00	\$153.00	\$306.00
8	SCH-44-0S	Very Wire Stacker, Plstc Seat, Plstc Bk, Armless, Non Ganging,	\$216.42	\$99.25	\$794.00
					\$1,636.40

**LINCOLN POLICE DEPARTMENT**  
**Furniture Schedule**  
**4-19-18**

Qty	Part Number	Description	List	Discounted Sell	Extended Sell
<b>Room 144</b>					
1	41NN-BR2036	Bridge-Return,Full-Ht. Mod. Pnl,1 Grommet 20"(500MM)D x 36"(900MM)W	\$299.00	\$134.55	\$134.55
1	41NN-E724416P	Hutch,4 Drs,Clearance 21 1/2",Grmt,Full-Wd Wire Acc.	\$1,214.00	\$546.30	\$546.30
1	41YN-202473BL	Stg. or Wrdrb. Unit,Open Lft,3 Adj.&1 Full-Wd Fxd. Shlf,Full-Wd Hanger Bar,Alum	\$1,263.00	\$568.35	\$568.35
1	41YN-F2072S	Credenza,Single Ped,Left,B/F,Alum Hndl,Pencil Tray,Lock,Grommet on Mod. Pnl 20"(500MM)D x 72"(1800MM)W	\$948.00	\$426.60	\$426.60
1	41YN-GS3072F	Reception Desk,Left,2 Grmts,Ped Right,B/F,w/Lk,Pencil Tray,Full-Ht Mod Pnl,Alum Hndl 30"(750MM)Dx72"(1800MM)W	\$1,509.00	\$679.05	\$679.05
1	45NN-B144	Top,Boat-Shape,For Conf Tbl,(Order 3 Bases or 6 Legs Separately) 48"(1200MM)D x 144"(3600MM)W	\$1,228.00	\$552.60	\$552.60
1	LGC-P30.120144	Base,Panel,for 120"(3000MM) and 144"(3600MM) Tables 24"(600MM)D x 85"(2126MM)W x 28"(710MM)H	\$681.00	\$306.45	\$306.45
1	LGC-T5LE49	Electronic fluorescent task lights T5, 49"	\$271.00	\$121.95	\$121.95
1	LGC-TK7019E	Tackboards for hutch, 70 x 1/2 x 19	\$383.00	\$172.35	\$172.35
11	ON-11	Onyx Management Chair, standard synchronous control with forward tilt, adjustable height arms, grade 1 fabric	\$680.00	\$306.00	\$3,366.00
					\$6,874.20
<b>Room 145</b>					
1	41NN-EM722216P	Hutch,Wall-Mounted w/Doors,4 Doors 16"(400MM)D x 72"(1800MM)W x 22"(553MM)H	\$1,131.00	\$508.95	\$508.95
1	41YN-243673B	Stg. or Wrdrb. Unit,Dbl Drs,3 Adj.&1 Full-Wd Fxd. Shlf,Full-Wd Hanger Bar,Alum Hndl 24"(600MM)Dx36"(900MM)Wx73"(1834MM)H	\$1,611.00	\$724.95	\$724.95
1	41YN-243673LFB	Stg. Unit,Dbl Drs,w/2 Lateral Files w/Lk,2 Adj. Shlf,Alum Hndl 24"(600MM)Dx36"(900MM)Wx73"(1834MM)H	\$2,010.00	\$904.50	\$904.50
1	41YN-S4272FA	Desk,Sngl Ped,Right,Full-Ht. Mod. Pnl,Bow Front,B/F,Alum Hndl,Pencil Tray 42"(1050MM)D x 72"(1800MM) W	\$1,384.00	\$622.80	\$622.80
1	45NN-R42	Top,Round,For Conf Tbl,(Order Base Separately) 42"(1050MM)Dia	\$479.00	\$215.55	\$215.55
1	LGC-CR27	Base,Cross,For R42.2 Top 27"(680MM)D x 27"(680MM)W x 28"(710MM)H	\$412.00	\$185.40	\$185.40

**LINCOLN POLICE DEPARTMENT**  
**Furniture Schedule**  
**4-19-18**

Qty	Part Number	Description	List	Discounted Sell	Extended Sell
<b>Room 145 Continued</b>					
1	S41YN-F2448R.1	Return,Executive,Left,1 Ped,B/F,Alum Hndl,Pencil Tray,Lock,1 Grommet 24"(600MM)D x 48"(1200MM)W, 9"Mod	\$833.00	\$374.85	\$374.85
1	LGC-T5LE49	Electronic fluorescent task lights T5, 49"	\$271.00	\$121.95	\$121.95
1	LGC-TK7221M	Wall-Mount Tackboards, 72 x ½ x 21	\$393.00	\$176.85	\$176.85
4	SCS-24-OHE	Very Side Enhanced,Fab Seat,Perforated Bk,Armless,Plstc Gld,	\$317.03	\$145.30	\$581.20
1	ON-11	Onyx Management Chair, standard synchronous control with forward tilt, adjustable height arms, grade 1 fabric	\$680.00	\$306.00	\$306.00
					\$4,723.00
<b>Room 149</b>					
1	41NN-E724416P	Hutch,4 Drs,Clearance 21 1/2",Grmt,Full-Wd Wire Acc. 16"(400MM)Dx72"(1800MM)Wx44"(1099MM)H	\$1,214.00	\$546.30	\$546.30
1	41YN-243673B	Stg. or Wrdrb. Unit,Dbl Drs,3 Adj.&1 Full-Wd Fxd. Shlf,Full-Wd Hanger Bar,Alum Hndl 24"(600MM)Dx36"(900MM)Wx73"(1834MM)H	\$1,611.00	\$724.95	\$724.95
1	41YN-243673LFB	Stg. Unit,Dbl Drs,w/2 Lateral Files w/Lk,2 Adj. Shlf,Alum Hndl 24"(600MM)Dx36"(900MM)Wx73"(1834MM)H	\$2,010.00	\$904.50	\$904.50
1	41YN-F4272FA	Desk,Dbl Ped,Full-Ht. Mod. Pnl,Bow Front,B/F,Alum Hndl,Pencil Tray 42"(1050MM)D x 72"(1800MM) W	\$1,660.00	\$747.00	\$747.00
1	S41YN-F2472F.1	Credenza,Dbl Pedestal,BF/BF,Alum Hndl,Grommet on Back,Pencil Tray 24"(600MM)D x 72"(1800MM)W, 9"Mod	\$1,334.00	\$600.30	\$600.30
1	LGC-T5LE49	Electronic fluorescent task lights T5, 49"	\$271.00	\$121.95	\$121.95
1	LGC-TK7019E	Tackboards for hutch, 70 x ½ x 19	\$383.00	\$172.35	\$172.35
1	T1NN-ST244818	MAGAZINE TABLE - 1 inch laminate with smooth edge,Straight,48"(1200MM)W x 24"(600MM)D x 18"(450MM)H	\$709.00	\$319.05	\$319.05
2	SCS-24-OHE	Very Side Enhanced,Fab Seat,Perforated Bk,Armless,Plstc Gld,	\$317.03	\$145.30	\$290.60
1	ON-11	Onyx Management Chair, standard synchronous control with forward tilt, adjustable height arms, grade 1 fabric	\$680.00	\$306.00	\$306.00
1	TQ34-0013	Todo,Triple,Stationary,One Faux leather	\$4,238.99	\$1,966.55	\$1,966.55
					\$6,699.55

**LINCOLN POLICE DEPARTMENT  
Furniture Schedule  
4-19-18**

				<b>Discounted</b>	<b>Extended</b>
<b>Qty</b>	<b>Part Number</b>	<b>Description</b>	<b>List</b>	<b>Sell</b>	<b>Sell</b>
<b>Corridor C107</b>					
4	VFLZ05h	Metal Arc 5-drawer vertical file with independent locking drawers, security shelf between each drawer	\$1,700.00	\$522.30	\$2,089.20
					\$2,089.20

## MEMORANDUM

**TO:** Mayor and Aldermen of the City of Lincoln

**FROM:** Walt Landers, Street Superintendent

**MEETING**

**DATE:** April 23, 2018

**RE:** **2018 Motor Fuel Tax Program Resolution**

---

**Background**

Each Year, the City must provide a budget and design guidelines to the Illinois department of Transportation (IDOT) for its expenditures using Motor Fuel Tax (MFT) proceeds. The use of MFT funds are limited to the engineering, labor, maintenance, material and construction of roadways, sidewalks and curbing. Expenses which are limited in the resolution must take place within the current fiscal year. In order to be able to be reimbursed for the use of these funds, the state must approve the planned expenditures.

**Analysis/Discussion**

In this year's program, the City has stated that they have appropriated an amount of \$565,000.00 of MFT funds for the purpose of maintaining streets and related expenses. As mentioned before the program expenses will run from May 1, 2018 to April 30, 2019. An itemized listing of expenses is included in with your materials.

**Fiscal Impact**

The expenses planned for this year's MFT program are included in the fiscal year 2018/2019 Motor Fuel Tax Budget.

**COW Recommendation**

Place the 2018/2019 Motor Fuel Tax Program resolution on the May 7<sup>th</sup>, agenda.

**Council Recommendation:**

Adopt the 2018/2019 Motor Fuel Tax Program Resolution as presented.





Resolution for Maintenance Under the Illinois Highway Code



Resolution Number	Resolution Type	Section Number
	Original	18-00000-00-GM

BE IT RESOLVED, by the Council of the City of Lincoln Illinois that there is hereby appropriated the sum of Five hundred sixty-five thousand, and 00/100 Dollars (\$565,000.00) of Motor Fuel Tax funds for the purpose of maintaining streets and highways under the applicable provisions of Illinois Highway Code from 05/01/18 to 04/30/19

BE IT FURTHER RESOLVED, that only those operations as listed and described on the approved Estimate of Maintenance Costs, including supplemental or revised estimates approved in connection with this resolution, are eligible for maintenance with Motor Fuel Tax funds during the period as specified above.

BE IT FURTHER RESOLVED, that City of Lincoln shall submit within three months after the end of the maintenance period as stated above, to the Department of Transportation, on forms available from the Department, a certified statement showing expenditures and the balances remaining in the funds authorized for expenditure by the Department under this appropriation, and

BE IT FURTHER RESOLVED, that the Clerk is hereby directed to transmit four (4) certified originals of this resolution to the district office of the Department of Transportation.

I Ms. Peggy Batemen City Clerk in and for said City of Lincoln in the State of Illinois, and keeper of the records and files thereof, as provided by statute, do hereby certify the foregoing to be a true, perfect and complete copy of a resolution adopted by the Council of Lincoln at a meeting held on 05/07/18

IN TESTIMONY WHEREOF, I have hereunto set my hand and seal this 7th day of May, 2018

(SEAL)

Clerk Signature

APPROVED

Regional Engineer  
Department of Transportation

Date



## Municipal Estimate of Maintenance Costs



Submittal Type Original

Local Public Agency	County	Section Number	Beginning	Maintenance Period Ending
City of Lincoln	Logan	18-00000-00-GM	5/1/18	4/30/19

### Estimated Cost of Maintenance Operations

Maintenance Operation (No. and Description)	Maint. Eng. Group	Insp. Req.	For Group I, IIA, IIB or III				Est Total Operation Cost	
			Item	Unit	Quantity	Unit Price		Item Cost
1. Spot Patching	IIA	N	Bituminous Cold Mix	Ton	160	\$130.00	\$20,800.00	
			Bituminous Hot Mix	Ton	50	\$140.00	\$7,000.00	
			Labor	Hr	700	\$27.50	\$19,250.00	
			Equipment	Hr	700	\$26.00	\$18,200.00	\$65,250.00
2. Cleaning Inlets and Culverts	IIA		Labor	Hr	400	\$27.50	\$11,000.00	
			Equipment	Hr	400	\$26.00	\$10,400.00	\$21,400.00
3. Gutter Cleaning	IIA	N	Labor	Hr	1,500	\$27.50	\$41,250.00	
			Equipment	Hr	1,500	\$26.00	\$39,000.00	\$80,250.00
4. Snow and Ice Removal	IIA	N	Labor	Hr	1,250	\$27.50	\$34,375.00	
			Equipment	Hr	1,250	\$26.00	\$32,500.00	\$66,875.00
5. Traffic Signal Electrical Service	I	N	Electrical Energy	LSum	1	\$96,000.00	\$96,000.00	\$96,000.00
6. Sidewalk Replacement Program	IV	Y	Contract	LSum	1	\$125,000.00	\$125,000.00	\$125,000.00
7. Curb and Gutter and Sidewalk Replacement	IIA	N	Concrete	CY	175	\$110.00	\$19,250.00	
			Labor	Hr	80	\$27.50	\$2,200.00	
			Equipment	Hr	40	\$26.00	\$1,040.00	\$22,490.00
8. Spray Patching	IIA	N	Bit. Matl. Spray Patch	Gal	8,000	\$5.25	\$42,000.00	
			Spray Patch Aggregate	Ton	230	\$18.00	\$4,140.00	\$46,140.00
9. HMA Overlay Program	IV	Y	Contract	LSum	1	\$100,000.00	\$100,000.00	\$100,000.00
10. Snow Removal	I	N	Road Salt	Ton	350	\$110.00	\$38,500.00	\$38,500.00
11. Seal Coating and Scarification Program	IV	Y	Contract	LSum	1	\$400,000.00	\$400,000.00	\$400,000.00
<b>Total Estimated Maintenance Operation Cost</b>							<b>\$1,061,905.00</b>	

### Estimated Cost of Maintenance Engineering

Preliminary Engineering	\$38,548.10
Engineering Inspection	\$37,500.00
Material Testing	\$0.00
Advertising	\$0.00
Bridge Inspections	\$0.00
<b>Total Estimated Maintenance Engineering Cost</b>	<b>\$76,048.10</b>

### Maintenance Program Estimated Costs

	Estimated Cost	MFT Portion	Other Funds
Maint Oper	\$1,061,905.00	\$436,905.00	\$625,000.00
Maint Eng	\$76,048.10	\$76,048.10	\$0.00
<b>Totals</b>	<b>\$1,137,953.10</b>	<b>\$512,953.10</b>	<b>\$625,000.00</b>
<b>Total Estimated Maintenance Cost</b>			<b>\$1,137,953.10</b>

<b>Local Public Agency</b>	<b>County</b>	<b>Section Number</b>	<b>Maintenance Period</b>	
City of Lincoln	Logan	18-00000-00-GM	<b>Beginning</b> 5/1/18	<b>Ending</b> 4/30/19
<b>Submitted</b>		<b>Approved</b>		
<b>Municipal Official</b>	<b>Date</b>	Regional Engineer	<b>Date</b>	
		Department of Transportation		
<b>Title</b>				



Equipment Rental Schedule

Regional Engineer,  
Department of Transportation

County: Logan  
Road District: 6-Springfield  
Municipality: Lincoln

Springfield, Illinois:

Section: 18 - 00000 - 00 - GM

I hereby request approval of the use of MFT funds to pay rental for the equipment listed below at the rates shown. The equipment is owned by City of Lincoln, and is to be used on the above named section.

Rental Rates calculated using:  Schedule of Average Ownership Equipment Rental Expense  Blue Book  Other  
Multiplier Used: 1.359

Item of Equipment	Manufacturer	Model	Size	Year Built	Page No.	Rental Rate	Operator Rate	Total Rate
#1 Pickup	Chevrolet	pu/gas	half ton	2000	51	\$12.77		\$12.77
#2 Dump	International	dump/desl.	4900	1997	52	\$36.67		\$36.67
#2 Plow	Flink	Rev.			40	\$12.91		\$12.91
#3 Dump	Ford		1 Ton	2014	52	\$36.67		\$36.67
#4 Dump	Ford		1 Ton	2014	52	\$36.67		\$36.67
#4 Plow	Flink	Rev.			40	\$12.91		\$12.91
#5 Flat Bed	Chevrolet	flat/gas	3/4 Ton	2008	50	\$15.12		\$15.12
#5 Plow	Western	Rev.			40	\$12.91		\$12.91
#6 Dump	International	dump/desl.	4900	1993	52	\$36.67		\$36.67
#6 Plow	Flink	Rev.			40	\$12.91		\$12.91
#6 Spreader	Flink	PTO			43	\$8.02		\$8.02
#7 Dump	International	dump/desl.	7400	2008	52	\$36.67		\$36.67
#7 Plow	Flink	Rev.			40	\$12.91		\$12.91
#7 Spreader	Flink	PTO			43	\$8.02		\$8.02
#8 Dump	International	dump/desl.	4900	2008	52	\$36.67		\$36.67
#8 Plow	Flink	Rev.			40	\$12.91		\$12.91
#10 Dump	International	dump/desl.	4300	2010	52	\$36.67		\$36.67
#10 Plow	Henderson	Rev.			40	\$12.91		\$12.91
#10 Spreader	Henderson	PTO			43	\$8.02		\$8.02
#11 Utility	Ford	utility/desl	1 Ton	1997	51	\$12.77		\$12.77
#13 Bucket	GMC	bucket/desl	1Ton	1998	50	\$47.01		\$47.01
#14 Pickup	Chevrolet	pu/desl	3/4 Ton	2001	51	\$12.77		\$12.77
#14 Plow	Western	Rev.			40	\$12.91		\$12.91
#15 Flat Bed	GMC	flat/gas	1 Ton	1985	50	\$15.12		\$15.12
#16 Dump	International	dump/desl.	4900	2001	52	\$36.67		\$36.67
#16 Plow	Flink	Rev.			40	\$12.91		\$12.91
#17 Dump	International	dump/desl.		2001	52	\$36.67		\$36.67
#17 Plow	Flink	Rev.			40	\$12.91		\$12.91
#9 Bucket Tr.	Chevrolet	bukt/desl	K7900	2003	50	\$58.03		\$58.03
Pelican Sweeper	Elgin	series p		1998	44	\$61.90		\$61.90
Allianz sweeper	Johnson	mx450		2007	44	\$61.90		\$61.90
Wheel Loader	John Deere	524k		2012	46	\$51.99		\$51.99
Backhoe #1	John Deere	310sj		2008	46	\$47.33		\$47.33
Backhoe #2	John Deere	310e		1998	46	\$35.78		\$35.78
Motor Grader	Dresser	850		1992	21	\$60.89		\$60.89
Distributor	International	load starr		1974	14	\$25.94		\$25.94
Chip Spreader	Etnyre	k4684		1984	42	\$70.28		\$70.28
#1 Tractor/Mower	John Deere	5210		2000	22/45	\$27.36		\$27.36
#2 Tractor/Mower	Kioti	dk45s		2005	22/45	\$25.14		\$25.14
Air Compressor	Ingersoll Rand	175		1979	10	\$13.66		\$13.66
Asphalt Zipper		az480hd		2004	9	\$39.96		\$39.96
Tire Roller	Bros Roller	sp54		1959	34	\$31.37		\$31.37
Street Roller	Rex Roller	900		1978	34	\$40.34		\$40.34
Brush Chlpper	Brush Bandit	200x		1991	5	\$21.24		\$21.24
Skid Steer	Bobcat	S570		2004	46	\$24.72		\$24.72
Snow Blower					39	\$5.44		\$5.44
Street Broom					5	\$6.62		\$6.62
Spray Patcher	Total Patcher	Vortex		2015		\$44.70		\$44.70

Signature

Regional Engineer

Title of Official

Date



Local Agency City of Lincoln  
Section Number 18-00000-00-GM

The services to be performed by the consulting engineer, pertaining to the various items of work included in the estimated cost of maintenance operations (BLR 14231 or BLR 14221), shall consist of the following:

**PRELIMINARY ENGINEERING shall include:**

Investigation of the condition of the streets or highways for determination (in consultation with the local highway authority) of the maintenance operations to be included in the maintenance program: preparation of the maintenance resolution, maintenance estimate of cost and, if applicable, proposal; attendance at meetings of the governing body as may reasonably be required; attendance at public letting; preparation of the contract and/or acceptance of BLR 12330 form. The maintenance expenditure statement must be submitted to IDOT within 3 months of the end of the maintenance period.

**ENGINEERING INSPECTION shall include:**

Furnishing the engineering field inspection, including preparation of payment estimate for contract, material proposal and/or deliver and install proposal and/or checking material invoices of those maintenance operations requiring engineering field inspection, as opposed to those routine maintenance operations as described in Chapter 14-2.04 of BLRS Manual, which may or may not require engineering inspection.

For furnishing preliminary engineering, the engineer will be paid a base fee PLUS a negotiated fee percentage. For furnishing engineering inspection the engineer will be paid a negotiated fee percentage. The negotiated preliminary engineering fee percentage for each group shown in the "Schedule of Fees" shall be applied to the total estimated costs of that group. The negotiated fee for engineering inspection for each group shall be applied to the total final cost of that group for the items which required engineering inspection. In no case shall this be construed to include supervision of contractor operations.

**SCHEDULE OF FEES**

Total of the Maintenance Operation	Base Fee
<input checked="" type="checkbox"/> > \$20,000	\$1,250.00
<input type="checkbox"/> ≤ \$20,000 (Negotiated: \$1,250 Max.)	

**PLUS**

Group	Preliminary Engineering		Engineering Inspection		Operation to be Inspected
	Acceptable Fee %	Negotiated Fee %	Acceptable Fee %	Negotiated Fee %	
I	NA	NA	NA	NA	NA
IIA	2%	(\$6,048.10)	1%	(\$0.00)	
IIB	3%	(\$0.00)	3%	(\$0.00)	
III	4%	(\$0.00)	4%	(\$0.00)	
IV	5%	(\$31,250.00)	6%	(\$37,500.00)	#6 9 11

By: \_\_\_\_\_  
Local Agency Official Signature

Mayor  
Title

5/7/2018  
Date

By: \_\_\_\_\_  
Consulting Engineer Signature

Engineering Manager  
Title

5/7/2018  
Date

\_\_\_\_\_  
P.E. Seal

\_\_\_\_\_  
P.E. License  
Expiration Date

## MEMORANDUM

**TO:** Mayor and Aldermen of the City of Lincoln

**FROM:** Walt Landers, Street Superintendent

**MEETING**

**DATE:** April 23, 2018

**RE:** New End Loader and Backhoe Lease

---

### Background

The Lease on the 2013 John Deere 524K End Loader will mature June 14, 2018. This 5 year lease was based on 500 hours per year usage and was covered by an extended full machine 2500 hour or 60 months compressive coverage.

The annual payment was \$8586.88. The city has the option to purchase the machine at the end of the lease for \$81,300.00 and a buy back option in the amount of \$86,000.00. This machine currently has 1550 operating hours.

The departments current Backhoe is a John Deere 2008 SJ 310. This machine has approximately 5300 operating hours. This piece of equipment is probably the most utilized machine that we have and is used for many of our day to day operations. We have 2 other attachments for this machine, a 1yard grapple Bucket and a set of unloading/loading forks.

Over the past 2 years the repair issues have become more prevalent. It currently has a reoccurring issue with the fuel system that staff and service technicians from John Deere still haven't resolved completely. John Deere has offered a trade in value of \$26,000.00

### Analysis/Discussion

The new machines to consider are a 2018 John Deere 524KBT End Loader and a 2018 John Deere 310HLT Backhoe

A new lease would also be through John Deere Financial as the previous lease. Both machines for 5 years would have an annual payment of \$22,266.42. The end loader at \$12,739.63 and backhoe at \$9526.79. The lease would be based on 1000 operating hours per year and both units would be protected by a John Deere extended full machine 60 month/2500 hours comprehensive warranty. There are service contracts available but I believe the additional cost isn't necessary and the warranty is sufficient. At the end of the lease the city would have the option to purchase the end loader for \$80,000.00 and the backhoe would be \$45,000.00. John Deere. John Deere Financial has agreed to prorate the previous annual payment to monthly payment until the new equipment is received.

Martin Equipment from Springfield IL. The company that has provided these quotes and we would be leasing these machines through this dealer. Both of the previous machines were leased or purchased from them. Martin Equipment has been awarded a contract for this equipment through the Joint Purchasing Program through the Central Management Services Division of State of Illinois.

**Fiscal Impact**

The annual Payment of \$22,266.42, for 5 years.

**COW Recommendation**

Place on the May 7, 2018 City Council meeting agenda the lease of the new John Deere End Loader and Backhoe.

**Council Recommendation:**

Approve the lease for New John Deere End Loader and Backhoe.





Martin Equipment  
 2384 J. David Jones Parkway  
 Springfield, IL 62707  
 (217) 528-4347

**Quote Issued To : CITY OF LINCOLN**  
 313 LIMIT STREET  
 LINCOLN , IL , 62656  
 217-735-2815

**QUOTATION**

**Quote # : 2005266**  
**Issue Date : 3/2/2018**  
**Expire Date : 3/17/2018**  
**Est Delivery : 5/16/2018**  
**FOB : Lincoln**

**Quote Issued By : Ackerman, Keith**

**ITEMS LISTED FOR SALE**

Item #	Year	Make	Model	Serial #	Hours	List Price	Sale Price
	2018	JD	524KBT	(TBD)	0	222,044.00	123,352.00

524K-II LOADER  
 Standard Gathering Group  
 English Labels and Decals  
 John Deere PowerTech Engine  
 Standard Fan Drive  
 Air Intake system without Precleaner Engine  
 Engine Exhaust with Flat Black Curved Stack  
 Standard Fuel Filter & Water Separator  
 130 amp Alternator  
 24 Volt to 12 Volt - 6 Amp Converter  
 Halogen Work and Drive Lights  
 No Payload Scale  
 Transmission  
 Front Hydraulically Locking Differential and Rear Conventional Differential Axles  
 Manual Axle Differential Lock  
 Rear Cast Bumper/Counterweight with Rear Hitch and Locking Pin  
 No Brand Preference  
 Front Fenders  
 Standard Z-BAR  
 3 Function -- Joystick with FNR and 3rd Function Auxiliary Control Lever  
 Ride Control  
 ROPS Quiet Cab with Air Conditioning  
 Left Side Steps  
 Cab with Air A/C Charge  
 Standard Fabric, Back Rest Extension, Air Suspension Seat  
 Heated Outside Mirrors  
 Steering Wheel Only  
 Greased Steering Cylinder Joints  
 JDLink Ultimate Cellular - 5 Years  
 Standard Loader  
 Environmental Drains and Sampling Ports  
 Transmission Side Frame Guards  
 20.5R25 1 STAR L2 NO BRAND PREFERRED RADIAL TIRES WITH 3 PC RIMS  
 Rear Camera Only  
 5.0 lbs. multi purpose (ABC) Dry Chemical Fire Extinguisher  
 AM/FM/Weather Band (WB) Radio with Remote AUX Port  
 Z-BAR Hydraulic Attachment Coupler  
 2.75 Cu. Yd. (2.1 Cu. M.) 100 In. Wide GP Coupler Bucket with Bolt-on Cutting Edge  
 Shgle Beacon Bracket

**Total: 123,352.00**

**ADDITIONAL ITEMS**

Description	Taxable	Price	Tax	Total
4-corner strobe light kit included		0.00	0	0.00
60 months 2,500 hours full comprehensive coverage included		0.00	0	0.00
oil sampling kit included		0.00	0	0.00
<b>Total of Additional Items :</b>	<b>0.00</b>			

**Notes**

Dear committee and council members

Martin Equipment is proposing a five year annual lease with payments based in arrears and based off of up to 1,000 hours/year

This unit is also protected by John Deere extended full machine 2,500 hours comprehensive coverage.

Payments in the amount of \$12,739.63 per year for five years.

There is a balloon payment option to purchase at the end of five years as well in the amount of \$80,000.00

Martin Equipment was the successful low bidder to the state of Illinois of the 524K wheel loader

**QUOTE SUMMARY**

<b>Total Sale Price :</b>	<b>123,352.00</b>
<b>Less Trade Allowance :</b>	<b>0.00</b>
<b>Additional Taxable Items :</b>	<b>0.00</b>
<b>Subtotal:</b>	<b>123,352.00</b>
<b>Sales Tax :</b>	<b>0.00</b>
<b>Additional Nontaxable Items :</b>	<b>0.00</b>
<b>Total :</b>	<b>123,352.00</b>

**Acceptance Signature:** \_\_\_\_\_

**Date:** \_\_\_\_\_

All quotations contingent upon strikes, delays, and conditions beyond our control. Prices subject to change with or without notice.  
All prices are subject to expiration of any current sales programs and incentives.



Martin Equipment  
 2384 J. David Jones Parkway  
 Springfield, IL 62707  
 (217) 528-4347

**Quote Issued To : CITY OF LINCOLN**  
 313 LIMIT STREET  
 LINCOLN , IL , 62656  
 217-735-2815

**QUOTATION**

**Quote # : 2005276**  
**Issue Date : 3/2/2018**  
**Expire Date : 3/23/2018**  
**Est Delivery : 5/22/2018**  
**FOB : Lincoln**

**Quote Issued By : Ackerman, Keith**

**ITEMS LISTED FOR SALE**

Item #	Year	Make	Model	Serial #	Hours	List Price	Sale Price
	2018	JD	310HLT	(TBD)	0	190,907.00	102,800.00

**310SL HL BACKHOE LOADER**  
 JDLink Ultimate Cellular - 5 Years  
 English Decals with English Operator and Safety Manuals  
 Mechanical Front Wheel Drive (MFWD) with Limited Slip Differential  
 Galaxy 21L 24 in. 12 PR Rear & 12.5/80-18 10PR Front  
 Cab  
 Dual Maintenance Free Batteries With Disconnect and Jump Post  
 Extendible Dipperstick  
 Auxiliary Hydraulic with One & Two Way Flow (Hammer & Thumb/Swinger)  
 Pilot Controls, Two Lever, with Pattern Selection  
 Multi-Brand Quick Coupler  
 24" (610 mm) Wide, Heavy-Duty, 8.8 Cu. Ft. (0.25 Cu. M.) Capacity Bucket  
 Loader Coupler, 3-Function Hydraulics, Single Lever  
 1.32 Cu. Yd.(1.0 Cu. M.), 92 in.(234 mm) wide Multipurpose Coupler Bucket  
 780 Lb. (340 kg) Front Counterweight  
 John Deere PowerTech Plus 4.5L (276 Cu. In.) Engine Meets Final Tier 4 and Stage IV  
 Emissions  
 Front View Mirror  
 Left Side Console Storage with Cup Holders  
 Radio, Bosch Basic Package  
 Sun Visor  
 Seat, Cloth Air-Suspension  
 42 Inch Hydraulic Backhoe Thumb - 4 Tine  
 Chrome Exhaust Extension  
 Engine Coolant Heater  
 Diagnostic Oil Sampling Ports

**Total: 102,800.00**

**TRADE ALLOWANCES**

TIV #	Year	Make	Model	Serial #	Trade Allowance
T0310S3171074	2008	JOHN DEERE	310S3	T0310S3171074	26000.00
<b>Total Trade Allowances :</b>					<b>26,000.00</b>

**ADDITIONAL ITEMS**

Description	Taxable	Price	Tax	Total
60 months 2,500 hours full comprehensive coverage included		0.00	0	0.00
4-corner strobe light kit included		0.00	0	0.00
oil sampling kit included		0.00	0	0.00
<b>Total of Additional Items :</b>	<b>0.00</b>			

## Notes

Dear committee and council members,

Martin Equipment is proposing a five year annual lease with payments based in arrears and based off of up to 1,000 hours/year

This unit is also protected by John Deere extended full machine 2,500 hours/five years comprehensive coverage.

Payments in the amount of \$ 9,526.79/year for five years

Martin Equipment was the successful low bidder to the state of Illinois on the 310SL HL backhoe

There is a balloon payment option to purchase at the end of five years as well in the amount of \$45,000.00

### QUOTE SUMMARY

<b>Total Sale Price :</b>	<b>102,800.00</b>
<b>Less Trade Allowance :</b>	<b>26,000.00</b>
<b>Additional Taxable Items :</b>	<b>0.00</b>
<hr/>	
<b>Subtotal:</b>	<b>76,800.00</b>
<b>Sales Tax :</b>	<b>0.00</b>
<b>Additional Nontaxable Items :</b>	<b>0.00</b>
<hr/>	
<b>Total :</b>	<b>76,800.00</b>

**Acceptance Signature:** \_\_\_\_\_

**Date:** \_\_\_\_\_

All quotations contingent upon strikes, delays, and conditions beyond our control. Prices subject to change with or without notice.

All prices are subject to expiration of any current sales programs and incentives.

## AGREEMENT

This AGREEMENT made and entered into this 1<sup>st</sup> day of June, 2018, by and between Logan County, a body corporate and politic, existing by and under the laws of the State of Illinois, (hereinafter referred to as the "County"), and City of **LINCOLN**, a municipal corporation, existing by and under the laws of the State of Illinois, (hereinafter referred to as the "City"),

WITNESSETH:

WHEREAS, the County is authorized under the Illinois Animal Control Act to provide certain animal control services and to enter into agreements regarding the provision of said services, and

WHEREAS, the City of Lincoln, pursuant to the Cities and Villages Act, Chapter 65, paragraph 5/11-20-9, Illinois Compiled Statutes, is authorized to regulate and prohibit the running-at-large of animals within the City limits of Lincoln, Illinois, and

WHEREAS, the City of Lincoln has passed certain ordinances which prohibit the running-at-large of certain animals within its jurisdiction and has made other provisions to promote the health, welfare and safety of humans and animals within said jurisdiction, and

WHEREAS, the City and County wish to enter into a contractual relationship providing for certain animal control and animal shelter services within the County of Logan and municipality of Lincoln.

NOW, THEREFORE, for and in consideration of the mutual covenants and undertakings hereinafter set forth, and for other good and valuable consideration, the sufficiency of which is hereby acknowledged, the Parties do mutually agree as follows:

1. **TERM** This Agreement shall commence at 12:01 P.M. on June 1<sup>st</sup>, 2018, and shall terminate at 11:59 A.M. May 31, 2019 unless otherwise terminated or extended.

2. **COMPENSATION TO LOGAN COUNTY** The City agrees to pay the County for the services hereinafter set forth, the sum of \$42,000.00 for a 12 month period from June 1<sup>st</sup>, 2018 through May 31, 2019. All payments shall be made in equal monthly installments and such payments shall commence on or before the 15<sup>th</sup> of June, 2018 and shall continue on the 15<sup>th</sup> day of each month

thereafter. The monthly payment shall be \$3,500.00. All payments shall be made to the Logan County Treasurer, P.O. Box 400, Lincoln, Illinois 62656 and deposited to the County's Animal Control Fund.

### **3. SERVICES TO BE PROVIDED BY COUNTY**

- a. **Animal Shelter and Pound** Logan County will furnish, operate and maintain an animal shelter and pound for lost, strayed, captured, surrendered or homeless dogs and cats in Logan County. The shelter shall be operated and maintained according to regulations of the Illinois Department of Agriculture. Logan County will provide humane treatment for all animals in its care and custody; provided that Logan County, under the direction of the Administrator of the Animal Control Ordinance (hereinafter referred to as Administrator), shall humanely dispose of such animals as provided by statute, regulation or ordinance. Logan County shall keep accurate records of all animals taken into its custody and impounded and shall record the final disposition made of an impounded animal.
- b. **Administration of Shelter** Logan County will maintain reasonable office hours at the shelter for the convenience of the public and for the purpose of transacting business in connection with its duties under this Agreement, such as for reception of captured or surrendered animals and for transacting business relating to the redemption or adoption of impounded animals.
- c. **Employment of Personnel** Logan County shall employ individuals to carry out its duties under this Agreement. Logan County shall thoroughly familiarize such personnel with all applicable statutes, rules, regulations and ordinances pertaining to animal control within Logan County.
- d. **Enforcement of Animal Control Laws** Logan County shall certify to the Administrator one or more of its employees as being trained and competent to assume the duties of the Animal Control Warden. The Administrator shall appoint such employees as Animal Control Wardens to enforce all applicable statutes, regulations, City ordinances and County ordinances relating to animal control and to capture and impound dogs found running-at-large within the City. Animal Control agrees to respond 24 hours a day to barking

dogs, dogs running-at-large, bite cases and injured dogs or cats. Animal Control will maintain reasonable hours for reclaims, adoptions and other non-emergency needs. The Animal Control Wardens shall be employees of, and be compensated by, Logan County.

e. **Cooperation with Other Departments** Logan County will cooperate with personnel of City of Lincoln Police Department, Logan County Sheriff's Office and Logan County Health Department in investigating complaints for violation of animal control and animal welfare laws and ordinances and shall respond directly and investigate citizen complaints of violations of such laws and ordinances. When warranted, Logan County shall prepare and transmit investigative reports of violations to the State's Attorney of Logan County for his review and the filing of charges or actions if appropriate. If charges or actions are filed by the State's Attorney, Logan County and the City of Lincoln will cooperate fully in the prosecution of the same. The City Attorney, however, will prosecute actions under the City Leash Ordinances and all such fines and penalties collected shall be retained by the City.

f. **Issuance of Dog Registrations, Collection of Fees, Maintenance** Under the supervision of the Administrator, Logan County shall issue dog and cat registration tags for all dogs and cats required to be registered in Logan County, and shall collect and retain all registration fees. In addition, Logan County shall collect and retain all required rabies inoculation, housing, neutering and adoption fees. Logan County shall keep complete and accurate records of the issuance of registration tags and the receipt of all fees and charges enumerated above.

4. **INSURANCE** The County of Logan, at its own cost and expense, shall carry insurance for the benefit of and to protect itself against all claims, demands, causes of action or judgments and from all expenses that may be incurred in investigating or resisting the same stemming from the performance of its duties described above. The City shall be responsible for obtaining and paying for any insurance it may feel is appropriate.



5. AGREEMENT NOT ASSIGNABLE Neither party may sell, mortgage or assign this Agreement, or the powers granted to it, or any interest therein.

6. ENTIRE AGREEMENT This Agreement contains the entire understanding of the Parties and no warranties, representations, covenants, or agreements have been made with respect to the subject matter of this Agreement except as stated in this Agreement. This Agreement may not be amended or modified except in writing and signed by the Parties.

This Agreement entered into the day and year first set forth above pursuant to authority given by the respective governing bodies of both the County and the City.

**City of Lincoln, Illinois**

By: \_\_\_\_\_  
Mayor

ATTEST: \_\_\_\_\_ (SEAL) \_\_\_\_\_  
City Clerk Date

**County of Logan, Illinois**

By: \_\_\_\_\_  
Chairman, Logan County Board

ATTEST: \_\_\_\_\_ (SEAL) \_\_\_\_\_  
Logan County Clerk Date

## WATER USAGE DATA AGREEMENT

This WATER USAGE DATA AGREEMENT (the "Agreement") is made and entered into as of the \_\_\_\_ day of \_\_\_\_\_, 2018 (the "Effective Date"), by and between Illinois-American Water Company, an Illinois corporation (hereinafter "IAWC" or the "Company"), and the City of \_\_\_\_\_, an Illinois municipal corporation (hereinafter the "City").

### RECITALS:

WHEREAS, IAWC provides water service to customers in \_\_\_\_\_, Illinois, and through meter readings and estimates collects certain water usage and customer identification information for its billing purposes; and

WHEREAS, the City provides sanitary sewer service to certain customers in \_\_\_\_\_, Illinois, and has established charges for such service based upon customer water usage; and

WHEREAS, the City has requested that IAWC provide certain water usage and customer identification information that the City requires to compute and collect its sewer charges; and

WHEREAS, IAWC is willing to provide usage information in exchange for payment by the City; and

WHEREAS, IAWC is a public utility regulated by the Illinois Commerce Commission (hereinafter "Commission"); and

WHEREAS, IAWC and the City desire to enter into an agreement containing specific terms and conditions of providing the water usage and customer identification data.

NOW THEREFORE, in consideration of the mutual agreements and covenants set forth below, and other good and valuable consideration, the receipt and sufficiency of which are hereby acknowledged, IAWC and the City agree as follows:

### 1. DATA TO BE PROVIDED.

A. IAWC agrees to make available to the City water usage data, which is collected monthly in IAWC's ordinary course of business through meter readings or lawful estimates, relative to each of IAWC's customers in the City who are also sewer customers of the City. Each such customer's water usage will be ascertained from readings obtained by some combination of either actual meter readings, postcard readings mailed in from customers, telephone readings called in by customers, or estimated readings by IAWC personnel when the foregoing are unavailable. The water usage data will cover a period of approximately 30 days for monthly-billed customers.

B. The water usage and customer identification data (hereinafter referred to as the "Data") shall be made available to the City by IAWC on a weekly basis, and shall include the following Data:

- I. Transaction information, including reading, usage and adjustment information for each customer account, as follows:
  - a. Whether the reading is an actual reading or an estimate (estimates shall include office estimates performed by IAWC and reads provided by the customer);
  - b. Usage adjustment(s) with appropriate code(s) (if applicable);
  - c. Cancel read (if applicable);
  - d. Closing bill (if applicable);
  - e. The reading, which shall contain at a minimum:
    - (i) The reading date;
    - (ii) Days of duration;
    - (iii) Usage amount;
    - (iv) Reading frequency (bi-monthly, quarterly, monthly);
    - (v) Unit of measure (gallons, hundred gallons, hundred cubic feet, thousand gallons);
    - (vi) Negative and positive indicator on usage; and
    - (vii) Transaction number for each record.
- II. Account and premise change information, including customer, service address and status information, as follows:
  - a. Account name and mailing address (including address, the city, state and zip code);
  - b. Premise address (i.e. the service address);
  - c. Status of account;
  - d. Status of premise; and
  - e. Account/premise change date (if applicable).
- III. Opening and closing service records, including information concerning the status of the service at the premise address, as follows:
  - a. New premise;
  - b. Inactivated premise; and/or
  - c. Killed premise.

C. Because a City customer and an IAWC customer at a specific address may be different individuals or entities, it will be the City's responsibility to discern from the Data the appropriate customer identification information for the City's purposes. The City shall identify for IAWC which of IAWC's customers in the City are also customers of the City, and IAWC will not be responsible for determining which of its customers are also the City's customers. In addition, IAWC does not make any representations,

warranties, or guarantees to the City as to the accuracy, completeness or fitness for a particular purpose of the Data, and the City covenants not to sue IAWC for claims that the data provided by IAWC was inaccurate, incomplete, incorrect, or not fit for the City's billing purposes.

D. As of the date the City makes its first invoice payment pursuant to Paragraph 4, the City may retrieve the above Data via a secure website maintained by IAWC and all customer records made available to the City are referenced by IAWC account number and premise number. To the extent IAWC intends to change the manner by which the Data will be made available to the City or to change the manner in which IAWC references customer records, it shall provide the City with no less than ninety (90) days' advanced notice, per the notice provision set forth in paragraph 14 below.

2. CONFIDENTIALITY. The City agrees that the Data it obtains shall be used only for the purpose of computing and collecting its sewer charges, and that it shall limit the disclosure of the Data to only those officers, employees, and agents who need the Data for such purpose. The City agrees to keep the Data confidential and shall not disclose, provide or sell the Data to any third party, firm, corporation or entity, except as required by law or as otherwise provided herein.

3. INAPPLICABLE PSC NOTICE REQUIREMENTS. All notice and complaint procedures specified in 83 Ill. Adm. 280, 220 ILCS 5/ and Company tariffs and rules that apply to customer rights to utility service from a regulated utility, shall not apply to action or inaction by IAWC pursuant to the Agreement or IAWC's election to enter into this Agreement. All notice, complaint procedures and administrative consumer remedies, to the extent that they may exist or be alleged to exist, shall be the responsibility of the City.

4. FEES. The City will pay a fee of Eight and Thirty-Three One Hundredths Cents (\$0.0833) per month for each customer of IAWC that is also a customer of the City, which amount shall be paid by the City within 30 days of receipt of an invoice therefor from IAWC. IAWC shall invoice the City on a monthly basis. IAWC may increase the fee for each unit of Data provided to the City based on increased costs to provide the Data effective the beginning of the next calendar year, so long as written notice of the new fee is provided to the City at least 90 days prior to the end of the preceding calendar year. Should the City fail to pay any amounts due under the terms of this Agreement, IAWC's obligations to deliver the Data under this Agreement shall cease until such amounts are paid in full.

5. COMMISSION REVIEW. To the extent that this Agreement becomes the subject of any regulatory proceeding before the Commission and the Commission produces a determination that alters the terms or fees set forth in this Agreement, impacts the Company's

authorized revenues (i.e., imputes revenues to the Company), or is otherwise inconsistent with the Company's expected rate-making treatment, either party may terminate the Agreement with notice to the other party, or the parties may agree to amend the Agreement consistent with any Commission directive or order.

6. INDEMNIFICATION. To the extent allowed by law, the City agrees to indemnify, defend and hold harmless IAWC, its parents, subsidiaries, affiliated and related corporations, companies, partnerships and entities and/or their former, present, and future partners, directors, managers, officers, employees, attorneys, agents, representatives, successors and/or assigns from and against any and all claims, complaints or causes of action asserted by the City customers and/or other third parties concerning the Data that IAWC has made available to the City in accordance with this Agreement including, but not limited to, claims that sewer bills were based on estimates that do not reflect actual usage, and claims that the data provided by IAWC was inaccurate, incomplete, incorrect, or not fit for the City's billing purposes. The indemnification provision will survive the termination of this Agreement with respect to any actions taken during the time the Agreement was in effect.

7. CUSTOMER COMMUNICATIONS. The City shall handle all customer communications regarding the implementation of this Agreement by the City, or any actions that are taken pursuant to this Agreement by the City. Communications from customers to IAWC regarding the City billings will be referred and directed to the City, but IAWC will respond to reasonable requests for information from the City to assist the City in the handling of specific customer issues from time to time.

8. FORCE MAJEURE AND CONFLICTING REQUIREMENTS. IAWC's actions required under this Agreement shall be excused due to matters beyond its control, including but not limited to employee work stoppages, strikes, inclement weather, or emergencies requiring utilization of manpower of resources elsewhere. In addition, the aforementioned information will cease to be provided if a court of competent jurisdiction or other governmental entity having jurisdiction issues an order to IAWC so requiring.

9. EXPIRATION OR TERMINATION. This Agreement shall be for a term of one year from the Effective Date. Thereafter, it will continue from year to year unless terminated by either of the parties giving thirty (30) days' written notice to the other party as set forth in Paragraph 14 below.

10. SUCCESSORS AND ASSIGNS. IAWC and the City agree that this Agreement shall be binding upon and inure to benefit of their respective successors and assigns.

11. ENTIRE AGREEMENT. This Agreement sets forth the entire understanding between the parties and fully supersedes any prior agreements or understanding between the parties relating to the subject matter set forth herein.

12. AMENDMENT. Neither this Agreement, nor any term hereof may be amended, changed, modified, altered or waived except in writing executed by both the City and IAWC or by an order or directive of the Commission as set forth in Paragraph 5 above.

13. AUTHORITY OF PARTIES. Each party and signatory hereto has the authority to enter into this Agreement and at all times has full authority to perform this Agreement. No further approval or consent by any other person or authority is required. Upon execution of the Agreement, the City shall designate a representative to whom all inquiries from IAWC should be directed and decisions of that individual shall be final and binding on the City.

14. NOTICES. All notices and other communications between IAWC and the City concerning this Agreement (collectively, "Notices") shall be given in writing to the addresses set forth below:

IAWC: Michael Smyth, Vice-President of Operations  
Illinois-American Water Company  
100 N. Water Works Drive  
Belleville, Illinois 62223

With Copy to: Legal Department  
Illinois-American Water Company  
100 N. Water Works Drive  
Belleville, Illinois 62223

The City: \_\_\_\_\_  
\_\_\_\_\_  
\_\_\_\_\_

15. CONSTRUCTION. The headings or captions in this Agreement are solely for convenience of reference and shall be given no effect in the construction or interpretation of this Agreement.

16. GOVERNING LAW. To the extent a dispute arises between IAWC and the City involving enforcement of this Agreement, such dispute shall be governed by the laws of the State of Illinois applicable to contracts made and performed entirely in Illinois, without regard to any principles of conflicts of law.

17. INCORPORATION OF RECITALS. The Recitals are hereby incorporated into this Agreement.

18. COUNTERPARTS. This Agreement may be executed in counterparts, including facsimile or photocopy counterparts, each of which shall be deemed an original, but all of which taken together shall constitute a single document.

IN WITNESS WHEREOF, the parties hereto have executed this Agreement as of the day and year first above written.

ILLINOIS-AMERICAN WATER COMPANY

By: \_\_\_\_\_  
Michael Smyth, Vice-President of Operations

[CITY], ILLINOIS

By: \_\_\_\_\_  
\_\_\_\_\_

ATTEST:

\_\_\_\_\_