

**CITY OF LINCOLN**  
**REGULAR CITY COUNCIL MEETING**  
**AGENDA**  
**OCTOBER 18, 2021**  
**7:00 PM**

1. **Call to Order**
2. **Roll Call**
3. **Pledge of Allegiance**
4. **Public Participation**
5. **Consent Agenda By Omnibus Vote**

All items under the Consent Agenda are considered to be routine in nature and/or non-controversial and will be approved by one motion. If any one wishes to have a separate vote on any item, it will be pulled from the Consent Agenda and voted on separately.

- A. Payment of Bills
- B. Approval of minutes September 14, 2021 Committee of the Whole Meeting.
- C. Approval of request from the Logan County Tourism Bureau to us various city streets and place barricades at various street intersections for the 2021 Christmas Cruise on Thursday, December 2, 2021 from 5:30 p.m. until its conclusion.
- D. Approval of request from the Logan County Tourism Bureau to permit the use of Pulaski Street, McLean Street, Broadway Street, and Kickapoo Street on Friday, November 26, 2021, Saturday, November 27, 2021, Friday, December 3, 2021, Saturday, December 4, 2021, Friday, December 10, 2021, Friday, December 17, 2021, and Saturday, December 18, 2021 from 5:00 p.m. until 8:00 p.m. on Fridays night and 12:00 pm until 3:00 pm on Saturday afternoons for Carriage Rides on the Courthouse Square.
- E. Request from Lincoln Church of God to close the 200 Block of South McLean Street on Saturday, October 30, 2021 from 8:00 a.m. until 1:00 p.m. for family fun day.
- F. Approval of Trick or Treat with the Mayor on Saturday, October 30, 2021 from 10:00 a.m. until 1:00 p.m.
- G. Approval of Trick or Treat Hours on Sunday, October 31, 2021 from 5:00 p.m. until 8:00 p.m.
6. **Ordinances and Resolutions.**
7. **Bids**
8. **Reports**
  - A. City Treasurer's Report for September, 2021
  - B. City Clerks Report for September, 2021
  - C. Department Head Reports for September, 2021
9. **New Business/Communications**
  - A. Approval of Pay Application No. 14 from Plocher Construction Co. for CSO Improvements in an amount not to exceed \$604,024.13.
  - B. Advise & Consent to the Mayoral appointment of Deputy Chief Matt Vlahovich as Chief of Police, effective November 1, 2021.
  - C. Approval of the expenditure of an additional \$5,000.00 in contingency funds for the Sidewalk Replacement Project for F.Y. 2021-2022.
  - D. Approval of the expenditure for materials for a 9mm liner for the Chicago Street lining at an additional cost not to exceed \$23,185.09.
  - E. Approval of Contract Extension Proposal from Area Disposal, a subsidiary of GFL Environment, Inc., for residential refuse and recycling collection from March 1, 2022 through February 28, 2027.
10. **Announcements**
12. **Possible Executive Session**
13. **Adjournment**

We welcome the participation of persons with disabilities at all City of Lincoln meetings. If auxiliary aid or service is required for most effective participation and communication, please notify the City Clerk's Office at 217-735-2815 or [cityclerk@lincoln.il.gov](mailto:cityclerk@lincoln.il.gov) no later than 48 hours prior to the meeting time.

## **COMMITTEE OF THE WHOLE MEETING**

Lincoln City Hall, Council Chambers  
700 Broadway Street | Lincoln, Illinois

**Tuesday, September 14, 2021**

The Committee of the Whole Meeting of the City Council of Lincoln was called to order by Mayor Tracy Welch at 7:04 p.m., with proper notice given. City Clerk Peggy Bateman called roll.

### **Present:**

Alderman Steve Parrott, Ward 1  
Alderman Greg Miller, Ward 1  
Alderman Ron Fleshman, Ward 2  
Alderman Sam Downs, Ward 2  
Alderman Kevin Bateman, Ward 3  
Alderwoman Wanda Lee Rohlf, Ward 3  
Alderwoman Kathy Horn, Ward 4  
Alderman Rick Hoefle, Ward 4

### **Staff Present:**

Peggy Bateman, City Clerk  
Chuck Conzo, City Treasurer

### **Remotely:**

John Hoblit, City Attorney  
Bob Dunovsky, Fire Chief  
Matt Vhalovich, Deputy Police Chief  
Walt Landers, Streets Superintendent  
Wes Woodhall, Building and Safety Officer  
Andrew Bowns, Veolia Water, Project Manager

### **Absent:**

Paul Adams, Police Chief

### **Presiding:**

Mayor Tracy Welch

---

### **Public Comment:**

There is no one present for public comment.

### ***Christy Crites from CMT gave updates on items 4-8***

**Crawford, Murphy & Tilley invoice for Lincoln Phosphorus Removal Feasibility Plan and Optimization Plan for the Waste Water Treatment Plant in the amount of \$7,765.00**

This item will be placed on the regular agenda.

**Crawford, Murphy & Tilley invoice for the CSO Improvement Construction Phase in the amount of \$29,443.52**

Standard monthly fee for the project. Completion is anticipated to be done by end of year. This item will be placed on the regular agenda.

**Crawford, Murphy & Tilley invoice for the Union Street Pump Station in the amount of \$14,865.68**  
L. Keeley is anticipating being done in October. There is one more round of pavement restoration. This item will be placed on the regular agenda.

**Plocher Construction Pay Application #13 for the CSO Project in the amount of \$471,306.11**  
Working on replacing mechanisms on the final two clarifiers. Working on bringing up the new headworks building. These are the last two major components that had not been started. Would also like to be wrapped up by the end of the year. Concrete is also being poured across the bridge. This item will be placed on the regular agenda.

**L. Keeley Construction Pay Application #6 for the Union Street Pump Station in the amount of \$627,313.13**

This is for the paving restorations done last month and for the continued efforts at the Union Street Pump Stations. This also includes the additional lateral tie ends.

With 30% principal forgiveness, the approx. total spent overall is around \$12.5 million.

This item will be placed on the regular agenda.

**Becky Strait and Don Peasley with Lincoln Park District - Request of ownerships of City Parks to the Lincoln Park Districts. City Parks consist of 8th Street Lot, Allison Park, Melrose Park, Ray White Park, Postville Park**

Becky Strait displayed a slideshow of the Park Districts history and current and future plans.

There is some public confusion as to who is responsible for what parks in Lincoln and also liability.

If the Park District owns the parks, they have the ability to apply for grants and match the taxpayer funds, dollar for dollar, they plan to invest in projects with grant funds. This would also free up city funds for other projects.

Ms. Strait also went over community surveys the park district had done in the past.

72% of responses said that playground equipment is outdated and needs to be replaced.

90% of responses chose outdoor use as a preferred pastime. The top reason people do not participate in recreational activities is lack of money. The top reasons people travel out of town for activities is for a splash pad, dog parks and skate parks. 99% of responses would maybe or definitely support the transfer of ownership.

According to Ms. Strait property taxes will not increase with transfer of ownership. The park district already has their tax base funded for capital projects through property taxes.

Projects will not only be completed if grants are approved.

The park district code makes it almost impossible for the park district to sell the parks, and they would not want to.

Alderman Bateman would like to transfer ownership of one park to the Park District and see how it is developed. He'd like to start with the empty lot on 8<sup>th</sup> St.

Alderman Hoefle suggested leasing the parks to the Park District. Ms. Strait and Mr. Peasley would need to check with their board to see if leasing would meet the parameters of the grants.

Alderman Downs suggested entering an intergovernmental agreement stating the parks revert back to the City should the park district not get them updated by a certain time.

Mayor Welch will assign two Alderman to work with the park district on an agreement and will be brought back to a later COW.

**Bid opening- Lot 127 and the East Half of Lot 128, in the Plat of Lincoln Hill, now a part of the City of Lincoln, Logan County, Illinois. Tax I.D. No. 12-35-128-00, known as 618 4th Street.**  
One bid was received, for this property, by the Clerk's office on Aug 30<sup>th</sup>, 2021 at 10:45am. Mayor Welch opened the sealed bid. The bid came from Darrell VanCleve and Darrell Clutter for \$900. This item will be placed on the regular agenda.

**Mayoral appointment of Alderman Greg Miller to the Economic Development Commission**  
This item will be placed on the regular agenda.

**Request to Permit: LCHS Football Boosters and Parents permission to white wash Wyatt Ave. and Primm Road for Homecoming on September 30, 2021 and decorate Wyatt Ave Island for Homecoming.**

Superintendent Landers wanted the Council to be aware that Wyatt Ave will be newly resurfaced. He also wants to make sure the decorations are taken down by the Monday following Homecoming. This item will be placed on the consent agenda.

**Request to Permit: Mission Church of God to block 4 parking spots on east side of 200 block of McLean Street Monday September 13, 2021 from 3-6 for drive through Mostaccioli Dinner**  
This item will be placed on the consent agenda.

**Proclamation - Remembrance Day September 11, 2021**  
This item will be placed on the regular agenda.

**Proclamation - Constitution Week September 17-23, 2021**  
This item will be placed on the regular agenda.

**Ordinance Creating Section 9-15 of Lincoln City Code "Non-Highway Vehicles-Golf Carts"**  
There is interest by constituents that UTVs be allowed and added to this ordinance.

The group of Alderman working on this item plans to reach out to IDOT to obtain allowance/variances for the state routes that currently do not allow golf carts.

City Attorney Hoblit suggests adding provisions under penalties for people who disobey the ordinance.

The permit applications should be picked up at the Clerk's office not the Police Department.

UTVs will not be added to this item at this time.

This item will be placed on the regular agenda.

Items discussed but not on tonight's agenda....

**Chief Dunovsky went over 2 items that he needs added to next week's regular agenda.**

1. The cost of the SCBA project equipment from AEC Fire Equipment will increase \$31,000 in Oct due to inflation. The cost of this project has been budgeted for. He'd like the council to approve the purchase now at the lower price.
2. Chief Dunovsky received a letter of resignation from a current firefighter. He'd like permission from the council to hire a new firefighter off the current hiring list.

**Mayor Welch sent out a memo regarding parking in the downtown area overnight.**

Currently there is no parking around the square from 2am to 5am. The reason for the no parking is so that the street sweeper can come in overnight and sweep.

There was a photo included in the memo of three parking spaces where tenants of the upstairs apartments are getting parking tickets overnight. Mayor Welch requests that the council remove the parking ban for these three spaces.

A letter is being drafted to explain the ordinance to downtown tenants.

This item will be placed on the regular agenda.

**Announcements:**

- Alderman Hoefle urges everyone to go to the Legion to view the Tomb of the Unknown Soldier.
- Mayor Welch thanked everyone involved for the 9/11 tribute
- The Kings organization asked the City officials to play a game of kickball with them recently. It went over very well.
- 5<sup>th</sup> St Road Update: Currently down to 4 parcels to purchase. One parcel is involved in an estate. The request to shift funds from the parcel acquisitions side over to the engineering side. The request is still pending. The city's IDOT representative will reach back out to the Comptroller.

---

**Adjournment:**

There being no further discussion to come before the City Council of Lincoln, Alderman Bateman, motioned to adjourn, seconded by Alderman Hoefle. All were in favor. Mayor Welch adjourned the meeting at 9:45 p.m.

**Respectfully Submitted By:**

Charity Hutchison, Recording Secretary

# REQUEST TO PERMIT

DATE: 10/6/2021

We, the undersigned of the City of Lincoln, do hereby respectfully request the Mayor and City Council to permit Thursday December 2, 2021

the use of Wyatt Ave west bound from the high school parking lot to Kickapoo St, Kickapoo St from Wyatt Ave to Pekin St, Pekin St from Kickapoo St to Chicago St, and Chicago St from Pekin St to Broadway St for the 2021 Christmas Cruise. We ask that barricades be used at intersections starting at 5:30pm. Please see attached sheet for all marked intersections. Streets Close @ 5:30

If the above request is for use of City property, including streets and/or alleys, please check one of the two boxes below:

- A Certificate of Insurance Liability for the event is attached.
- A Certificate of Insurance Liability for the event will be provided to the City no later than \_\_\_\_\_.

If City property is used, a Certificate of Insurance Liability is required listing the City as an additional insured. The City reserves the right to postpone review and consideration of this Request to Permit until a Certificate of Insurance Liability is provided.

Name: Logan County Tourism Bureau

Address: 101 N Chicago St  
Lincoln, IL 62656

Phone: 217-732-8687 Cell: \_\_\_\_\_

Email: director@destinationlogancountyil.com

h School

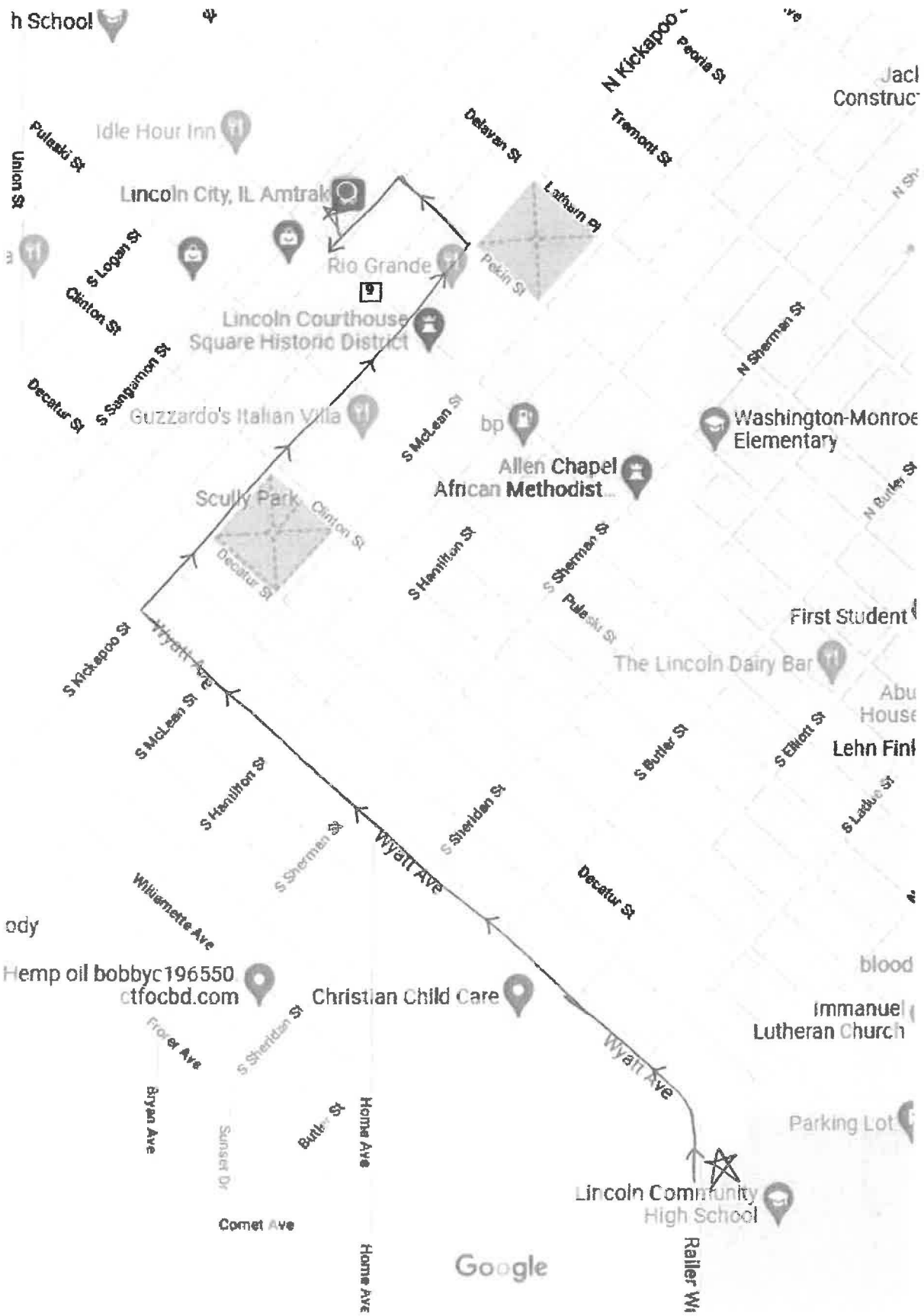

Google



= barricade  
 = cone





# REQUEST TO PERMIT

DATE: 10/6/2021

We, the undersigned of the City of Lincoln, do hereby respectfully request the Mayor and City Council to permit

the use of Pulaski St, S McLean St, Broadway St, and

Kickapoo St for carriage rides around the square on the

following dates: Nov. 26, Nov. 27, Dec. 3, Dec. 4, Dec. 10,

Dec. 17, and Dec. 18. Carriage rides will be 5pm - 8pm on

Friday nights and 12pm - 3pm on Saturday afternoons.

We ask that cones be set up in front of the arcade where

passengers will be loading & unloading.

If the above request is for use of City property, including streets and/ or alleys, please check one of the two boxes below:

A Certificate of Insurance Liability for the event is attached.

A Certificate of Insurance Liability for the event will be provided to the City no later than \_\_\_\_\_.

If City property is used, a Certificate of Insurance Liability is required listing the City as an additional insured. The City reserves the right to postpone review and consideration of this Request to Permit until a Certificate of Insurance Liability is provided.

Name: Logan County Tourism Bureau

Address: 101 N Chicago St

Lincoln, FL 62656

Phone: 217-732-8687 Cell: \_\_\_\_\_

Email: director@destinationlogancountyil.com



# CERTIFICATE OF LIABILITY INSURANCE

DATE (MM/DD/YYYY)  
09/10/2021

THIS CERTIFICATE IS ISSUED AS A MATTER OF INFORMATION ONLY AND CONFERS NO RIGHTS UPON THE CERTIFICATE HOLDER. THIS CERTIFICATE DOES NOT AFFIRMATIVELY OR NEGATIVELY AMEND, EXTEND OR ALTER THE COVERAGE AFFORDED BY THE POLICIES BELOW. THIS CERTIFICATE OF INSURANCE DOES NOT CONSTITUTE A CONTRACT BETWEEN THE ISSUING INSURER(S), AUTHORIZED REPRESENTATIVE OR PRODUCER, AND THE CERTIFICATE HOLDER.

**IMPORTANT:** If the certificate holder is an ADDITIONAL INSURED, the policy(ies) must have ADDITIONAL INSURED provisions or be endorsed. If SUBROGATION IS WAIVED, subject to the terms and conditions of the policy, certain policies may require an endorsement. A statement on this certificate does not confer rights to the certificate holder in lieu of such endorsement(s).

<b>PRODUCER</b> <b>State Farm</b> Chris Coyne Insurance Agency Inc 1301 Woodlawn Rd Lincoln, IL 62656	<b>CONTACT NAME:</b> Chris Coyne <b>PHONE (A/C, No, Ext):</b> 217-732-7755 <b>E-MAIL ADDRESS:</b> chris.coyne.jtj7@statefarm.com <b>FAX (A/C, No):</b> 217-732-8885																				
	<table border="1"> <tr> <th colspan="2">INSURER(S) AFFORDING COVERAGE</th> <th>NAIC #</th> </tr> <tr> <td><b>INSURER A:</b> State Farm Fire and Casualty Company</td> <td></td> <td>25143</td> </tr> <tr> <td><b>INSURER B:</b></td> <td></td> <td></td> </tr> <tr> <td><b>INSURER C:</b></td> <td></td> <td></td> </tr> <tr> <td><b>INSURER D:</b></td> <td></td> <td></td> </tr> <tr> <td><b>INSURER E:</b></td> <td></td> <td></td> </tr> <tr> <td><b>INSURER F:</b></td> <td></td> <td></td> </tr> </table>	INSURER(S) AFFORDING COVERAGE		NAIC #	<b>INSURER A:</b> State Farm Fire and Casualty Company		25143	<b>INSURER B:</b>			<b>INSURER C:</b>			<b>INSURER D:</b>			<b>INSURER E:</b>			<b>INSURER F:</b>	
INSURER(S) AFFORDING COVERAGE		NAIC #																			
<b>INSURER A:</b> State Farm Fire and Casualty Company		25143																			
<b>INSURER B:</b>																					
<b>INSURER C:</b>																					
<b>INSURER D:</b>																					
<b>INSURER E:</b>																					
<b>INSURER F:</b>																					
<b>INSURED</b> Logan County Tourism Bureau 101 N Chicago St Lincoln, IL 62656																					

**COVERAGES**                      **CERTIFICATE NUMBER:**                      **REVISION NUMBER:**

THIS IS TO CERTIFY THAT THE POLICIES OF INSURANCE LISTED BELOW HAVE BEEN ISSUED TO THE INSURED NAMED ABOVE FOR THE POLICY PERIOD INDICATED. NOTWITHSTANDING ANY REQUIREMENT, TERM OR CONDITION OF ANY CONTRACT OR OTHER DOCUMENT WITH RESPECT TO WHICH THIS CERTIFICATE MAY BE ISSUED OR MAY PERTAIN, THE INSURANCE AFFORDED BY THE POLICIES DESCRIBED HEREIN IS SUBJECT TO ALL THE TERMS, EXCLUSIONS AND CONDITIONS OF SUCH POLICIES. LIMITS SHOWN MAY HAVE BEEN REDUCED BY PAID CLAIMS.

INSR LTR	TYPE OF INSURANCE	ADDL SUBR (INSR) WVD	POLICY NUMBER	POLICY EFF (MM/DD/YYYY)	POLICY EXP (MM/DD/YYYY)	LIMITS												
<input checked="" type="checkbox"/>	<b>COMMERCIAL GENERAL LIABILITY</b> <input type="checkbox"/> CLAIMS-MADE <input checked="" type="checkbox"/> OCCUR  GEN'L AGGREGATE LIMIT APPLIES PER: <input checked="" type="checkbox"/> POLICY <input type="checkbox"/> PRO-JECT <input type="checkbox"/> LOC OTHER:		93KHX5514	08/31/2021	08/31/2022	EACH OCCURRENCE \$ 1,000,000 DAMAGE TO RENTED PREMISES (Ea occurrence) \$ 300,000 MED EXP (Any one person) \$ 5,000 PERSONAL & ADV INJURY \$ 1,000,000 GENERAL AGGREGATE \$ 2,000,000 PRODUCTS - COMP/OP AGG \$ 2,000,000 \$												
	<b>AUTOMOBILE LIABILITY</b> <input type="checkbox"/> ANY AUTO <input type="checkbox"/> OWNED AUTOS ONLY <input type="checkbox"/> SCHEDULED AUTOS <input type="checkbox"/> HIRED AUTOS ONLY <input type="checkbox"/> NON-OWNED AUTOS ONLY					COMBINED SINGLE LIMIT (Ea accident) \$ BODILY INJURY (Per person) \$ BODILY INJURY (Per accident) \$ PROPERTY DAMAGE (Per accident) \$ \$												
<input checked="" type="checkbox"/>	<b>UMBRELLA LIAB</b> <input type="checkbox"/> OCCUR <b>EXCESS LIAB</b> <input type="checkbox"/> CLAIMS-MADE DED \$      RETENTION \$		93E6D6979	08/31/2021	08/31/2022	EACH OCCURRENCE \$ 1,000,000 AGGREGATE \$ \$												
	<b>WORKERS COMPENSATION AND EMPLOYERS' LIABILITY</b> ANY PROPRIETOR/PARTNER/EXECUTIVE OFFICER/MEMBER EXCLUDED? (Mandatory in NH) If yes, describe under DESCRIPTION OF OPERATIONS below	Y/N <input type="checkbox"/> N/A	93K4M3188	04/19/2021	04/19/2022	<table border="1"> <tr> <td>PER STATUTE</td> <td>OTH-ER</td> <td></td> </tr> <tr> <td>E.L. EACH ACCIDENT</td> <td></td> <td>\$ 500,000</td> </tr> <tr> <td>E.L. DISEASE - EA EMPLOYEE</td> <td></td> <td>\$ 500,000</td> </tr> <tr> <td>E.L. DISEASE - POLICY LIMIT</td> <td></td> <td>\$ 500,000</td> </tr> </table>	PER STATUTE	OTH-ER		E.L. EACH ACCIDENT		\$ 500,000	E.L. DISEASE - EA EMPLOYEE		\$ 500,000	E.L. DISEASE - POLICY LIMIT		\$ 500,000
PER STATUTE	OTH-ER																	
E.L. EACH ACCIDENT		\$ 500,000																
E.L. DISEASE - EA EMPLOYEE		\$ 500,000																
E.L. DISEASE - POLICY LIMIT		\$ 500,000																

**DESCRIPTION OF OPERATIONS / LOCATIONS / VEHICLES (ACORD 101, Additional Remarks Schedule, may be attached if more space is required)**  
Carriage Rides Around The Square - 11/26, 11/27, 12/3, 12/4, 12/10, 12/17, 12/18/21

<b>CERTIFICATE HOLDER</b> Logan County Board 801 Broadway St Lincoln, IL 62656	<b>CANCELLATION</b> SHOULD ANY OF THE ABOVE DESCRIBED POLICIES BE CANCELLED BEFORE THE EXPIRATION DATE THEREOF, NOTICE WILL BE DELIVERED IN ACCORDANCE WITH THE POLICY PROVISIONS.  AUTHORIZED REPRESENTATIVE 
---	--

# REQUEST TO PERMIT

DATE: 9-30-21

We, the undersigned of the City of Lincoln, do hereby respectfully request the Mayor and City Council to permit

Lincoln Church of God permission to close  
200 block of <sup>S.</sup> # McLean 10/30/21 from 8 AM - 1 P.M. for  
a family fun day. to be in with events already  
happening downtown that day.

If the above request is for use of City property, including streets and/ or alleys, please check one of the two boxes below:

- A Certificate of Insurance Liability for the event is attached.
- A Certificate of Insurance Liability for the event will be provided to the City no later than \_\_\_\_\_.

If City property is used, a Certificate of Insurance Liability is required listing the City as an additional insured. The City reserves the right to postpone review and consideration of this Request to Permit until a Certificate of Insurance Liability is provided.

Name: Terrie McIntire

Address: 601 Oulaski St.  
Lincoln.

Phone: 217-737-0739 Cell: \_\_\_\_\_

Email: \_\_\_\_\_



**Contractor's Application for Payment No. 14**

Application Period: Through 9/30/2021		Application Date: 9/30/2021
To (Owner): City of Lincoln, IL.	From (Contractor): Plocher Construction Company, Inc.	Via (Engineer): Crawford, Murphy, & Tilly, Inc
Project: Lincoln CSO Improvements	Contract: Lincoln CSO Improvements	
Owner's Contract No.: 18003702	Contractor's Project No.: 3840	Engineer's Project No.:

**Application For Payment  
Change Order Summary**

Approved Change Orders		
Number	Additions	Deductions
1	\$1,312.50	
2	\$16,025.50	
3	\$17,748.73	
4	\$3,536.00	
5	\$4,934.00	
6		\$2,229.00
7	\$58,726.00	
<b>TOTALS</b>	<b>\$102,282.73</b>	<b>\$2,229.00</b>
<b>NET CHANGE BY CHANGE ORDERS</b>	<b>\$100,053.73</b>	

1. ORIGINAL CONTRACT PRICE.....	\$	\$13,300,000.00
2. Net change by Change Orders.....	\$	\$100,053.73
3. Current Contract Price (Line 1 ± 2).....	\$	\$13,400,053.73
4. TOTAL COMPLETED AND STORED TO DATE (Column F total on Progress Estimates).....	\$	\$11,902,231.57
5. RETAINAGE:		
a. 5% X \$11,773,981.65 Work Completed.....	\$	\$588,699.08
b. 5% X \$128,249.92 Stored Material.....	\$	\$6,412.50
c. Total Retainage (Line 5.a + Line 5.b).....	\$	\$595,111.58
6. AMOUNT ELIGIBLE TO DATE (Line 4 - Line 5.c).....	\$	\$11,307,119.99
7. LESS PREVIOUS PAYMENTS (Line 6 from prior Application).....	\$	\$10,703,095.86
8. AMOUNT DUE THIS APPLICATION.....	\$	\$604,024.13
9. BALANCE TO FINISH, PLUS RETAINAGE (Column G total on Progress Estimates + Line 5.c above).....	\$	\$2,092,933.74

**Contractor's Certification**

The undersigned Contractor certifies, to the best of its knowledge, the following:  
 (1) All previous progress payments received from Owner on account of Work done under the Contract have been applied on account to discharge Contractor's legitimate obligations incurred in connection with the Work covered by prior Applications for Payment;  
 (2) Title to all Work, materials and equipment incorporated in said Work, or otherwise listed in or covered by this Application for Payment, will pass to Owner at time of payment free and clear of all Liens, security interests, and encumbrances (except such as are covered by a bond acceptable to Owner indemnifying Owner against any such Liens, security interest, or encumbrances); and  
 (3) All the Work covered by this Application for Payment is in accordance with the Contract Documents and is not defective.

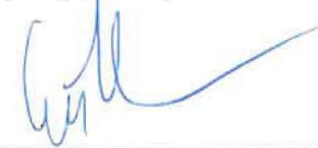
Contractor Signature:   
 By: Scott Plocher, President      Date: 9/30/2021

Payment of: \$ 604,024.13  
 (Line 8 or other - attach explanation of the other amount)  
 is recommended by:  10/7/2021  
 (Engineer) (Date)  
 Payment of: \$ 604,024.13  
 (Line 8 or other - attach explanation of the other amount)  
 is approved by: \_\_\_\_\_  
 (Owner) (Date)  
 Approved by: \_\_\_\_\_  
 Funding or Financing Entity (if applicable) (Date)

CITY CLERK  
LINCOLN, ILLINOIS

OCT 07 2021

RECEIVED

Progress Estimate - Lump Sum Work

For (Contract):	Lincoln CSO Improvements	Application Number:	14
Application Period:	Through 9/30/2021	Application Date:	9/30/2021

				Work Completed			E	F		G
Structure	Bid Item No.	Material/Labor	Description	B	C	D	Materials Presently Stored (not in C or D)	Total Completed and Stored to Date (C + D + E)	% (F / B)	Balance to Finish (B - F)
				Scheduled Value (\$)	From Previous Application (C+D)	This Period				
Administration		L	Mobilization	\$300,000.00	\$240,000.00			\$240,000.00	80.0%	\$60,000
			Bonds & Insurance	\$150,000.00	\$150,000.00			\$150,000.00	100.0%	
Unit Prices		L	General Conditions (extend over 18 months)	\$500,000.00	\$390,000.00	\$30,000.00		\$420,000.00	84.0%	\$80,000
	1		First Flush Tank Slab Repair 4"	\$38,460.00						
	2		First Flush Tank Slab Repair 6"	\$85,910.00						\$85,910
	3	L	Layout	\$18,500.00	\$18,500.00			\$18,500.00	100.0%	
	3	L	Site Stripping/Grading	\$77,190.00	\$77,190.00			\$77,190.00	100.0%	
	3	L	Site Demo	\$50,000.00	\$50,000.00			\$50,000.00	100.0%	
	3	L	Quality Control & Testing	\$70,000.00	\$67,000.00	\$1,500.00		\$68,500.00	97.9%	\$1,500
	3	M	Erosion Control/SWPPP	\$15,000.00	\$14,000.00			\$14,000.00	93.3%	\$1,000
	3	L	Erosion Control/SWPPP	\$30,000.00	\$28,000.00			\$28,000.00	93.3%	\$2,000
	3	M	Dewatering System & Support	\$30,000.00	\$30,000.00			\$30,000.00	100.0%	
	3	L	Dewatering System & Support	\$60,000.00	\$60,000.00			\$60,000.00	100.0%	
	3	M	Temporary Access Roads/Staging Area	\$30,000.00	\$30,000.00			\$30,000.00	100.0%	
	3	L	Temporary Access Roads/Staging Area	\$32,000.00	\$32,000.00			\$32,000.00	100.0%	
	3	M	Bituminous Asphalt Paving - Entrance Road	\$90,000.00						\$90,000
	3	L	Bituminous Asphalt Paving - Entrance Road	\$60,000.00						\$60,000
	3	M	Bituminous Asphalt Paving - Around Structures	\$24,000.00						\$24,000
	3	L	Bituminous Asphalt Paving - Around Structures	\$24,000.00						\$24,000
	3	M	Aggregate Surfacing	\$10,000.00						\$10,000
	3	L	Aggregate Surfacing	\$25,000.00						\$25,000
	3	M	Rip Rap	\$15,000.00	\$15,000.00			\$15,000.00	100.0%	
	3	L	Rip Rap	\$15,000.00	\$15,000.00			\$15,000.00	100.0%	
	3	M	Fence/Gate - Removal & New Install	\$5,000.00	\$5,000.00			\$5,000.00	100.0%	
	3	L	Fence/Gate - Removal & New Install	\$10,000.00	\$10,000.00			\$10,000.00	100.0%	
	3	M	Site Seeding/Topsail	\$10,000.00	\$5,500.00	\$4,500.00		\$10,000.00	100.0%	
	3	L	Site Seeding/Topsail	\$10,000.00	\$5,500.00			\$5,500.00	55.0%	\$4,500
	3	M	Bollards	\$12,000.00	\$12,000.00			\$12,000.00	100.0%	
	3	L	Bollards	\$10,000.00	\$10,000.00			\$10,000.00	100.0%	
	3	L	Utility Locate/Pothole/Hydro-Excavation	\$15,000.00	\$12,000.00	\$3,000.00		\$15,000.00	100.0%	
	3	M	Electrical Ductbank	\$40,000.00	\$34,878.52	\$5,121.48		\$40,000.00	100.0%	
	3	L	Electrical Ductbank	\$60,000.00	\$52,000.00	\$8,000.00		\$60,000.00	100.0%	
	3	M	Sectionalizing Cabinet	\$2,500.00	\$2,500.00			\$2,500.00	100.0%	
	3	L	Sectionalizing Cabinet	\$3,000.00	\$3,000.00			\$3,000.00	100.0%	
	3	M	Electrical Wire & Conduit	\$50,000.00	\$36,000.00	\$8,000.00		\$44,000.00	88.0%	\$6,000
	3	L	Electrical Wire & Conduit	\$90,000.00	\$65,000.00	\$10,000.00		\$75,000.00	83.3%	\$15,000
	3	M	Handholds	\$15,000.00	\$15,000.00			\$15,000.00	100.0%	
	3	L	Handholds	\$10,000.00	\$10,000.00			\$10,000.00	100.0%	
	3	L	Electrical Testing	\$15,000.00						\$15,000
	3	M	Manholes	\$46,000.00	\$46,000.00			\$46,000.00	100.0%	
	3	L	Manholes	\$25,000.00	\$25,000.00			\$25,000.00	100.0%	
	3	L	Remove Existing Storm Sewer Pipe	\$10,000.00	\$10,000.00			\$10,000.00	100.0%	
	3	M	Relocate Hydrants	\$1,000.00						\$1,000
	3	L	Relocate Hydrants	\$1,000.00						\$1,000
	3	M	60" GFRPM - Chlorine Contact Influent	\$80,000.00	\$80,000.00			\$80,000.00	100.0%	
	3	L	60" GFRPM - Chlorine Contact Influent	\$20,000.00	\$20,000.00			\$20,000.00	100.0%	
	3	M	60" GFRPM - Swirl Concentrator Influent Pipe	\$65,000.00	\$65,000.00			\$65,000.00	100.0%	
	3	L	60" GFRPM - Swirl Concentrator Influent Pipe	\$12,000.00	\$12,000.00			\$12,000.00	100.0%	
	3	M	60" GFRPM - Chlorine Contact Effluent Pipe	\$65,000.00	\$65,000.00			\$65,000.00	100.0%	
	3	L	60" GFRPM - Chlorine Contact Effluent Pipe	\$12,000.00	\$12,000.00			\$12,000.00	100.0%	
	3	M	60" GFRPM - First Flush Tank Influent Pipe	\$65,000.00	\$65,000.00			\$65,000.00	100.0%	
	3	L	60" GFRPM - First Flush Tank Influent Pipe	\$13,000.00	\$13,000.00			\$13,000.00	100.0%	
	3	M	72" GFRPM - CSO Influent Pipe	\$85,500.00	\$85,500.00			\$85,500.00	100.0%	
	3	L	72" GFRPM - CSO Influent Pipe	\$19,500.00	\$19,500.00			\$19,500.00	100.0%	
	3	M	12" DIP - First Flush Tank Aeration Pipe	\$26,000.00	\$26,000.00			\$26,000.00	100.0%	
	3	L	12" DIP - First Flush Tank Aeration Pipe	\$29,000.00	\$14,500.00	\$5,000.00		\$19,500.00	67.2%	\$9,500
	3	M	12" DIP - Pump STA Drain	\$20,000.00	\$20,000.00			\$20,000.00	100.0%	
	3	L	12" DIP - Pump STA Drain	\$20,000.00	\$20,000.00			\$20,000.00	100.0%	

**Progress Estimate - Lump Sum Work**

For (Contract):		Lincoln CSO Improvements					Application Number:		14	
Application Period:		Through 9/30/2021					Application Date:		9/30/2021	
		A		B	Work Completed		E	F		G
Structure	Bid Item No.	Material/Labor	Description	Scheduled Value (\$)	C	D	Materials Presently Stored (not in C or D)	Total Completed and Stored to Date (C + D + E)	% (F / B)	Balance to Finish (B - F)
					From Previous Application (C+D)	This Period				
	3	M	12" DIP - First Flush Tank Drain Piping	\$8,000.00	\$7,999.73	\$0.27		\$8,000.00	100.0%	
	3	L	12" DIP - First Flush Tank Drain Piping	\$16,000.00	\$16,000.00			\$16,000.00	100.0%	
	3	M	20" DIP - Swirl Underflow Pipe	\$30,000.00	\$30,000.00			\$30,000.00	100.0%	
	3	L	20" DIP - Swirl Underflow Pipe	\$15,000.00	\$15,000.00			\$15,000.00	100.0%	
	3	M	24" DIP - Underflow to First Flush Tank	\$15,000.00	\$11,606.84			\$11,606.84	77.4%	\$3,393
	3	L	24" DIP - Underflow to First Flush Tank	\$10,000.00	\$10,000.00			\$10,000.00	100.0%	
	3	M	1" SCH 80 PVC Pipe - Chemical Lines	\$10,000.00	\$10,000.00			\$10,000.00	100.0%	
	3	L	1" SCH 80 PVC Pipe - Chemical Lines	\$20,000.00	\$20,000.00			\$20,000.00	100.0%	
	3	M	4" PVC Pipe - Plant Water	\$15,000.00	\$15,000.00			\$15,000.00	100.0%	
	3	L	4" PVC Pipe - Plant Water	\$25,000.00	\$15,000.00	\$5,000.00		\$20,000.00	80.0%	\$5,000
	3	M	6" PVC Pipe - Water Plant Backwash	\$2,000.00	\$2,000.00			\$2,000.00	100.0%	
	3	L	6" PVC Pipe - Water Plant Backwash	\$3,000.00	\$3,000.00			\$3,000.00	100.0%	
	3	M	8" PVC Pipe - Chlorine Tank Drain	\$4,000.00	\$4,000.00			\$4,000.00	100.0%	
	3	L	8" PVC Pipe - Chlorine Tank Drain	\$2,000.00	\$2,000.00			\$2,000.00	100.0%	
	3	M	24" PVC Pipe - Sherman Sewer Dry Weather Pipe	\$40,000.00	\$40,000.00			\$40,000.00	100.0%	
	3	L	24" PVC Pipe - Sherman Sewer Dry Weather Pipe	\$30,000.00	\$30,000.00			\$30,000.00	100.0%	
	3	M	30" PVC Pipe - Dry Weather Flow Pipe	\$8,000.00	\$8,000.00			\$8,000.00	100.0%	
	3	L	30" PVC Pipe - Dry Weather Flow Pipe	\$6,000.00	\$6,000.00			\$6,000.00	100.0%	
	3	M	48" HDPE Storm Sewer	\$50,000.00	\$50,000.00			\$50,000.00	100.0%	
	3	L	48" HDPE Storm Sewer	\$30,000.00	\$30,000.00			\$30,000.00	100.0%	
	3	M	UG Valves	\$15,000.00	\$7,500.00			\$7,500.00	50.0%	\$7,500
	3	L	UG Valves	\$5,000.00	\$2,500.00			\$2,500.00	50.0%	\$2,500
	3	M	18" RCP Culvert	\$10,000.00	\$10,000.00			\$10,000.00	100.0%	
	3	L	18" RCP Culvert	\$20,000.00	\$20,000.00			\$20,000.00	100.0%	
	3	M	60" Precast Flare	\$7,000.00	\$7,000.00			\$7,000.00	100.0%	
	3	L	60" Precast Flare	\$10,000.00	\$10,000.00			\$10,000.00	100.0%	
	3	M	48" Precast Flare	\$5,000.00	\$5,000.00			\$5,000.00	100.0%	
	3	L	48" Precast Flare	\$8,000.00	\$8,000.00			\$8,000.00	100.0%	
	3	M	Yard Hydrant	\$1,000.00						\$1,000
	3	L	Yard Hydrant	\$1,000.00						\$1,000
	3	M	UG Process Pipe Concrete Encasement	\$10,000.00	\$10,000.00			\$10,000.00	100.0%	
	3	L	UG Process Pipe Concrete Encasement	\$20,000.00	\$20,000.00			\$20,000.00	100.0%	
	3	L	Process Pipe Testing	\$10,000.00		\$5,000.00		\$5,000.00	50.0%	\$5,000
	3	L	Demo Channel Slabs	\$10,000.00	\$10,000.00			\$10,000.00	100.0%	
	3	L	Demo Overflow Weir	\$1,000.00						\$1,000
	3	L	Demo Channel End for Pipe Ext.	\$3,000.00						\$3,000
	3	M	Temporary/Bypass Pumping - Concrete Channel	\$20,000.00	\$20,000.00			\$20,000.00	100.0%	
	3	L	Temporary/Bypass Pumping - Concrete Channel	\$40,000.00	\$40,000.00			\$40,000.00	100.0%	
	3	M	Channel Section Repairs	\$15,000.00	\$15,000.00			\$15,000.00	100.0%	
	3	L	Channel Section Repairs	\$45,000.00	\$45,000.00			\$45,000.00	100.0%	
	3	M	Fill Channel Drop Structures	\$5,000.00	\$5,000.00			\$5,000.00	100.0%	
	3	L	Fill Channel Drop Structures	\$5,000.00	\$5,000.00			\$5,000.00	100.0%	
	3	M	6" Underdrain	\$3,500.00	\$3,500.00			\$3,500.00	100.0%	
	3	L	6" Underdrain	\$2,000.00	\$2,000.00			\$2,000.00	100.0%	
	3	M	Temporary Channel Dam	\$6,000.00	\$6,000.00			\$6,000.00	100.0%	
	3	L	Temporary Channel Dam	\$3,500.00	\$3,500.00			\$3,500.00	100.0%	
	3	M	Temporary Crossing/Causeway	\$6,000.00	\$6,000.00			\$6,000.00	100.0%	
	3	L	Temporary Crossing/Causeway	\$10,000.00	\$10,000.00			\$10,000.00	100.0%	
	3	M	Excavation/Backfill	\$20,000.00	\$20,000.00			\$20,000.00	100.0%	
	3	L	Excavation/Backfill	\$40,000.00	\$40,000.00			\$40,000.00	100.0%	
	3	M	Precast Bridge	\$100,000.00	\$100,000.00			\$100,000.00	100.0%	
	3	L	Precast Bridge	\$70,000.00	\$70,000.00			\$70,000.00	100.0%	
	3	M	Bridge Piling	\$30,000.00	\$30,000.00			\$30,000.00	100.0%	
	3	L	Bridge Piling	\$50,000.00	\$50,000.00			\$50,000.00	100.0%	
	3	M	Bridge Guardrail	\$10,000.00						\$10,000
	3	L	Bridge Guardrail	\$15,000.00						\$15,000
	3	M	Concrete Forming, Placing, Curing & Finishing - Bridge Foundation	\$10,000.00	\$10,000.00			\$10,000.00	100.0%	
	3	L	Concrete Forming, Placing, Curing & Finishing - Bridge Foundation	\$15,000.00	\$15,000.00			\$15,000.00	100.0%	



**Progress Estimate - Lump Sum Work**

For (Contract):		Lincoln CSO Improvements				Application Number:		14			
Application Period:		Through 9/30/2021				Application Date:		9/30/2021			
		A		B	C		D	E	F		G
Structure	Bid Item No.	Material/Labor	Description	Scheduled Value (\$)	From Previous Application (C+D)	This Period	Materials Presently Stored (not in C or D)	Total Completed and Stored to Date (C + D + E)	% (F / B)	Balance to Finish (B - F)	
	3	M	Grout	\$1,500.00	\$1,500.00			\$1,500.00	100.0%		
	3	L	Grout	\$3,000.00	\$3,000.00			\$3,000.00	100.0%		
	3	M	Concrete Paving - Bridge & Approach	\$20,000.00		\$20,000.00		\$20,000.00	100.0%		
	3	L	Concrete Paving - Bridge & Approach	\$32,000.00		\$32,000.00		\$32,000.00	100.0%		
	3	M	Excavation/Backfill	\$15,000.00	\$15,000.00			\$15,000.00	100.0%		
	3	L	Excavation/Backfill	\$30,000.00	\$30,000.00			\$30,000.00	100.0%		
	3	M	Temporary/Bypass Pumping - 72" Sherman	\$20,000.00	\$20,000.00			\$20,000.00	100.0%		
	3	L	Temporary/Bypass Pumping - 72" Sherman	\$25,000.00	\$25,000.00			\$25,000.00	100.0%		
	3	L	Demo 72" Pipe	\$10,000.00	\$10,000.00			\$10,000.00	100.0%		
	3	M	Temp. Pipe Support	\$5,000.00	\$5,000.00			\$5,000.00	100.0%		
	3	L	Temp. Pipe Support	\$5,000.00	\$5,000.00			\$5,000.00	100.0%		
	3	M	Concrete Forming, Placing, Curing & Finishing - Slabs	\$4,000.00	\$4,000.00			\$4,000.00	100.0%		
	3	L	Concrete Forming, Placing, Curing & Finishing - Slabs	\$8,000.00	\$8,000.00			\$8,000.00	100.0%		
	3	M	Concrete Forming, Placing, Curing & Finishing - Walls	\$5,000.00	\$5,000.00			\$5,000.00	100.0%		
	3	L	Concrete Forming, Placing, Curing & Finishing - Walls	\$10,000.00	\$10,000.00			\$10,000.00	100.0%		
	3	M	Concrete Reinforcing	\$8,000.00	\$8,000.00			\$8,000.00	100.0%		
	3	L	Concrete Reinforcing	\$15,000.00	\$15,000.00			\$15,000.00	100.0%		
	3	M	Grout	\$1,500.00	\$1,500.00			\$1,500.00	100.0%		
	3	L	Grout	\$2,500.00	\$2,500.00			\$2,500.00	100.0%		
	3	M	Excavation/Backfill	\$20,000.00	\$20,000.00			\$20,000.00	100.0%		
	3	L	Excavation/Backfill	\$40,000.00	\$40,000.00			\$40,000.00	100.0%		
	3	M	Excavation Support/Shoring System	\$30,000.00	\$30,000.00			\$30,000.00	100.0%		
	3	L	Excavation Support/Shoring System	\$50,000.00	\$50,000.00			\$50,000.00	100.0%		
	3	M	Concrete Forming, Placing, Curing & Finishing - Slabs	\$9,000.00	\$9,000.00			\$9,000.00	100.0%		
	3	L	Concrete Forming, Placing, Curing & Finishing - Slabs	\$15,000.00	\$15,000.00			\$15,000.00	100.0%		
	3	M	Concrete Forming, Placing, Curing & Finishing - Walls	\$17,000.00	\$17,000.00			\$17,000.00	100.0%		
	3	L	Concrete Forming, Placing, Curing & Finishing - Walls	\$35,000.00	\$35,000.00			\$35,000.00	100.0%		
	3	M	Concrete Reinforcing	\$10,000.00	\$10,000.00			\$10,000.00	100.0%		
	3	L	Concrete Reinforcing	\$25,000.00	\$25,000.00			\$25,000.00	100.0%		
	3	M	Grout	\$5,000.00	\$5,000.00			\$5,000.00	100.0%		
	3	L	Grout	\$10,000.00	\$10,000.00			\$10,000.00	100.0%		
	3	M	Bar Grate & Weir	\$15,000.00	\$15,000.00			\$15,000.00	100.0%		
	3	L	Bar Grate & Weir	\$10,000.00	\$10,000.00			\$10,000.00	100.0%		
	3	M	Level Sensor	\$5,000.00	\$5,000.00			\$5,000.00	100.0%		
	3	L	Level Sensor	\$1,500.00	\$1,500.00			\$1,500.00	100.0%		
	3	M	Electrical Wiring & Conduit	\$5,000.00	\$3,500.00	\$1,500.00		\$5,000.00	100.0%		
	3	L	Electrical Wiring & Conduit	\$4,000.00	\$3,000.00	\$1,000.00		\$4,000.00	100.0%		
	3	L	Startup & Testing	\$2,000.00						\$2,000	
	3	M	Excavation/Backfill	\$55,000.00	\$55,000.00			\$55,000.00	100.0%		
	3	L	Excavation/Backfill	\$300,000.00	\$300,000.00			\$300,000.00	100.0%		
	3	M	Excavation Support/Shoring System	\$30,000.00	\$30,000.00			\$30,000.00	100.0%		
	3	L	Excavation Support/Shoring System	\$60,000.00	\$60,000.00			\$60,000.00	100.0%		
	3	M	Concrete Forming, Placing, Curing & Finishing - Slabs/Beams	\$65,000.00	\$65,000.00			\$65,000.00	100.0%		
	3	L	Concrete Forming, Placing, Curing & Finishing - Slabs/Beams	\$100,000.00	\$100,000.00			\$100,000.00	100.0%		
	3	M	Concrete Forming, Placing, Curing & Finishing - Walls	\$145,000.00	\$145,000.00			\$145,000.00	100.0%		
	3	L	Concrete Forming, Placing, Curing & Finishing - Walls	\$280,000.00	\$280,000.00			\$280,000.00	100.0%		
	3	M	Concrete Reinforcing	\$150,000.00	\$150,000.00			\$150,000.00	100.0%		
	3	L	Concrete Reinforcing	\$140,000.00	\$140,000.00			\$140,000.00	100.0%		
	3	M	Grout	\$5,000.00	\$5,000.00			\$5,000.00	100.0%		
	3	L	Grout	\$15,000.00	\$15,000.00			\$15,000.00	100.0%		
	3	M	Misc. Concrete	\$5,000.00	\$5,000.00			\$5,000.00	100.0%		
	3	L	Misc. Concrete	\$8,000.00	\$8,000.00			\$8,000.00	100.0%		
	3	M	Concrete Paving	\$18,000.00	\$18,000.00			\$18,000.00	100.0%		
	3	L	Concrete Paving	\$35,000.00	\$35,000.00			\$35,000.00	100.0%		
	3	M	Flow Regulator	\$18,050.00	\$18,050.00			\$18,050.00	100.0%		
	3	L	Flow Regulator	\$4,500.00	\$4,500.00			\$4,500.00	100.0%		
	3	M	Slide Gates	\$156,845.00	\$156,845.00			\$156,845.00	100.0%		
	3	L	Slide Gates	\$60,000.00	\$60,000.00			\$60,000.00	100.0%		

**Progress Estimate - Lump Sum Work**

For (Contract):		Lincoln CSO Improvements				Application Number:		14		
Application Period:		Through 9/30/2021				Application Date:		9/30/2021		
		A		B	Work Completed		E	F		G
Structure	Bid Item No.	Material/Labor	Description	Scheduled Value (\$)	C	D	Materials Presently Stored (not in C or D)	Total Completed and Stored to Date (C + D + E)	% (F / B)	Balance to Finish (B - F)
					From Previous Application (C+D)	This Period				
Screens & Pump Station	3	M	Axial Flow Pumps	\$543,000.00	\$543,000.00			\$543,000.00	100.0%	
	3	L	Axial Flow Pumps	\$60,000.00	\$60,000.00			\$60,000.00	100.0%	
	3	M	Submersible Wastewater Pumps	\$145,000.00	\$145,000.00			\$145,000.00	100.0%	
	3	L	Submersible Wastewater Pumps	\$20,000.00	\$20,000.00			\$20,000.00	100.0%	
	3	M	Catenary Bar Screen	\$155,640.00	\$155,640.00			\$155,640.00	100.0%	
	3	L	Catenary Bar Screen	\$20,000.00	\$20,000.00			\$20,000.00	100.0%	
	3	L	Startup & Testing	\$10,000.00	\$8,000.00	\$2,000.00		\$10,000.00	100.0%	
	3	M	Manual Bar Screen	\$5,000.00	\$5,000.00			\$5,000.00	100.0%	
	3	L	Manual Bar Screen	\$5,000.00	\$5,000.00			\$5,000.00	100.0%	
	3	M	Steel Beams /Angles	\$40,000.00	\$40,000.00			\$40,000.00	100.0%	
	3	L	Steel Beams /Angles	\$30,000.00	\$30,000.00			\$30,000.00	100.0%	
	3	M	Handrail	\$20,000.00	\$20,000.00			\$20,000.00	100.0%	
	3	L	Handrail	\$15,000.00	\$15,000.00			\$15,000.00	100.0%	
	3	M	FRP Grating	\$45,000.00	\$45,000.00			\$45,000.00	100.0%	
	3	L	FRP Grating	\$20,000.00	\$20,000.00			\$20,000.00	100.0%	
	3	M	Misc. Metals	\$5,000.00	\$5,000.00			\$5,000.00	100.0%	
	3	L	Misc. Metals	\$5,000.00	\$5,000.00			\$5,000.00	100.0%	
	3	M	Stairs	\$15,000.00	\$15,000.00			\$15,000.00	100.0%	
	3	L	Stairs	\$15,000.00	\$15,000.00			\$15,000.00	100.0%	
	3	M	Level Sensors	\$16,000.00	\$16,000.00			\$16,000.00	100.0%	
	3	L	Level Sensors	\$4,000.00	\$4,000.00			\$4,000.00	100.0%	
	3	M	Process Valves & Sleeves & Fittings	\$30,000.00	\$30,000.00			\$30,000.00	100.0%	
	3	L	Process Valves & Sleeves & Fittings	\$15,000.00	\$15,000.00			\$15,000.00	100.0%	
	3	M	6" DIP Drain Pump Pipe	\$8,000.00	\$8,000.00			\$8,000.00	100.0%	
	3	L	6" DIP Drain Pump Pipe	\$5,000.00	\$5,000.00			\$5,000.00	100.0%	
	3	M	10" DIP Drain	\$3,500.00	\$3,500.00			\$3,500.00	100.0%	
	3	L	10" DIP Drain	\$2,000.00	\$2,000.00			\$2,000.00	100.0%	
	3	M	12" DIP Underflow Pump Pipe	\$15,000.00	\$15,000.00			\$15,000.00	100.0%	
	3	L	12" DIP Underflow Pump Pipe	\$10,000.00	\$10,000.00			\$10,000.00	100.0%	
	3	M	Electrical Wire & Conduit	\$25,000.00	\$25,000.00			\$25,000.00	100.0%	
	3	L	Electrical Wire & Conduit	\$30,000.00	\$30,000.00			\$30,000.00	100.0%	
	3	M	Lighting	\$5,000.00	\$5,000.00			\$5,000.00	100.0%	
	3	L	Lighting	\$5,000.00	\$5,000.00			\$5,000.00	100.0%	
Swirl Concentrator	3	M	Excavation/Backfill	\$45,000.00	\$45,000.00			\$45,000.00	100.0%	
	3	L	Excavation/Backfill	\$125,000.00	\$125,000.00			\$125,000.00	100.0%	
	3	M	Excavation Support/Shoring System	\$20,000.00	\$20,000.00			\$20,000.00	100.0%	
	3	L	Excavation Support/Shoring System	\$30,000.00	\$30,000.00			\$30,000.00	100.0%	
	3	M	Concrete Forming, Placing, Curing & Finishing - Slabs	\$35,000.00	\$35,000.00			\$35,000.00	100.0%	
	3	L	Concrete Forming, Placing, Curing & Finishing - Slabs	\$70,000.00	\$70,000.00			\$70,000.00	100.0%	
	3	M	Concrete Forming, Placing, Curing & Finishing - Walls	\$50,000.00	\$50,000.00			\$50,000.00	100.0%	
	3	L	Concrete Forming, Placing, Curing & Finishing - Walls	\$100,000.00	\$100,000.00			\$100,000.00	100.0%	
	3	M	Concrete Forming, Placing, Curing & Finishing - Influent & Effluent Channel	\$9,000.00	\$9,000.00			\$9,000.00	100.0%	
	3	L	Concrete Forming, Placing, Curing & Finishing - Influent & Effluent Channel	\$15,000.00	\$15,000.00			\$15,000.00	100.0%	
	3	M	Concrete Reinforcing	\$30,000.00	\$30,000.00			\$30,000.00	100.0%	
	3	L	Concrete Reinforcing	\$30,000.00	\$30,000.00			\$30,000.00	100.0%	
	3	M	Grout/Misc. Concrete	\$9,000.00	\$9,000.00			\$9,000.00	100.0%	
	3	L	Grout/Misc. Concrete	\$10,000.00	\$10,000.00			\$10,000.00	100.0%	
	3	M	Swirl Concentrator	\$309,680.00	\$309,680.00			\$309,680.00	100.0%	
	3	L	Swirl Concentrator	\$30,000.00	\$30,000.00			\$30,000.00	100.0%	
	3	L	Startup & Testing	\$5,000.00	\$2,500.00	\$2,500.00		\$5,000.00	100.0%	
	3	M	Steel Beams	\$40,000.00	\$40,000.00			\$40,000.00	100.0%	
	3	L	Steel Beams	\$35,000.00	\$35,000.00			\$35,000.00	100.0%	
	3	M	Handrail	\$8,000.00	\$8,000.00			\$8,000.00	100.0%	
	3	L	Handrail	\$10,000.00	\$10,000.00			\$10,000.00	100.0%	
	3	M	FRP Grating	\$10,000.00	\$10,000.00			\$10,000.00	100.0%	
	3	L	FRP Grating	\$5,000.00	\$5,000.00			\$5,000.00	100.0%	
	3	M	Stairs	\$5,000.00	\$5,000.00			\$5,000.00	100.0%	
	3	L	Stairs	\$2,500.00	\$2,500.00			\$2,500.00	100.0%	

Progress Estimate - Lump Sum Work

For (Contract):	Lincoln CSO Improvements	Application Number:	14
Application Period:	Through 9/30/2021	Application Date:	9/30/2021

Structure	Bid Item No.	Material/Labor	Description	B Scheduled Value (\$)	Work Completed		E Materials Presently Stored (not in C or D)	F Total Completed and Stored to Date (C + D + E)	G % (F / B)	Balance to Finish (B - F)	
					C From Previous Application (C+D)	D This Period					
Chlorine Contact Tank	3	M	Excavation/Backfill	\$5,000.00	\$5,000.00			\$5,000.00	100.0%		
	3	L	Excavation/Backfill	\$15,000.00	\$15,000.00			\$15,000.00	100.0%		
	3	L	Select Demo	\$20,000.00	\$20,000.00			\$20,000.00	100.0%		
	3	L	Concrete Tank Cleaning	\$3,000.00	\$3,000.00			\$3,000.00	100.0%		
	3	L	Clean & Inspect Existing PRVs	\$2,500.00	\$2,500.00			\$2,500.00	100.0%		
	3	M	Concrete Forming, Placing, Curing & Finishing - Well	\$5,000.00	\$5,000.00			\$5,000.00	100.0%		
	3	L	Concrete Forming, Placing, Curing & Finishing - Well	\$10,000.00	\$10,000.00			\$10,000.00	100.0%		
	3	M	Concrete Forming, Placing, Curing & Finishing - Influent Line Connection	\$1,240.00	\$1,240.00			\$1,240.00	100.0%		
	3	L	Concrete Forming, Placing, Curing & Finishing - Influent Line Connection	\$4,000.00	\$4,000.00			\$4,000.00	100.0%		
	3	M	Concrete Reinforcing	\$5,000.00	\$5,000.00			\$5,000.00	100.0%		
	3	L	Concrete Reinforcing	\$10,000.00	\$10,000.00			\$10,000.00	100.0%		
	3	M	GROUT	\$1,000.00	\$1,000.00			\$1,000.00	100.0%		
	3	L	GROUT	\$2,000.00	\$2,000.00			\$2,000.00	100.0%		
	3	M	Tank Baffle System	\$231,380.00	\$231,380.00			\$231,380.00	100.0%		
	3	L	Tank Baffle System	\$35,000.00	\$35,000.00			\$35,000.00	100.0%		
	3	M	Handrail & Weir	\$5,000.00	\$1,500.00			\$1,500.00	30.0%	\$3,500	
	3	L	Handrail & Weir	\$5,000.00	\$1,500.00			\$1,500.00	30.0%	\$3,500	
	3	M	Level Sensor	\$5,500.00	\$5,500.00			\$5,500.00	100.0%		
	3	L	Level Sensor	\$1,500.00	\$500.00		\$1,000.00	\$1,500.00	100.0%		
	3	M	Electrical Wire & Conduit	\$10,000.00	\$3,500.00		\$5,000.00	\$8,500.00	85.0%	\$1,500	
	3	L	Electrical Wire & Conduit	\$15,000.00	\$4,500.00		\$8,500.00	\$13,000.00	86.7%	\$2,000	
	First Flush Tank	3	L	Select Demo	\$70,000.00	\$70,000.00			\$70,000.00	100.0%	
		3	L	Concrete Tank Cleaning	\$5,000.00	\$5,000.00			\$5,000.00	100.0%	
		3	L	Clean & Inspect Existing PRVs	\$2,500.00	\$2,500.00			\$2,500.00	100.0%	
		3	M	Excavation/Backfill	\$20,000.00	\$20,000.00			\$20,000.00	100.0%	
3		L	Excavation/Backfill	\$60,000.00	\$60,000.00			\$60,000.00	100.0%		
3		M	Excavation Support/Shoring System	\$20,000.00	\$20,000.00			\$20,000.00	100.0%		
3		L	Excavation Support/Shoring System	\$45,000.00	\$45,000.00			\$45,000.00	100.0%		
3		M	Concrete Forming, Placing, Curing & Finishing - Influent Channel	\$5,000.00	\$5,000.00			\$5,000.00	100.0%		
3		L	Concrete Forming, Placing, Curing & Finishing - Influent Channel	\$15,000.00	\$15,000.00			\$15,000.00	100.0%		
3		M	Concrete Forming, Placing, Curing & Finishing - Slabs	\$50,000.00	\$50,000.00			\$50,000.00	100.0%		
3		L	Concrete Forming, Placing, Curing & Finishing - Slabs	\$75,000.00	\$75,000.00			\$75,000.00	100.0%		
3		M	Concrete Forming, Placing, Curing & Finishing - Walls	\$75,000.00	\$75,000.00			\$75,000.00	100.0%		
3		L	Concrete Forming, Placing, Curing & Finishing - Walls	\$130,000.00	\$130,000.00			\$130,000.00	100.0%		
3		M	Concrete Reinforcing	\$40,000.00	\$40,000.00			\$40,000.00	100.0%		
3		L	Concrete Reinforcing	\$65,000.00	\$65,000.00			\$65,000.00	100.0%		
3		M	GROUT	\$10,000.00	\$10,000.00			\$10,000.00	100.0%		
3		L	GROUT	\$20,000.00	\$20,000.00			\$20,000.00	100.0%		
3		M	Misc. Concrete	\$2,500.00			\$2,500.00	\$2,500.00	100.0%		
3		L	Misc. Concrete	\$5,000.00			\$5,000.00	\$5,000.00	100.0%		
3		M	Submersible Mixers	\$80,000.00		\$80,000.00		\$80,000.00	100.0%		
3		L	Submersible Mixers	\$15,000.00			\$5,000.00	\$5,000.00	33.3%	\$10,000	
3		M	Air/Gas Diffusion Equipment	\$44,640.00				\$44,640.00	100.0%		
3		L	Air/Gas Diffusion Equipment	\$30,000.00						\$30,000	
3		L	Startup & Testing	\$5,000.00						\$5,000	
3		M	Level Sensor	\$5,000.00		\$4,900.00		\$5,000.00	100.0%		
3		L	Level Sensor	\$1,500.00			\$1,500.00	\$1,500.00	100.0%		
3		M	12" DIP	\$5,000.00		\$5,000.00		\$5,000.00	100.0%		
3		L	12" DIP	\$3,000.00		\$1,500.00		\$1,500.00	50.0%	\$1,500	
3		M	12" SS Air Pipe	\$5,000.00		\$2,500.00		\$2,500.00	50.0%	\$2,500	
3		L	12" SS Air Pipe	\$3,000.00						\$3,000	
3	M	2" SCH 80 Hot Dip Galv. Pipe	\$1,500.00						\$1,500		
3	L	2" SCH 80 Hot Dip Galv. Pipe	\$1,500.00						\$1,500		
3	M	Monitor Hydrants	\$6,000.00						\$6,000		
3	L	Monitor Hydrants	\$3,000.00						\$3,000		
3	M	Washdown/Post Hydrant	\$4,000.00						\$4,000		
3	L	Washdown/Post Hydrant	\$2,000.00						\$2,000		
3	M	Electrical Wiring & Conduit	\$10,000.00		\$5,000.00		\$3,500.00	85.0%	\$1,500		

**Progress Estimate - Lump Sum Work**

For (Contract):	Lincoln CSO Improvements	Application Number:	14
Application Period:	Through 9/30/2021	Application Date:	9/30/2021

Structure	Bid Item No.	Material/Labor	A Description	Work Completed			E Materials Presently Stored (not in C or D)	F		G Balance to Finish (B - F)
				B Scheduled Value (\$)	C From Previous Application (C+D)	D This Period		Total Completed and Stored to Date (C + D + E)	% (F / B)	
	3	L	Electrical Wiring & Conduit	\$15,000.00	\$7,500.00	\$5,000.00		\$12,500.00	83.3%	\$2,500
	3	M	Safety Switches/Local Disconnect	\$4,000.00		\$2,000.00		\$2,000.00	50.0%	\$2,000
	3	L	Safety Switches/Local Disconnect	\$4,000.00		\$2,000.00		\$2,000.00	50.0%	\$2,000
	3	M	Excavation/Backfill	\$15,000.00	\$15,000.00			\$15,000.00	100.0%	
	3	L	Excavation/Backfill	\$20,000.00	\$20,000.00			\$20,000.00	100.0%	
	3	M	Concrete Forming, Placing, Curing & Finishing - Slabs	\$6,000.00	\$6,000.00			\$6,000.00	100.0%	
	3	L	Concrete Forming, Placing, Curing & Finishing - Slabs	\$10,000.00	\$10,000.00			\$10,000.00	100.0%	
	3	M	Concrete Forming, Placing, Curing & Finishing - Walls	\$8,000.00	\$8,000.00			\$8,000.00	100.0%	
	3	L	Concrete Forming, Placing, Curing & Finishing - Walls	\$15,000.00	\$15,000.00			\$15,000.00	100.0%	
	3	M	Concrete Reinforcing	\$5,000.00	\$5,000.00			\$5,000.00	100.0%	
	3	L	Concrete Reinforcing	\$6,500.00	\$6,500.00			\$6,500.00	100.0%	
	3	M	Misc. Concrete/Equipment Pads	\$4,000.00	\$4,000.00			\$4,000.00	100.0%	
	3	L	Misc. Concrete/Equipment Pads	\$6,000.00	\$6,000.00			\$6,000.00	100.0%	
	3	M	Steel Joists & Decking	\$10,000.00	\$10,000.00			\$10,000.00	100.0%	
	3	L	Steel Joists & Decking	\$15,000.00	\$15,000.00			\$15,000.00	100.0%	
	3	M	Misc. Metals	\$5,000.00	\$5,000.00			\$5,000.00	100.0%	
	3	L	Misc. Metals	\$2,500.00	\$2,500.00			\$2,500.00	100.0%	
	3	M	Masonry	\$50,000.00	\$50,000.00			\$50,000.00	100.0%	
	3	L	Masonry	\$70,000.00	\$70,000.00			\$70,000.00	100.0%	
	3	M	Insulation	\$3,000.00	\$3,000.00			\$3,000.00	100.0%	
	3	L	Insulation	\$5,000.00	\$5,000.00			\$5,000.00	100.0%	
	3	M	Roofing	\$8,000.00	\$8,000.00			\$8,000.00	100.0%	
	3	L	Roofing	\$15,000.00	\$15,000.00			\$15,000.00	100.0%	
	3	M	Miso. Carpentry	\$3,000.00	\$2,000.00	\$1,000.00		\$3,000.00	100.0%	
	3	L	Miso. Carpentry	\$5,000.00	\$3,000.00	\$2,000.00		\$5,000.00	100.0%	
	3	M	Hollow Metal Doors & Frames	\$6,500.00	\$6,500.00			\$6,500.00	100.0%	
	3	L	Hollow Metal Doors & Frames	\$2,500.00	\$2,500.00			\$2,500.00	100.0%	
	3	M	Overhead Door	\$6,500.00						\$6,500
	3	L	Overhead Door	\$3,000.00						\$3,000
	3	M	Paint/Coatings	\$5,000.00						\$5,000
	3	L	Paint/Coatings	\$8,000.00						\$8,000
	3	M	Rotary Lobe Blowers	\$57,000.00	\$57,000.00			\$57,000.00	100.0%	
	3	L	Rotary Lobe Blowers	\$10,000.00	\$10,000.00			\$10,000.00	100.0%	
	3	L	Startup & Testing	\$5,000.00		\$1,000.00		\$5,000.00	100.0%	
	3	M	10" SS Air Pipe	\$33,000.00	\$33,000.00			\$33,000.00	100.0%	
	3	L	10" SS Air Pipe	\$20,000.00	\$20,000.00			\$20,000.00	100.0%	
	3	M	Process Valves & Sleeves & Fittings	\$10,000.00	\$10,000.00			\$10,000.00	100.0%	
	3	L	Process Valves & Sleeves & Fittings	\$10,000.00	\$10,000.00			\$10,000.00	100.0%	
	3	M	HVAC - Ductless Split Type Air Conditioner	\$4,500.00	\$4,500.00			\$4,500.00	100.0%	
	3	L	HVAC - Ductless Split Type Air Conditioner	\$1,500.00	\$500.00	\$1,000.00		\$1,500.00	100.0%	
	3	M	HVAC - Louver	\$2,000.00	\$2,000.00			\$2,000.00	100.0%	
	3	L	HVAC - Louver	\$1,500.00	\$1,500.00			\$1,500.00	100.0%	
	3	M	HVAC - Fan	\$1,500.00	\$1,500.00			\$1,500.00	100.0%	
	3	L	HVAC - Fan	\$1,500.00	\$1,500.00			\$1,500.00	100.0%	
	3	M	Electric Unit Heater	\$1,500.00	\$1,500.00			\$1,500.00	100.0%	
	3	L	Electric Unit Heater	\$1,000.00	\$1,000.00			\$1,000.00	100.0%	
	3	L	HVAC Test & Balance	\$2,000.00						\$2,000
	3	M	Electrical Wiring & Conduit	\$20,000.00	\$17,000.00	\$1,500.00		\$18,500.00	92.5%	\$1,500
	3	L	Electrical Wiring & Conduit	\$50,000.00	\$42,000.00	\$4,000.00		\$46,000.00	92.0%	\$4,000
	3	M	MCC	\$185,000.00	\$185,000.00			\$185,000.00	100.0%	
	3	L	MCC	\$30,000.00	\$30,000.00			\$30,000.00	100.0%	
	3	M	Generator & ATS	\$165,000.00	\$165,000.00			\$165,000.00	100.0%	
	3	L	Generators & ATS	\$20,000.00	\$20,000.00			\$20,000.00	100.0%	
	3	M	Programmable Logic Controller	\$25,000.00	\$25,000.00			\$25,000.00	100.0%	
	3	L	Programmable Logic Controller	\$10,000.00	\$7,500.00	\$1,500.00		\$9,000.00	90.0%	\$1,000
	3	M	Transformer	\$20,000.00						\$20,000
	3	L	Transformer	\$10,000.00						\$10,000
	3	M	Panelboards/Enclosures	\$5,000.00	\$5,000.00			\$5,000.00	100.0%	

Blower Building

Progress Estimate - Lump Sum Work

For (Contract):		Lincoln CSO Improvements			Application Number:		14				
Application Period:		Through 9/30/2021			Application Date:		9/30/2021				
				Work Completed			E	F		G	
A				B	C	D	Materials Presently Stored (not in C or D)	Total Completed and Stored to Date (C + D + E)	% (F / B)	Balance to Finish (B - F)	
Structure	Bid Item No.	Material/Labor	Description	Scheduled Value (\$)	From Previous Application (C+D)	This Period					
Chemical Feed Building	3	L	Panelboards/Enclosures	\$5,000.00	\$5,000.00			\$5,000.00	100.0%		
	3	M	Misc. Concrete	\$1,000.00	\$1,000.00			\$1,000.00	100.0%		
	3	L	Misc. Concrete	\$2,000.00	\$2,000.00			\$2,000.00	100.0%		
	3	M	Peristaltic Chemical Pumps	\$4,000.00	\$1,613.00			\$38,387.00	\$40,000.00	100.0%	
	3	L	Peristaltic Chemical Pumps	\$4,000.00							\$4,000
	3	M	Electrical Wire & Conduit	\$5,000.00	\$4,000.00				\$4,000.00	80.0%	\$1,000
	3	L	Electrical Wire & Conduit	\$10,000.00	\$8,000.00				\$8,000.00	80.0%	\$2,000
	3	M	Programmable Logic Controller	\$20,000.00	\$20,000.00				\$20,000.00	100.0%	
	3	L	Programmable Logic Controller	\$10,000.00	\$5,500.00				\$5,500.00	55.0%	\$4,500
	3	M	Panelboards/Enclosures	\$1,000.00	\$1,000.00				\$1,000.00	100.0%	
	3	L	Panelboards/Enclosures	\$1,500.00	\$1,000.00				\$1,000.00	66.7%	\$500
	4	L	Building Demo	\$70,000.00	\$70,000.00				\$70,000.00	100.0%	
	4	M	Concrete Forming, Placing, Curing & Finishing - Slabs	\$4,000.00	\$4,000.00				\$4,000.00	100.0%	
	4	L	Concrete Forming, Placing, Curing & Finishing - Slabs	\$8,000.00	\$8,000.00				\$8,000.00	100.0%	
	4	M	Concrete Forming, Placing, Curing & Finishing - Walls	\$3,000.00	\$3,000.00				\$3,000.00	100.0%	
	4	L	Concrete Forming, Placing, Curing & Finishing - Walls	\$6,000.00	\$6,000.00				\$6,000.00	100.0%	
	4	M	Concrete Forming, Placing, Curing & Finishing - Exterior Stairs & Ramp	\$4,000.00	\$4,000.00				\$4,000.00	100.0%	
	4	L	Concrete Forming, Placing, Curing & Finishing - Exterior Stairs & Ramp	\$10,000.00	\$10,000.00				\$10,000.00	100.0%	
	4	M	Concrete Reinforcing	\$2,000.00	\$2,000.00				\$2,000.00	100.0%	
	4	L	Concrete Reinforcing	\$5,000.00	\$5,000.00				\$5,000.00	100.0%	
	4	M	Misc. Concrete	\$2,000.00	\$1,000.00	\$1,000.00			\$2,000.00	100.0%	
	4	L	Misc. Concrete	\$3,000.00	\$1,500.00		\$1,500.00		\$3,000.00	100.0%	
	4	M	Concrete Paving & Sidewalks	\$2,500.00		\$2,500.00			\$2,500.00	100.0%	
	4	L	Concrete Paving & Sidewalks	\$5,000.00		\$5,000.00			\$5,000.00	100.0%	
	4	M	Structural Beams	\$10,000.00	\$10,000.00				\$10,000.00	100.0%	
	4	L	Structural Beams	\$20,000.00	\$20,000.00				\$20,000.00	100.0%	
	4	M	Misc. Metals	\$8,000.00	\$8,000.00				\$8,000.00	100.0%	
	4	L	Misc. Metals	\$4,000.00	\$4,000.00				\$4,000.00	100.0%	
	4	M	Handrail	\$5,000.00		\$1,500.00			\$1,500.00	30.0%	\$3,500
	4	L	Handrail	\$5,000.00		\$1,500.00			\$1,500.00	30.0%	\$3,500
	4	M	Bituminous Asphalt Paving/Patch - Lab Building	\$4,500.00							\$4,500
	4	L	Bituminous Asphalt Paving/Patch - Lab Building	\$4,000.00							\$4,000
	4	M	Masonry	\$30,000.00	\$30,000.00				\$30,000.00	100.0%	
4	L	Masonry	\$55,000.00	\$55,000.00				\$55,000.00	100.0%		
4	M	Insulation	\$4,000.00	\$4,000.00				\$4,000.00	100.0%		
4	L	Insulation	\$6,000.00	\$6,000.00				\$6,000.00	100.0%		
4	M	Roofing	\$20,000.00	\$18,000.00				\$18,000.00	90.0%	\$2,000	
4	L	Roofing	\$30,000.00	\$27,000.00				\$27,000.00	90.0%	\$3,000	
4	M	Windows	\$38,000.00	\$13,200.00				\$13,200.00	34.7%	\$24,800	
4	L	Windows	\$16,000.00	\$6,000.00				\$6,000.00	37.5%	\$10,000	
4	M	Cold Formed Metal Framing & Gypsum Board	\$25,000.00	\$13,500.00	\$11,500.00			\$25,000.00	100.0%		
4	L	Cold Formed Metal Framing & Gypsum Board	\$10,000.00	\$5,000.00	\$5,000.00			\$10,000.00	100.0%		
4	M	Acoustical Ceiling System	\$15,000.00		\$4,000.00			\$4,000.00	26.7%	\$11,000	
4	L	Acoustical Ceiling System	\$5,000.00		\$1,000.00			\$1,000.00	20.0%	\$4,000	
4	M	Resilient Tile Flooring	\$4,000.00				\$2,663.00	\$2,663.00	66.6%	\$1,337	
4	L	Resilient Tile Flooring	\$2,000.00							\$2,000	
4	M	Metal Doors & Frames	\$7,000.00	\$6,999.68	\$0.32			\$7,000.00	100.0%		
4	L	Metal Doors & Frames	\$4,000.00	\$3,000.00				\$3,000.00	75.0%	\$1,000	
4	M	Overhead Door	\$4,000.00							\$4,000	
4	L	Overhead Door	\$2,000.00							\$2,000	
4	M	Sectional Doors	\$3,000.00							\$3,000	
4	L	Sectional Doors	\$1,000.00							\$1,000	
4	M	Metal Lockers	\$4,500.00				\$4,067.00	\$4,067.00	90.4%	\$433.00	
4	L	Metal Lockers	\$2,000.00							\$2,000	
4	M	Laboratory Fume Hood + Lab Casework	\$40,000.00							\$40,000	
4	L	Laboratory Fume Hood + Lab Casework	\$12,000.00							\$12,000	
4	M	Laboratory Glassware Washer	\$17,000.00	\$13,852.00				\$13,852.00	81.5%	\$3,148	
4	L	Laboratory Glassware Washer	\$1,000.00	\$500.00				\$500.00	50.0%	\$500	

enovation

**Progress Estimate - Lump Sum Work**

For (Contract):	Lincoln CSO Improvements	Application Number:	14
Application Period:	Through 9/30/2021	Application Date:	9/30/2021

Structure	Bid Item No.	Material/Labor	A Description	B Scheduled Value (\$)	Work Completed		E Materials Presently Stored (not in C or D)	F		G Balance to Finish (B - F)	
					C From Previous Application (C+D)	D This Period		Total Completed and Stored to Date (C + D + E)	% (F / B)		
Alternate #1 - Lab Building R	4	M	Roller Window Treatments	\$4,500.00		\$1,000.00		\$1,000.00	22.2%	\$3,500	
	4	L	Roller Window Treatments	\$1,000.00						\$1,000	
	4	M	Misc. Carpentry	\$8,000.00	\$4,000.00	\$1,500.00		\$5,500.00	68.8%	\$2,500	
	4	L	Misc. Carpentry	\$9,500.00	\$5,000.00	\$1,500.00		\$6,500.00	68.4%	\$3,000	
	4	M	Painting/Coating	\$8,000.00							\$8,000
	4	L	Painting/Coating	\$12,000.00							\$12,000
	4	M	6" BLDG Service Sewer	\$6,000.00							\$6,000
	4	L	6" BLDG Service Sewer	\$2,500.00							\$2,500
	4	M	18" Sewer	\$20,000.00							\$20,000
	4	L	18" Sewer	\$10,000.00							\$10,000
	4	M	Sanitary Piping	\$8,000.00							\$8,000
	4	L	Sanitary Piping	\$10,000.00							\$10,000
	4	M	Manholes	\$4,000.00							\$4,000
	4	L	Manholes	\$2,000.00							\$2,000
	4	M	NG Meter Disconnect/Relocate	\$1,000.00	\$1,000.00			\$1,000.00	100.0%		
	4	L	NG Meter Disconnect/Relocate	\$1,000.00	\$1,000.00			\$1,000.00	100.0%		
	4	M	NG Piping & Valves	\$5,000.00		\$5,000.00		\$5,000.00	100.0%		
	4	L	NG Piping & Valves	\$5,000.00		\$4,000.00		\$4,000.00	80.0%	\$1,000	
	4	M	Vent Pipe	\$5,000.00	\$5,000.00			\$5,000.00	100.0%		
	4	L	Vent Pipe	\$5,000.00	\$5,000.00			\$5,000.00	100.0%		
	4	M	Floor Drains	\$2,000.00	\$2,000.00			\$2,000.00	100.0%		
	4	L	Floor Drains	\$2,000.00	\$1,000.00			\$1,000.00	50.0%	\$1,000	
	4	M	Water Piping (HW & CW)	\$8,000.00	\$8,000.00			\$8,000.00	100.0%		
	4	L	Water Piping (HW & CW)	\$15,000.00	\$13,500.00			\$13,500.00	90.0%	\$1,500	
	4	M	Reduced Pressure Zone (RPZ) System	\$2,000.00		\$2,000.00		\$2,000.00	100.0%		
	4	L	Reduced Pressure Zone (RPZ) System	\$1,000.00		\$1,000.00		\$1,000.00	100.0%		
	4	M	Hot Water Heater/Expansion Tank	\$5,000.00		\$5,000.00		\$5,000.00	100.0%		
	4	L	Hot Water Heater/Expansion Tank	\$2,500.00		\$2,500.00		\$2,500.00	100.0%		
	4	M	Restroom Components/Fixtures	\$10,000.00				\$2,009.00	20.1%	\$7,991	
	4	L	Restroom Components/Fixtures	\$15,000.00							\$15,000
	4	M	HVAC Ductwork & Ductwork Accessories	\$20,000.00	\$18,000.00	\$2,000.00		\$20,000.00	100.0%		
	4	L	HVAC Ductwork & Ductwork Accessories	\$30,000.00	\$27,000.00	\$3,000.00		\$30,000.00	100.0%		
	4	M	Gas Fired Unit Heaters	\$5,500.00	\$5,500.00			\$5,500.00	100.0%		
	4	L	Gas Fired Unit Heaters	\$2,500.00	\$2,500.00			\$2,500.00	100.0%		
	4	M	Electric Unit Heaters	\$2,000.00	\$2,000.00			\$2,000.00	100.0%		
	4	L	Electric Unit Heaters	\$1,500.00	\$1,500.00			\$1,500.00	100.0%		
	4	M	HVAC - Fans	\$6,000.00	\$3,000.00	\$3,000.00		\$6,000.00	100.0%		
	4	L	HVAC - Fans	\$4,000.00	\$2,000.00	\$1,500.00		\$3,500.00	87.5%	\$500	
	4	M	HVAC - Louvers	\$3,000.00	\$1,500.00	\$1,500.00		\$3,000.00	100.0%		
	4	L	HVAC - Louvers	\$3,000.00	\$1,500.00	\$1,000.00		\$2,500.00	83.3%	\$500	
	4	M	Rooftop Air Handling Unit	\$20,000.00	\$20,000.00			\$20,000.00	100.0%		
	4	L	Rooftop Air Handling Unit	\$8,000.00	\$8,000.00			\$8,000.00	100.0%		
	4	L	HVAC Test & Balance	\$5,000.00							\$5,000
	4	M	Panelboards/Enclosures	\$5,000.00	\$5,000.00			\$5,000.00	100.0%		
	4	L	Panelboards/Enclosures	\$8,000.00	\$6,000.00	\$2,000.00		\$8,000.00	100.0%		
4	M	Programmable Logic Controller	\$20,000.00	\$13,646.00	\$6,354.00		\$20,000.00	100.0%			
4	L	Programmable Logic Controller	\$10,000.00		\$5,000.00		\$5,000.00		\$5,000		
4	M	Lighting	\$20,000.00	\$20,000.00			\$20,000.00	100.0%			
4	L	Lighting	\$10,000.00	\$5,000.00	\$2,000.00		\$7,000.00	70.0%	\$3,000		
4	M	Grounding & Bonding	\$5,000.00							\$5,000	
4	L	Grounding & Bonding	\$5,000.00							\$5,000	
4	M	Wiring & Conduit	\$10,000.00	\$8,000.00	\$2,000.00		\$10,000.00	100.0%			
4	L	Wiring & Conduit	\$15,000.00	\$12,000.00	\$1,000.00		\$13,000.00	86.7%	\$2,000		
5	L	Select Demo	\$20,000.00	\$20,000.00			\$20,000.00	100.0%			
5	M	Temporary/Bypass Pumping - Existing Headworks (New Forcemain)	\$10,000.00	\$10,000.00			\$10,000.00	100.0%			
5	L	Temporary/Bypass Pumping - Existing Headworks (New Forcemain)	\$20,000.00	\$20,000.00			\$20,000.00	100.0%			
5	M	Excavation/Backfill/Grading	\$6,500.00	\$3,500.00	\$1,500.00		\$5,000.00	76.9%	\$1,500		
5	L	Excavation/Backfill/Grading	\$10,000.00	\$5,000.00	\$2,500.00		\$7,500.00	75.0%	\$2,500		

**Progress Estimate - Lump Sum Work**

For (Contract):	Lincoln CSO Improvements	Application Number:	14
Application Period:	Through 9/30/2021	Application Date:	9/30/2021

Structure	Bid Item No.	Material/Labor	A Description	Work Completed			B Materials Presently Stored (not in C or D)	F		G Balance to Finish (B - F)
				B Scheduled Value (\$)	C From Previous Application (C+D)	D This Period		Total Completed and Stored to Date (C + D + E)	% (F / B)	
	S	M	Concrete Forming, Placing, Curing & Finishing - Slabs	\$5,000.00		\$5,000.00		\$5,000.00	100.0%	
	S	L	Concrete Forming, Placing, Curing & Finishing - Slabs	\$6,000.00		\$6,000.00		\$6,000.00	100.0%	
	S	M	Concrete Forming, Placing, Curing & Finishing - Walls	\$7,000.00	\$7,000.00			\$7,000.00	100.0%	
	S	L	Concrete Forming, Placing, Curing & Finishing - Walls	\$12,000.00	\$12,000.00			\$12,000.00	100.0%	
	S	M	Concrete Reinforcing	\$2,000.00	\$2,000.00			\$2,000.00	100.0%	
	S	L	Concrete Reinforcing	\$5,000.00	\$3,000.00	\$2,000.00		\$5,000.00	100.0%	
	S	M	Misc. Concrete/Equipment Pads	\$3,500.00		\$1,500.00		\$1,500.00	42.9%	\$2,000
	S	L	Misc. Concrete/Equipment Pads	\$8,000.00		\$3,500.00		\$3,500.00	43.8%	\$4,500
	S	M	Concrete Paving - Headworks	\$15,000.00		\$12,000.00		\$12,000.00	80.0%	\$3,000
	S	L	Concrete Paving - Headworks	\$25,000.00		\$20,000.00		\$20,000.00	80.0%	\$5,000
	S	M	Bituminous Asphalt Paving/Patch - Headworks	\$15,000.00						\$15,000
	S	L	Bituminous Asphalt Paving/Patch - Headworks	\$20,000.00						\$20,000
	S	M	Masonry	\$4,000.00	\$4,000.00			\$4,000.00	100.0%	
	S	L	Masonry	\$7,000.00	\$7,000.00			\$7,000.00	100.0%	
	S	M	Roofing	\$20,000.00						\$20,000
	S	L	Roofing	\$20,000.00						\$20,000
	S	M	Roof Hatch	\$6,500.00	\$6,500.00			\$6,500.00	100.0%	
	S	L	Roof Hatch	\$1,500.00		\$1,500.00		\$1,500.00	100.0%	
	S	M	FRP Doors & Frames	\$14,500.00	\$8,866.08		\$5,633.92	\$14,500.00	100.0%	
	S	L	FRP Doors & Frames	\$4,000.00	\$2,000.00			\$2,000.00	50.0%	\$2,000
	S	M	Overhead Coil Door	\$15,500.00						\$15,500
	S	L	Overhead Coil Door	\$4,000.00						\$4,000
	S	M	Cold Formed Steel Framing	\$15,000.00		\$15,000.00		\$15,000.00	100.0%	
	S	L	Cold Formed Steel Framing	\$7,000.00						\$7,000
	S	M	Misc. Metals	\$10,000.00		\$5,000.00		\$5,000.00	50.0%	\$5,000
	S	L	Misc. Metals	\$5,000.00		\$2,000.00		\$2,000.00	40.0%	\$3,000
	S	M	Steel Beams + Columns + Decking	\$30,000.00	\$30,000.00			\$30,000.00	100.0%	
	S	L	Steel Beams + Columns + Decking	\$25,000.00		\$25,000.00		\$25,000.00	100.0%	
	S	M	Handrail	\$10,000.00						\$10,000
	S	L	Handrail	\$10,000.00						\$10,000
	S	M	Wall Panels/Sheet Metal	\$20,000.00						\$20,000
	S	L	Wall Panels/Sheet Metal	\$30,000.00						\$30,000
	S	M	Misc. Carpentry	\$5,000.00		\$1,500.00		\$1,500.00	30.0%	\$3,500
	S	L	Misc. Carpentry	\$10,000.00		\$3,000.00		\$3,000.00	30.0%	\$7,000
	S	M	Insulation	\$2,000.00						\$2,000
	S	L	Insulation	\$7,000.00						\$7,000
	S	M	Painting/Coating	\$8,000.00						\$8,000
	S	L	Painting/Coating	\$10,000.00						\$10,000
	S	M	20" Pipe Infill	\$3,000.00	\$3,000.00			\$3,000.00	100.0%	
	S	L	20" Pipe Infill	\$5,000.00	\$5,000.00			\$5,000.00	100.0%	
	S	M	Raw Water Meter Vault	\$10,000.00	\$10,000.00			\$10,000.00	100.0%	
	S	L	Raw Water Meter Vault	\$8,000.00	\$8,000.00			\$8,000.00	100.0%	
	S	M	Aluminum Ladder	\$2,000.00	\$2,000.00			\$2,000.00	100.0%	
	S	L	Aluminum Ladder	\$1,000.00	\$1,000.00			\$1,000.00	100.0%	
	S	M	20" Raw Water Pipe - DIP	\$55,000.00	\$55,000.00			\$55,000.00	100.0%	
	S	L	20" Raw Water Pipe - DIP	\$50,000.00	\$50,000.00			\$50,000.00	100.0%	
	S	M	Trench Drains	\$10,000.00	\$2,197.00	\$7,803.00		\$10,000.00	100.0%	
	S	L	Trench Drains	\$8,000.00		\$8,000.00		\$8,000.00	100.0%	
	S	M	Manhole	\$5,000.00		\$5,000.00		\$5,000.00	100.0%	
	S	L	Manhole	\$2,000.00						\$2,000
	S	M	4" PVC Process Pipe	\$2,000.00		\$2,000.00		\$2,000.00	100.0%	
	S	L	4" PVC Process Pipe	\$4,000.00		\$3,000.00		\$3,000.00	75.0%	\$1,000
	S	M	12" RCP Storm Sewer	\$20,000.00		\$20,000.00		\$20,000.00	100.0%	
	S	L	12" RCP Storm Sewer	\$15,000.00		\$15,000.00		\$15,000.00	100.0%	
	S	L	Grit Drain Relocation	\$1,500.00		\$1,500.00		\$1,500.00	100.0%	
	S	L	Hydrant Relocation	\$1,500.00		\$1,500.00		\$1,500.00	100.0%	
	S	L	Process Pipe Pressure Testing	\$5,000.00						\$5,000
	S	M	Flowmeter	\$12,000.00	\$12,000.00			\$12,000.00	100.0%	

Alternate #2 - Existing Headworks Building Addition

Progress Estimate - Lump Sum Work

For (Contract): Lincoln CSO Improvements				Application Number: 14							
Application Period: Through 9/30/2021				Application Date: 9/30/2021							
				Work Completed		E	F		G		
Structure	Bid Item No.	Material/Labor	Description	B Scheduled Value (\$)	C From Previous Application (C+D)	D This Period	Materials Presently Stored (not in C or D)	Total Completed and Stored to Date (C + D + E)	% (F / B)	Balance to Finish (B - F)	
	5	L	Flowmeter	\$5,000.00	\$5,000.00			\$5,000.00	100.0%		
	5	M	HVAC Ductwork & Ductwork Accessories	\$8,500.00		\$2,000.00		\$2,000.00	23.5%	\$6,500	
	5	L	HVAC Ductwork & Ductwork Accessories	\$10,000.00		\$1,000.00		\$1,000.00	10.0%	\$9,000	
	5	M	HVAC - Louvers	\$5,000.00		\$5,000.00		\$5,000.00	100.0%		
	5	L	HVAC - Louvers	\$3,000.00						\$3,000	
	5	M	HVAC - Fans	\$8,500.00			\$8,350.00	\$8,350.00	98.2%	\$150	
	5	L	HVAC - Fans	\$3,500.00						\$3,500	
	5	L	HVAC Test & Balance	\$5,000.00						\$5,000	
	5	M	Electric Unit Heaters	\$20,000.00	\$15,000.00			\$15,000.00	75.0%	\$5,000	
	5	L	Electric Unit Heaters	\$6,000.00		\$3,000.00		\$3,000.00	50.0%	\$3,000	
	5	M	Gas Detection System	\$23,000.00			\$22,500.00	\$22,500.00	97.8%	\$500	
	5	L	Gas Detection System	\$6,000.00						\$6,000	
	5	M	Electrical Wiring & Conduit	\$18,000.00		\$5,000.00		\$5,000.00	27.8%	\$13,000	
	5	L	Electrical Wiring & Conduit	\$25,000.00		\$5,000.00		\$5,000.00	20.0%	\$20,000	
	5	M	Panelboards/Enclosures	\$2,500.00	\$2,500.00			\$2,500.00	100.0%		
	5	L	Panelboards/Enclosures	\$5,000.00						\$5,000	
	5	M	Lighting	\$15,000.00	\$15,000.00			\$15,000.00	100.0%		
	5	L	Lighting	\$10,000.00		\$2,500.00		\$2,500.00	25.0%	\$7,500	
	5	M	Grounding & Bonding	\$2,500.00						\$2,500	
	5	L	Grounding & Bonding	\$4,500.00						\$4,500	
Alternate #3 - Grit Classifier Equipment	6	M	Screening Washer & Compacting Equipment + Grit Classifier	\$92,383.00	\$87,764.00	\$4,619.00		\$92,383.00	100.0%		
	6	L	Screening Washer & Compacting Equipment + Grit Classifier	\$15,000.00		\$10,000.00		\$10,000.00	66.7%	\$5,000	
	6	M	4" DI Compactor Drain	\$2,000.00						\$2,000	
	6	L	4" DI Compactor Drain	\$3,000.00						\$3,000	
	6	M	3/4" PVC - Plant Water	\$1,000.00						\$1,000	
	6	L	3/4" PVC - Plant Water	\$1,500.00						\$1,500	
	6	M	4" DI Grit Slurry	\$2,000.00	\$516.00	\$1,484.00		\$2,000.00	100.0%		
	6	L	4" DI Grit Slurry	\$3,000.00		\$1,500.00		\$1,500.00	50.0%	\$1,500	
	6	M	6" DI Classifier Effluent	\$4,000.00	\$1,594.40	\$2,405.60		\$4,000.00	100.0%		
	6	L	6" DI Classifier Effluent	\$6,000.00		\$5,000.00		\$5,000.00	83.3%	\$1,000	
	6	L	Startup/Testing	\$2,500.00							\$2,500
	6	M	Electrical Wire & Conduit	\$5,000.00		\$2,000.00		\$2,000.00	40.0%	\$3,000	
6	L	Electrical Wire & Conduit	\$10,000.00							\$10,000	
Alternate #4 - Secondary Clarifier Mechanism	7	L	Demo Existing Clarifier Equipment	\$60,000.00	\$30,000.00			\$30,000.00	50.0%	\$30,000	
	7	L	Demo Grout	\$30,000.00	\$15,000.00			\$15,000.00	50.0%	\$15,000	
	7	L	Concrete Tank Cleaning	\$10,000.00	\$5,000.00			\$5,000.00	50.0%	\$5,000	
	7	M	Circular Clarifier Equipment	\$291,402.00	\$276,832.00			\$276,832.00	95.0%	\$14,570	
	7	L	Circular Clarifier Equipment	\$100,000.00	\$10,000.00	\$40,000.00		\$50,000.00	50.0%	\$50,000	
	7	M	Grout	\$15,000.00						\$15,000	
	7	L	Grout	\$30,000.00						\$30,000	
	7	M	Fiberglass Weirs & Baffles + Density Current Baffles	\$41,050.00	\$41,050.00			\$41,050.00	100.0%		
	7	L	Fiberglass Weirs & Baffles + Density Current Baffles	\$30,000.00		\$15,000.00		\$15,000.00	50.0%	\$15,000	
	7	M	Painting/Coating	\$15,000.00	\$13,500.00	\$1,500.00		\$15,000.00	100.0%		
	7	L	Painting/Coating	\$25,000.00	\$22,500.00			\$22,500.00	90.0%	\$2,500	
	7	M	Lighting	\$2,000.00	\$2,000.00			\$2,000.00	100.0%		
	7	L	Lighting	\$3,000.00		\$1,500.00		\$1,500.00	50.0%	\$1,500	
	7	M	Electrical Wiring & Conduit	\$3,000.00		\$1,500.00		\$1,500.00	50.0%	\$1,500	
	7	L	Electrical Wiring & Conduit	\$5,000.00		\$2,500.00		\$2,500.00	50.0%	\$2,500	
	7	M	6" DIP	\$2,000.00							\$2,000
	7	L	6" DIP	\$3,000.00							\$3,000
7	L	Startup/Testing	\$5,000.00							\$5,000	
Change Order NO 1			Change in material of the base plate in the swirl concentrator from galv. To SS	\$1,312.50		\$1,312.50		\$1,312.50	100.0%		
Change Order NO 2			Increase pile length, add grout to Swirl Tank Effluent Box, and increase hanger size	\$16,025.50		\$16,025.50		\$16,025.50	100.0%		
Change Order NO 3			Lab Building Redesign	\$17,748.73		\$17,748.73		\$17,748.73	100.0%		
Change Order NO 4			Lab Garage Wet Well Hatch	\$3,536.00		\$3,536.00		\$3,536.00	100.0%		
Change Order NO 5			Lab Building Wet Well Modifications	\$4,934.00		\$4,934.00		\$4,934.00	100.0%		
Change Order NO 6			Cost Reduction for Electrically Actuated Mud Valves + Add for Owner Requested Work	(\$2,229.00)		(\$2,229.00)		(\$2,229.00)	100.0%		
Change Order NO 7			Ductbank Reroute	\$58,726.00		\$58,726.00		\$58,726.00	100.0%		



**Progress Estimate - Lump Sum Work**

For (Contract): Lincoln CSO Improvements				Application Number: 14						
Application Period: Through 9/30/2021				Application Date: 9/30/2021						
				Work Completed		E	F		G	
A				B	C	D	Materials Presently Stored (not in C or D)	Total Completed and Stored to Date (C + D + E)	% (F / B)	Balance to Finish (B - F)
Structure	Bid Item No.	Material/Labor	Description	Scheduled Value (\$)	From Previous Application (C+D)	This Period				
<b>Totals</b>				\$13,408,853.73	\$11,295,093.98	\$568,887.67	\$128,249.92	\$11,902,231.57	88.8%	\$1,497,822.16



## Stored Material Summary

For (Contract):		Lincoln CSO Improvements						Application Number:		14	
Application Period:		Through 9/30/2021						Application Date:		9/30/2021	
Bid Item No.	Supplier Invoice No.	Submittal No. (with Specification Section No.)	Storage Location	Description of Materials or Equipment Stored	D		E	Subtotal Amount Completed and Stored to Date (D + E)	F		G
					Stored Previously				Incorporated in Work		
					Date Placed into Storage (Month/Year)	Amount (\$)	Amount Stored this Month (\$)		Date (Month/Year)	Amount (\$)	Materials Remaining in Storage (\$) (D + E - F)
5	12781	014 (05 50 00)	Onsite	Raw Water Meter Hatch & Ladder	8/2020	\$1,791.87		\$1,791.87	6/2021	\$1,791.87	
3			Onsite	Bridge Piling	8/2020	\$30,000.00		\$30,000.00	1/2021	\$30,000.00	
3	2022101	034 (03 20 00)	Onsite	Bridge Abutment Rebar	8/2020	\$1,450.00		\$1,450.00	1/2021	\$1,450.00	
3	21627843	016 (B-101)	Onsite	Precast Bridge Culvert	10/2020	\$92,997.90		\$92,997.90	2/2021	\$92,997.90	
3	002073	036 (33 37 23)	Onsite	Hydrobrake Flow Regulator	10/2020	\$16,245.00		\$16,245.00	5/2021	\$16,245.00	
3	1400080	057 (46 33 44)	Onsite	Peristaltic Pumps & Chemical Skid	10/2020	\$38,387.00		\$38,387.00			\$38,387.00
3	2022102	038 (03 20 00)	Onsite	Blower/Electrical Building Rebar	10/2020	\$3,940.00		\$3,940.00	3/2021	\$3,940.00	
3	2022102	047 (03 20 00)	Onsite	Swirl Concentrator Wall Rebar	10/2020	\$18,000.00		\$18,000.00	11/2020	\$18,000.00	
3	2041019911	026 (33 05 00)	Onsite	Hobas Pipe	12/2021	\$360,271.08		\$360,271.08	2/2021	\$360,271.08	
5	856697	074 (33 05 00)	Onsite	20" DIP - Raw Water Main	10/2020	\$34,646.00		\$34,646.00	6/2021	\$34,646.00	
3	856559	074 (33 05 00)	Onsite	20" DIP - Swirl Underflow Line	10/2020	\$22,445.24		\$22,445.24	12/2020	\$22,445.24	
3	856559	074 (33 05 00)	Onsite	12" DIP - First Flush Tank Drain Line	10/2020	\$6,977.73		\$6,977.73	6/2021	\$6,977.73	
3	MULT	074 (33 05 00)	Onsite	12" DIP - First Flush Aeration Pipe	10/2020	\$25,496.70		\$25,496.70	8/2021	\$25,496.70	
3	856559	027 (33 05 00)	Onsite	4" PVC Plant Water Pipe	10/2020	\$1,532.42		\$1,532.42	8/2021	\$1,532.42	
3	856695	074 (33 05 00)	Onsite	12" DIP - First Flush	10/2020	\$1,596.00		\$1,596.00	8/2021	\$1,596.00	
6	856695	074 (33 05 00)	Onsite	DIP - Grit Classifier Effluent Pipe	10/2020	\$1,594.40		\$1,594.40	9/2021	\$1,594.40	
3	MULT	074 (33 05 00)	Onsite	12" DIP - Pump STA Drain Pipe	11/2020	\$7,731.86		\$7,731.86	2/2021	\$7,731.86	
3	3498976	042 (33 05 61)	Onsite	Sherman Dry Sewer Manhole Structures	11/2020	\$6,206.95		\$6,206.95	2/2021	\$6,206.95	
MULT	746913	022 (08 11 13)	Warehouse	Doors & Hardware	11/2020	\$16,901.72		\$16,901.72	8/2021	\$11,267.80	\$5,633.92
6	858643	074 (33 05 00)	Onsite	4" DIP - Grit Slurry Line	11/2020	\$516.00		\$516.00	9/2021	\$516.00	
3	MULT	074 (33 05 00)	Onsite	24" DIP - Underflow to 1st Flush Tank	11/2020	\$11,606.84		\$11,606.84	8/2021	\$11,606.84	
3	858643	074 (33 05 00)	Onsite	10" DIP - Screen & Pump STA	11/2020	\$1,753.87		\$1,753.87	1/2021	\$1,753.87	
3	5494671	008 (46 41 23)	Onsite	Submersible Mixers + Hardware	11/2020	\$80,000.00		\$80,000.00	9/2021	\$80,000.00	
3	5494666	017 (43 24 13)	Onsite	Axial Flow Pump Tubes	11/2020	\$217,594.00		\$217,594.00	1/2021	\$217,594.00	
3	5494671	007 (43 24 11)	Onsite	Submersible Pumps (6" & 10") + Hardware	11/2020	\$143,363.00		\$143,363.00	2/2021	\$143,363.00	
3		087 (23 82 18)	Standard H&C Warehouse	Blower BLDG - Ductless AC Unit	11/2020	\$4,500.00		\$4,500.00	6/2021	\$4,500.00	
3		086 (23 82 00)	Standard H&C Warehouse	Blower BLDG - Electric Unit Heater	11/2020	\$1,400.00		\$1,400.00	8/2021	\$1,400.00	
4		083 (23 55 00)	Standard H&C Warehouse	Lab BLDG - Gas Fired Unit Heaters	11/2020	\$5,200.00		\$5,200.00	8/2021	\$5,200.00	
5		082 (23 37 00)	Standard H&C Warehouse	Headworks - Fans	11/2020	\$8,350.00		\$8,350.00			\$8,350.00
5		086 (23 82 00)	Standard H&C Warehouse	Headworks - Electric Unit Heaters	11/2020	\$15,000.00		\$15,000.00	9/2021	\$15,000.00	
3	5497028	017 (43 24 13)	Onsite	Axial Flow Pumps	12/2020	\$302,327.00		\$302,327.00	5/2021	\$302,327.00	
3	21193 & 21308	065 (05 50 00)	Onsite	Screen & Pump STA Steel	12/2020	\$85,000.00		\$85,000.00	8/2021	\$85,000.00	
3	4283408/4279941	029 (40 05 29)	Onsite	Slide Gates	12/2020	\$119,311.00		\$119,311.00	2/2021	\$119,311.00	
7	20066-1	017 (43 24 13)	Onsite	Fiberglass Clarifier Weirs & Scum Baffles	12/2020	\$15,810.00		\$15,810.00	9/2021	\$15,810.00	
5	748677	022 (08 34 00)	Onsite	Fiberglass Doors & Frames	1/2021	\$8,419.28		\$8,419.28	8/2021	\$8,419.28	
3	21000201R105000	021 (33 73 33)	Onsite	Swirl Concentrator Equipment	1/2021	\$232,260.00		\$232,260.00	2/2021	\$232,260.00	
7	20066-2	017 (43 24 13)	Onsite	Fiberglass Density Current Baffles	1/2021	\$24,480.00		\$24,480.00	9/2021	\$24,480.00	
3	21308.00	043 (05 21 00)	Onsite	Steel Joists & Decking	1/2021	\$9,010.00		\$9,010.00	5/2021	\$9,010.00	
3	N320000	074 (33 05 00)	Onsite	8" Chlorine Tank Drain	1/2021	\$463.20		\$463.20	6/2021	\$463.20	
3	N320000	074 (33 05 00)	Onsite	6" DIP Drain Pump Pipe	1/2021	\$682.50		\$682.50	4/2021	\$682.50	
3	N320000	074 (33 05 00)	Onsite	12" DIP Underflow Pump Pipe	1/2021	\$3,313.00		\$3,313.00	4/2021	\$3,313.00	
3	020537	090 (46 21 17)	Onsite	Mechanical Catenary Bar Screen	1/2021	\$147,858.00		\$147,858.00	3/2021	\$147,858.00	
3	21308.00	056 (05 50 00)	Onsite	Channel Diversion STR Bar Grate & Weir	1/2021	\$15,000.00		\$15,000.00	3/2021	\$15,000.00	

## Stored Material Summary

For (Contract):		Lincoln CSO Improvements					Application Number:		14		
Application Period:		Through 9/30/2021					Application Date:		9/30/2021		
Bid Item No.	A Supplier Invoice No.	B Submittal No. (with Specification Section No.)	C Storage Location	Description of Materials or Equipment Stored	D Stored Previously		E Amount Stored (this Month (\$))	Subtotal Amount Completed and Stored to Date (D + E)	F Incorporated in Work		G Materials Remaining in Storage (\$) (D + E - F)
					Date Placed into Storage (Month/Year)	Amount (\$)			Date (Month/ Year)	Amount (\$)	
3	21308.00	104 (05 52 00)	Onsite	Swirl Concentrator Handrail	1/2021	\$5,295.00		\$5,295.00	5/2021	\$5,295.00	
3	10881 & 10884	113 (40 72 00)	Onsite	Level Sensors	2/2021	\$31,050.00		\$31,050.00	5/2021	\$31,050.00	
3	4296294 & 4293131	079 (40 05 57)	Onsite	Slide Gate Electric Actuators	2/2021	\$37,534.00		\$37,534.00	3/2021	\$37,534.00	
3	2022105R	040 (03 20 00)	Onsite	Channel Diversion Structure Rebar	2/2021	\$8,280.00		\$8,280.00	3/2021	\$8,280.00	
3	16876	062 (43 11 33)	Onsite	Rotary Lobe Blowers	2/2021	\$57,000.00		\$57,000.00	5/2021	\$57,000.00	
3	21339	066 (05 50 00)	Onsite	Swirl Concentrator Beams & Stairs	2/2021	\$45,000.00		\$45,000.00	4/2021	\$45,000.00	
3	21339	054 (05 50 00)	Onsite	Blower Building Misc. Metals	2/2021	\$5,000.00		\$5,000.00	5/2021	\$5,000.00	
3	2022105R	(03 20 00)	Onsite	Electrical Ductbank Rebar	2/2021	\$878.52		\$878.52	4/2021	\$878.52	
3	20066-3	105 (33 12 53)	Onsite	Chlorine Tank Baffle Wall System	3/2021	\$231,380.00		\$231,380.00	4/2021	\$231,380.00	
3&4	11163	115 (40 63 43)	Onsite	PLC Panels	4/2021	\$53,773.00		\$53,773.00	6/2021	\$53,773.00	
4	8493	053 (09 65 19)	RFC Warehouse	Resilient Tile Flooring	4/2021	\$2,663.00		\$2,663.00			\$2,663.00
3	231987	075 (40 05 00)	Onsite	Blower BLDG SS Air Pipe	4/2021	\$20,590.00		\$20,590.00	8/2021	\$20,590.00	
5	S1992115.001	077 (22 10 19)	Onsite	Headworks Trench Drain	4/2021	\$2,197.00		\$2,197.00	9/2021	\$2,197.00	
5	11161 + 11272	114 (28 42 05)	Onsite	Gas Detection System	4/2021	\$22,500.00		\$22,500.00			\$22,500.00
5	11272	113 (40 71 00)	Onsite	Flowmeter	4/2021	\$11,000.00		\$11,000.00	6/2021	\$11,000.00	
5	20432/20433	091 (46 21 73)	Onsite	Grit Classifier & Compactor Equipment	5/2021	\$61,318.00	\$7,970.00	\$69,288.00	9/2021	\$69,288.00	
MULT	MULT	093 (26 50 00)	Egizii Warehouse	Lighting	5/2021	\$41,982.34		\$41,982.34	9/2021	\$41,982.34	
MULT	MULT	059 (26 24 19)	Egizii Warehouse	Electrical Distribution Equipment	5/2021	\$188,413.02		\$188,413.02	6/2021	\$188,413.02	
4	4009	110 (10 51 13)	CSS Warehouse	Metal Lockers	5/2021	\$3,050.25	\$1,016.75	\$4,067.00			\$4,067.00
3	18487	030 (46 51 00)	Onsite	First Flush Tank Aeration System	6/2021	\$44,640.00		\$44,640.00			\$44,640.00
4	12175	012 (10 80 10)	MJ Products	Toilet Accessories	6/2021	\$1,065.00	\$944.00	\$2,009.00			\$2,009.00
4	Picture	084 (23 74 00)	SHC Warehouse	Lab Building Roof Top Air Unit	6/2021	\$20,000.00		\$20,000.00	8/21	\$20,000.00	
5	21458	069 (05 12 00)	Onsite	Headworks Steel Beams & Columns	6/2021	\$30,000.00		\$30,000.00	9/2021	\$30,000.00	
<b>Totals</b>						<b>\$3,066,038.69</b>	<b>\$9,930.75</b>	<b>\$3,075,969.44</b>		<b>\$2,947,719.52</b>	<b>\$128,249.92</b>

PARTIAL WAIVER OF LIEN

STATE OF ILLINOIS     )  
  SS.  
COUNTY OF MADISON )

TO ALL WHOM IT MAY CONCERN:

WHEREAS, the undersigned, Plocher Construction Company, Inc., a corporation, has been employed by City of Lincoln, Illinois, to furnish labor and materials for a project known as:

**Lincoln CSO Improvements**

NOW THEREFORE, the undersigned, for and in consideration of the sum of SIX HUNDRED FOUR THOUSAND TWENTY-FOUR AND 13/100 DOLLARS (\$604,024.13) and other good and valuable considerations, the receipt whereof is hereby acknowledged by the undersigned, does hereby waive and release any and all lien or claim of or right to lien under the statutes of the State of Illinois relating to mechanics' liens, with respect to and on the above-described premises, and the improvements thereon, and on the material, fixtures, apparatus or machinery furnished, and on the moneys or other considerations due or to become due from the owner, on account of labor, services, material, fixtures, apparatus or machinery, furnished by the undersigned to the date hereof only, to or on account of the said contractor or the said owner, for the above-described premises, without prejudice to assert any right of lien as to any labor, services, material, fixtures, apparatus or machinery hereafter furnished by the undersigned.

Dated this 30<sup>TH</sup> day of September 2021



(Affix corporate seal here)

Plocher Construction Company, Inc.

BY

  
\_\_\_\_\_  
Scott Plocher, President

ATTEST:

  
\_\_\_\_\_  
Lisa Scholl, Secretary



Phone: /04-554-839/  
Fax: 704-554-9113

JIM MYERS & SONS, INC.  
PO BOX 38778  
CHARLOTTE NC 28278

Page: 1 of 1  
Date: 7/30/2021

**INVOICE**

Invoice: 20740

**Bill To:**

PLOCHER CONSTRUCTION  
2808 THOLE-POCHER ROAD  
HIGHLAND IL 62249  
USA

**Ship To:**

Kim Lewis  
LINCOLN SEWER TREATMENT PLANT  
150 W KICKAPOO STREET  
LINCOLN IL 62656  
USA

PO Number: 3840-005

Terms: NET 30

F.O.B.: DELIVERY AT PLACE

Sales Rep: RESSLER & ASSOCIATES

Ship Via: TRUCK FREIGHT

Project #: 20042

Ship Date:

LinePart Number/Description	Revision	Quantity	Unit Price	Ext Price
1 Delta-CLASSIFIER DROPSHIP HYDROCYCLONE		0.00	0.00/1	7,970.00

**Payment Schedule**

Due Date	Amount
1 8/29/2021	7,970.00
<b>Total</b>	<b>7,970.00</b>

Line(s) Subtotal: 7,970.00  
 Total Misc Charges: 0.00  
 Total Tax: 0.00  
**Total 7,970.00**



# Invoice

12685

MJ Products, Inc.  
403 Biltmore Drive  
Fenton, MO 63026

SOLD TO PLOCHER CONSTRUCTION  
COMPANY  
2808 THOLE-PLOCHER ROAD  
HIGHLAND, IL 62249

JOB SITE LINCOLN CSO - PO 3840-018  
150 W. KICKAPOO ST  
LINCOLN, IL 62656

JOB NUMBER	PO NUMBER	SALES PERSON	DATE SHIPPED	TERMS	INVOICE DATE
20-60733	3840-018	JOSH HUNT		Net 60	9/15/2021

DESCRIPTION	TOTAL PRICE
GLOBAL TOILET PARTITIONS 1 STALL 1 SCREEN POWDER COATED STEEL COLOR: KHAKI	

**TOTAL AMOUNT 944.00**

### NOTICE TO OWNER

FAILURE OF THIS CONTRACTOR TO PAY THOSE PERSONS SUPPLYING MATERIAL OR SERVICES TO COMPLETE THIS CONTRACT CAN RESULT IN THE FILING OF A MECHANIC'S LIEN ON THE PROPERTY WHICH IS THE SUBJECT OF THIS CONTRACT PURSUANT TO CHAPTER 429, RSMo, TO AVOID THIS RESULT YOU MAY ASK THIS CONTRACTOR FOR "LIEN WAIVERS" FROM ALL PERSONS SUPPLYING MATERIAL OR SERVICES FOR THE WORK DESCRIBED IN THIS CONTRACT. FAILURE TO SECURE LIEN WAIVERS MAY RESULT IN YOUR PAYING FOR LABOR AND MATERIAL TWICE.





## Lincoln CSO Progress through 9/30/2021

Pay App #12 (IEPA Reimbursement #11) is for \$604,024.13.

This month consisted of:

- Plocher completed the headworks pavement, finished the NW clarifier (waiting for manufacturer to test), installed framework for the headworks building, finished concrete for the bridge deck
- Egizii finished wire in the lab and is almost done with the lights
- Tobin completed air piping to the first flush tank

CSO startup of equipment will begin later this month

The following pictures show the work on site:

- Steel framing for headworks building



- Pavement at headworks building



- First flush tank air piping installation



- Clarifier rebuild



## MEMORANDUM

**TO:** Mayor and Aldermen of the City of Lincoln

**FROM:** Walt Landers, Street Superintendent

**MEETING**

**DATE:** October 12, 2021

**RE:** **Additional contingency Funds for 2021 Sidewalk Replacement Project**

---

**Background**

As work has progressed on the sidewalk replacement project, three of the five overall project areas have been completed. The replacement of the sidewalk along Wyatt Avenue with ADA compliant ramps and slopes results in generally flatter sidewalk grades than existing. These flatter slopes create new sidewalk grades lower than the old existing grades, particularly at the intersections of Elliott Street and Ladue Street where new sidewalk elevations are up to two feet lower than the older existing sidewalk. Matching these new sidewalk grades back into the existing grass yards and parkways requires either regrading slopes and/or installation of side curb or walls adjacent to the sidewalk ramps. The awarded bid amount for this project was \$135,500.00.

**Analysis/Discussion**

As construction has progressed, a few areas have been identified where larger curb walls with additional reinforcement may be a better alternative to more extensive yard regrading. By adding these reinforced walls, the Contractor will be able to tie slopes back into the existing yards sooner and with flatter slopes. Two areas have been identified where the additional work, concrete and reinforcing material quantities will be required that don't fall under the scope of the original bid.

- East Quadrant of Wyatt and Eliot – 50 feet (50' on resident side from existing steps around intersection corner)
- North Quadrant of Wyatt and Ladue – 15 feet (resident side)

**Fiscal Impact**

An additional \$5,000.00 for any contingencies that may arise to properly complete the project.

**COW Recommendation**

Approve request and place on the agenda of the October 18, 2021, regular City Council meeting.

**Council Recommendation:**

Approve the request for an additional \$5,000.00 in contingency funds to complete the sidewalk replacement project.









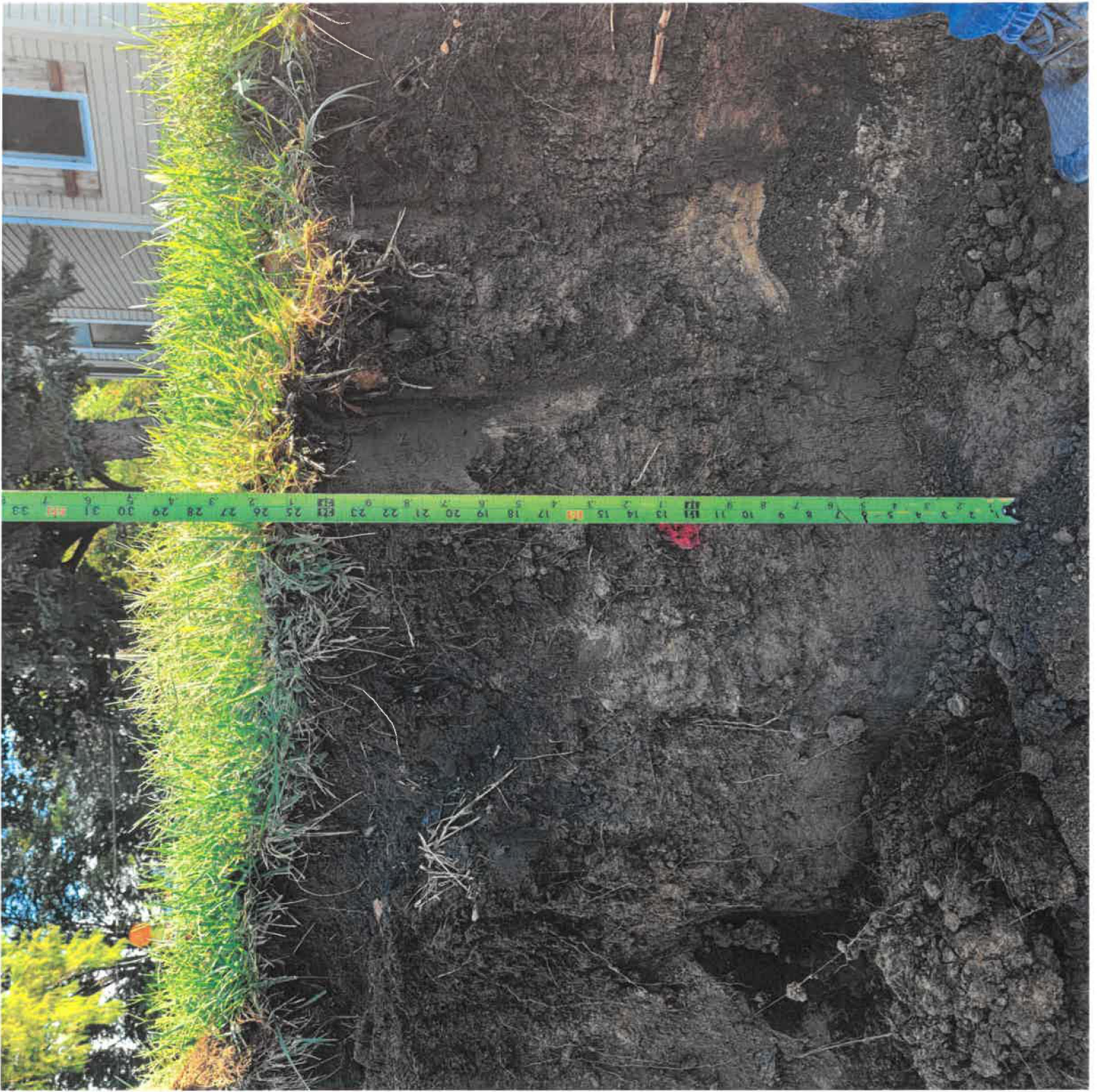

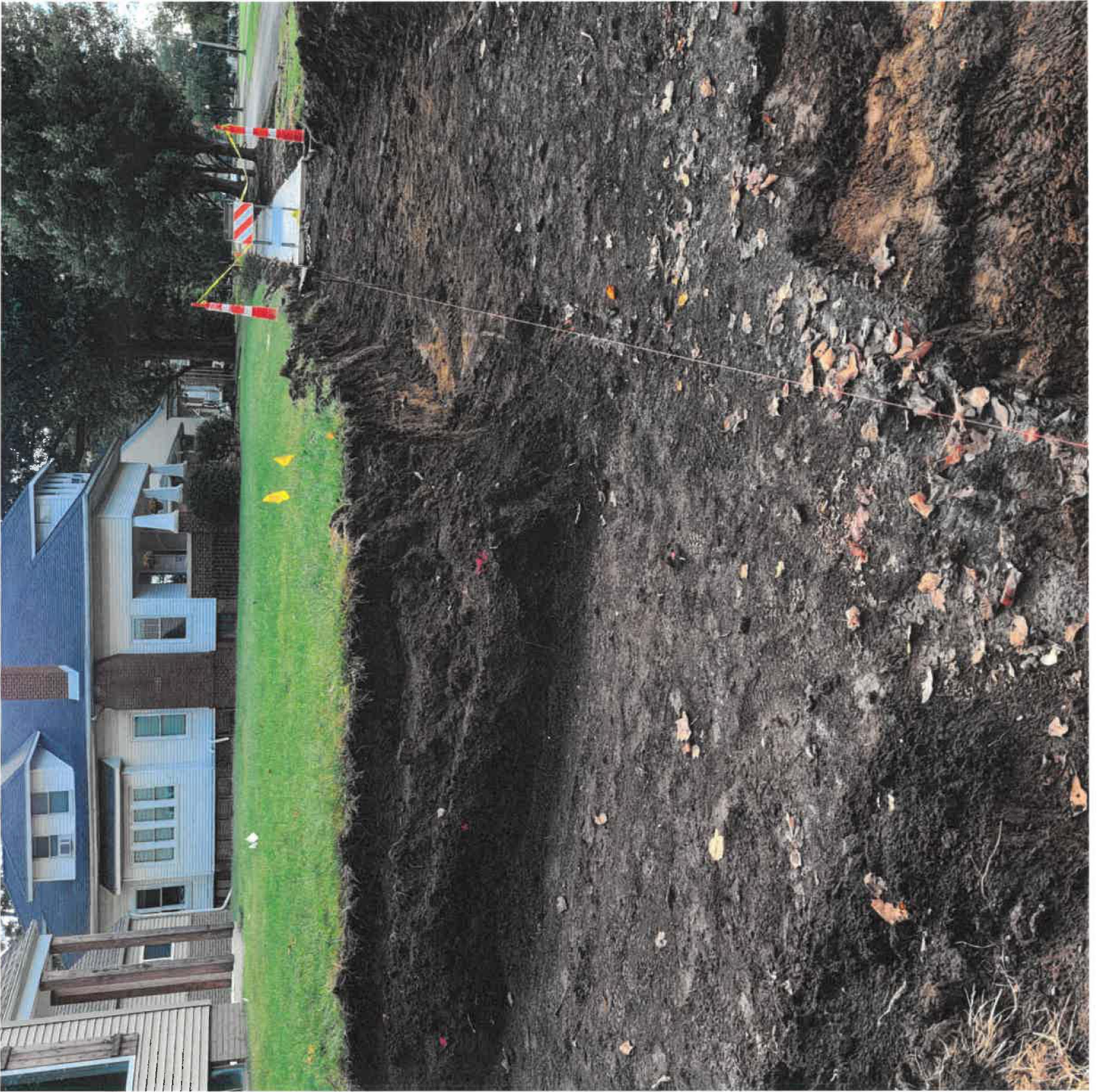

TRACY WELCH  
MAYOR

PEGGY S. BATEMAN  
CITY CLERK

CHARLES N. CONZO  
CITY TREASURER

JOHN A. HOBLIT  
CITY ATTORNEY



# CITY OF LINCOLN, ILLINOIS

700 Broadway St., P.O. Box 509, Lincoln, IL 62656

*Named for and Christened by Abraham Lincoln, 1853—Incorporated February 16, 1865*  
CITY COUNCIL MEETS FIRST AND THIRD MONDAY NIGHTS EACH MONTH

To: Mayor and Aldermen of the City of Lincoln

From: Andrew Bowns, Wastewater Project Manager

Meeting Date: April 13, 2021

RE: 15" Chicago St. Lining - Materials Increase - Liner Thickness

---

### Background

The attached quote is updated to reflect the pricing increase for the change from a 6mm liner to a 9mm liner. It is a materials cost increase totaling \$23,185.09 in addition to the previously approved \$170,000.00.

### Analysis/Discussion:

The liner that was originally planned for, was a 6mm liner. After cleaning, televising, and removing the abandoned manhole, several areas of the pipe were identified as not being suitable for a 6mm liner. This is due to spots in the clay tile that are protruding into the sewer, and the potential for failures within the liner due to these protruding spots. The manufacturer is unwilling to warranty the installation of a 6mm liner if we move forward with the original installation. This would put all liability on the City for repairs, if they were to occur. By moving to the 9mm liner the manufacturer is comfortable honoring the warranty, and believes the protruding tile will not cause issue.

### Fiscal Impact:

An additional cost of \$23,185.09 to be expensed from the "50-7400-7850 Capital Expense - Sewer Const" line item.

### Council Recommendation:

Approve the additional materials cost change from a 6mm liner to a 9mm liner in an additional amount not to exceed \$23,185.09.

#### CITY COUNCIL

FIRST WARD  
STEVE PARROTT  
GREG MILLER

SECOND WARD  
RON FLESHMAN  
SAM DOWNS

THIRD WARD  
KEVIN BATEMAN  
WANDA ROHLFS

FOURTH WARD  
RICK HOEFLE  
KATHY HORN

**Proposal for:**  
**Chicago Street From Davenport To Treamont Lining**  
 from



Bid Date: 1/19/2021  
 Time: 2:00PM

**Petersburg Plumbing & Excavating, LLC**  
 3550 Great Northern Ave., P.O. Box 13137, Springfield, IL 62791  
 (217) 321-0036 Fax: (217) 544-0829 brian@henson-robinson.com  
 License: 055-010334 Type: Plumbing

Quote Number: 1888

City Of Lincoln

Item	Description	Quantity	Unit	Unit Price	Total Price
01	Mobilization	1.00	LS	7,500.00	7,500.00
02	Pre-Clean And Televis 15" Sewer	1,615.00	LF	9.00	14,535.00
03	Cut Protruding Taps (Estimate Only)	6.00	EA	425.00	2,550.00
04	15" Liner Davenport To Burlington	384.00	LF	70.00	26,880.00
05	15" Liner From Burlington To Mid Block Chicago	336.00	LF	70.00	23,520.00
06	15" Liner From MH Off Keokuk To Mid Block Chicago	329.00	LF	70.00	23,030.00
07	15" Liner From Mid Block Chicago Past Lincoln	163.00	LF	70.00	11,410.00
08	15" Liner Past Lincoln To Other Side Of Peoria	264.00	LF	70.00	18,480.00
10	Re-Instate Taps (Estimated Only)	34.00	EA	395.00	13,430.00
12	Sewer Repair Keokuk Replace 69'	1.00	LS	51,850.09	51,850.09
				Total:	193,185.09

√ = Locked Bid-Item

████████████████████

Attachment Enclosed

10/06/2021 1:43 pm

Estimator: Brian Vogt



Generated by a SharpeSoft Product

**Petersburg Plumbing & Excavating, LLC**  
**Job Conditions - Attachment 'A'**

**Chicago Street From Davenport To Treamont Lining**

Supply Labor, Equipment and Material to Clean, Pre-Camera, Line 15" Clay Tile Sewer from Davenport to Treamont down Chicago, Pipe Burst existing 15" Clay from Manhole #3 off Keokuk roughly 110' pulling back fused HDPE and hooking back up to good clay, Backfill with CLSM and Patch Road with Concrete, IDOT Permit, Traffic Control, End Seals, 15" 9MM Liner.

**Note: From Manhole #6-7 we have found two Fiber Optic lines bored through center of Pipe. We could not get past. These lines need to be excavated and removed before lining. THIS will be done on a Time and Materials Basis and the City will send our invoice for this work to the Fiber Company.**

**Not Included: All Payemnt & Performance Bonds, Tap Fee's, Final CCTV, Final Cleaning (If needed), By-pass Pumping, Additional Spot Repairs (PPE will do spot repairs on a Time & Material Basis as needed), Final Grading/Seeding, Testlng, Root Treatment, Manhole Lining.**

Accepted by \_\_\_\_\_

**WE AT PETERSBURG PLUMBING & EXCAVATING THANK YOU FOR YOUR PATRONAGE! YOUR BUSINESS IS ALWAYS APPRECIATED!!**

Service charge of 1.5% per month (18% year) on all past due accounts.  
Collection and/or attorney fees will be assessed to all accounts placed for collection.

Prices Valid for 30 Days From Proposal Date.

10/06/2021 1:43PM

Estimator: Brian Vogt

For Job: Chicago Street From Davenport To Treamont Lining



Generated by a SharpeSoft Product

Mayor Tracy Welch  
City of Lincoln  
700 Broadway St.  
Lincoln, IL 62656

October 7, 2021

RE: Contract Extension Proposal – 5 years

Dear Mayor Welch,

Area Disposal, a subsidiary of GFL Environmental, Inc., is pleased to present this proposal for a municipal solid waste contract extension with the City of Lincoln. The current agreement, dated November 20, 2017, allows the contractor to request an extension or renewal of the current agreement on the same or different terms. We are proposing to extend the contract for five more years with new terms.

In exchange for an extension, AREA® will freeze the current rate customers are paying for another year. In other words, **there will be no price increase for residential customers in 2022**. The current rates being charged; \$16.33 a month and \$14.55/month for seniors will last through February 29, 2023. The fee will increase 2.5% thereafter annually and follow this table:

<u>Date</u>	<u>Standard</u>	<u>Senior/Disabled</u>
3/1/2022	\$16.33/month	\$14.55/month
3/1/2023	\$16.74/month	\$14.91/month
3/1/2024	\$17.16/month	\$15.29/month
3/1/2025	\$18.13/month	\$15.67/month
3/1/2026	\$18.58/month	\$16.06/month

As part of the extension, AREA® will also include multi-family residential properties with five-to-eight units in the agreement. The property owner will be able to use a commercial trash dumpster for multi-family properties with 5-8 units and receive one-time per week trash service (no recycling services) following this table and flat fee:

<u>Size</u>	<u>Multi-Family Rate</u>
2-yard	\$75.00/month
4-yard	\$100.00/month
6-yard	\$125.00/month
8-yard	\$150.00/month

Multi-family residential dumpster pricing will be subject to 2.5% annual increases. Under this proposal, all other terms of the current contract remain in effect. Let me know if you have any questions regarding this proposal.

Sincerely,

**Eric  
Shangraw**

Digitally signed by Eric Shangraw  
DN: cn=Eric Shangraw, o=Area  
Disposal, ou,  
email=eshangraw@pdcare.com,  
c=US  
Date: 2021.10.07 18:34:50 -0500'

Eric Shangraw

GFL Municipal Marketing Manager